



HIGH TECH GRINDING

XINGYI

Operation Manual

XINGYI XINGYI MACHINE USA LLC.

WEBSITE: www.xingyimachineusa.com

VOICE: 425-321-6773

EMAIL: ronnie@xingyimachineusa.com

**800-LE
GRINDER POLISHER**

Contents

1. Introduction

1.1 Summary	01
1.2 Responsibility	01
1.3 Accessories	01
1.4 Package acceptance	01
1.5 Machine name plate	01
1.6 Handling and storage	01
1.7 Warranty items	02

2. Safety guidance

2.1 Overview	02
2.2 Operation safety guidance	03
2.3 Electrical safety guidance	03

3. Machine Description

3.1 Overview	04
3.2 Machine parts	05
3.3 Swing lever accessories	06
3.3.1 Overview	06
3.3.2 Forward/ backward device	06
3.3.3 Handle	07
3.3.4 The angle adjustment of swing lever	07
3.3.5 Handle	08
3.3.6 The angle adjustment of swing lever.	08
3.4 Water tank	08
3.5 Suction connector	08
3.6 Additional weight iron	08
3.7 Clutch device	08
3.8 Main electric cabinet	09

4. Machine operating

4.1 Overview	09
4.2 Machine position description.	09
4.2.1 Machine working position	09
4.2.2 Machine carriage position	10
4.2.3 Machine package position	10
4.2.4 Machine upright position	10

4.2.5 Lift the machine	10
4.2.6 Precautions	11
4.3 Transportation	11
4.3.1 Manual transportation	11
4.3.2 Automatic transportation	11
4.3.3 Transportation and storage	12
4.4 Start and stop the grinder	13
4.5 Replace abrasives	14
4.6 The wire winding	14
4.7 Optimal grinding route	14

5. Equipment Maintenance

5.1 Overview	14
5.2 Daily check	14
5.2.1 Check the switches	14
5.2.2 Check the disc cover	15
5.2.3 Check the grinding plate	15
5.2.4 Long-term storage of batteries	15
5.3 Cleaning	15
5.3.1 Clean switches	15
5.3.2 Clean the grinding plate cover	16
5.3.3 Clean the grinding plate and Velcro-iron accessories	16
5.3.4 Note	16
5.4 Overloading	16
5.5 Maintenance	16

6. Frequently Asked Questions and Solutions

7. Technical parameter

8. Warranty

17

18

19



1. Introduction

1.1 Summary

Xingyi machines are used for processing concrete floor surfaces. The application of the machine depends on the choice of tools. This manual covers basic operation instructions and general functions, this manual also explains the applications, repair, and maintenance of the machines. Please contact factory or your local retailer for more information.

1.2 Responsibility

We make every effort to make this manual as complete and accurate as possible, and we are not responsible for any errors or loss of information. Xingyi reserves the right to change the instructions in this manual without prior notice.

This manual is protected by copyright law and can not be reproduced or used in any part without the express written consent of Xingyi.

1.3 Accessories

Below accessories are included with the grinder. Contact your supplier if anything is missing.

- (1) 1set of grinding machine
- (2) 1copy of machine using manual
- (3) 1set of Velcro-iron accessories
- (4) 1pcs of socket (apply with machine's plug)
- (5) 1pcs of anti-dust tape
- (6) 2pcs of main electric cabinet key
- (7) 1 set kit bag (with a whole set of tools inside)

1.4 Package acceptance

Check carefully to see if the package or the grinder has been damaged during delivery. If there is any sign of damage, contact your supplier and report it. Check that the delivery matches the order. If there are any discrepancies, contact your supplier.

1.5 Machine name plate

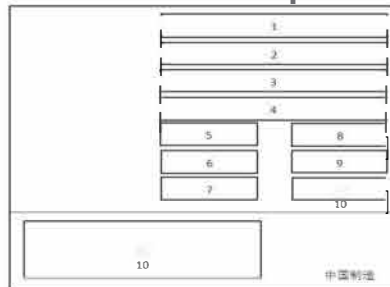

- | | |
|-----------------------|---------------------|
| 1、 Model | 6、 Voltage |
| 2、 Model number | 7、 Electric current |
| 3、 Manufacturer | 8、 Frequency |
| 4、 Manufacturing date | 9、 Weight |
| 5、 Power | 10、 Address |

1.6 Handling and storage

The grinding machine should be stored in a dry place at room temperature when not in use. Otherwise it may be condensed and cold damaged. The size and weight of the grinder are given in the technical data of the Manual.

Note! Improper operation may lead to the grinding machine overturned and damaged, even endanger personal safety.

1.7 Warranty items

This warranty covers only manufacturing defects. Xingyi does not assume damage in the transport, unpacking or operation. The manufacturer is not responsible for any damage or defects caused by improper use, corrosion or use of specifications beyond the noted specifications. The manufacturer shall not be responsible for any indirect damage or expense under any circumstances. For complete information on the manufacturer's warranty period, please refer to the current warranty terms of Xingyi. Local retailer may have special warranty terms. If you have any uncertainty about the warranty terms, please contact with your retailer.

2. Safety guidance

2.1 Overview

This manual records the key information for safe operation. Be sure to read the manual carefully before the first operation. Non-standard operation, unauthorized modification, or maintenance may cause machine problems or other losses. Tampering with the electronics may be dangerous. All maintenance must be done by qualified professional technician. Any machine parts that need to be replaced must be provided by XINGYI.

Xingyi machines only can be used in the way recommended by Xingyi and only for commercial purposes. Anyone who uses the machine should know its functions and operation, the location of the emergency stop, and safety rules the operator should follow.

The operator should be equipped with professional personal safety equipment when working, this should include, safety glasses, protective gloves, safety shoes, and hearing protection. Do not wear loose clothing that can get caught in the machines moving parts.

Note:

1. It is strictly prohibited to operate under the condition that the electricity is less than 20%, especially on slopes, to avoid personal injury.
2. When working or transporting on a ramp or uneven area, be sure that the battery power is more than 40% and the clutch pin is locked.
3. When this machine needs to operate in a place with slopes, it should be less than 25 degrees. The company is not responsible for any accident caused by the operation when the slope is greater than 25 degrees.
4. This machine is only used for floor grinding, polishing only;
5. Read and understand the safety guide totally. Different models have different accessories and operation instructions.
6. Operation of this machine only needs one person. Keep children and irrelevant person away. Keep in mind that "one machine one person."
7. Operator who is in poor physical state or without training is not allowed to operate the machine. The operator and the repairman must be physically strong and able to withstand the weight of the whole machine and the working intensity of the motor.
8. Do not lend or rent the machine without instruction manual.
9. Wear helmet, safety shoes, the headset, non-moist goggles and masks when operating the machine.
10. Keep body, jewelry or any loose clothing away from machine moving parts. Otherwise, it may endanger personal safety.

11. Random modifications of the machine are not allowed. Only XINGYI accessories can be used for maintenance and modification.
12. Do not operate the machine in rainy or foggy days.
13. Ensure no explosive flammable materials and steam nearby when operate machine. Do not operate machine nearby the place with fuel, grain dust, solvents, dilution agent or other flammable items.

2.2 Operation safety guidance

1. Operators should wear protective equipment when using the machine, such as dust masks, protective gloves, overalls, helmets, insulated shoes and eye protection.
2. Make sure there is no oil leakage, electrical shorts, or water leakage on the machine before using. The machine can be used normally.
3. Check the machine control switches and electric parts are in good conditions without moisture.
4. Make sure no obstacles or persons in the working area. Be sure there is proper lighting.
5. The anti-dust shroud should be installed on the machine for safety. It is necessary to connect to industrial vacuum cleaner when dry grinding.
6. The machine should be connected to appropriate electrical outlet. Only use the power cables that are rated to withstand the required current.
7. Do not adjust the handle during machine operation. Only when the machine is stopped and the emergency stop switch has been pressed, the worker can adjust the machine handle.
8. The handle has different functions when it is in different positions. Please read the manual for more information.
9. Ensure the machine has stopped operating and the emergency stop button is pressed when changing abrasives or accessories. If necessary, disconnect the power and the plug.
10. Keep the machine away from drains and furnace mouths or other dangerous goods, otherwise it may cause personal injury or loss of machinery and property.
11. Tight-hold hand grip, rotate the emergency switch clockwise, then press the power button and start the machine.
12. Please note that the emergency stop switch can only be pressed or rotated. Prohibit upward pull.
13. Before operation, check the working surface and remove any protrusion to prevent machine plates and pads from damage.
14. Double check before connecting to power, make sure the working Voltage, HZ is same with input Voltage and HZ, no lack of phase of input power. (If the machine do not work normally, and it results in the input power and working power is not the same, then manufacturers warranty is unavailable.)
15. Connecting with vacuum to achieve dust free working condition.
16. Install appropriate abrasive. Improper abrasive may cause personal injury and floor damage.
17. After installing the abrasive, keep the grinding plate touch with ground directly, adjust handle bar to the "lifting position", so that the operator could operate the machine easily.
18. When machine inverter turns to overload protection, it means there is something wrong with the machine (cable is too small or voltage is unstable), if so please reference the following cable sizes which are recommend. Or reduce the abrasive pressure (adjust the additional to suitable position) if users keep using the machine when overload leads to damage, it would be not allowed to guarantee.
19. After few minutes of grinding, stop to check how much the abrasive uses. This behavior could reduce the economic loss when using wrong polishing pads.
20. Please do not upward the machine when machine is still running, otherwise the polishing pads may fly out to threat the human safety.

2.3 Electrical safety guidance

1. All circuit repairs can only be carried out by qualified personnel;

2. Note: After the machine is stopped, the line is still energized. Disconnect all power before servicing the machine.
3. The machine is equipped with an overload protection device and will automatically engage when the machine is overloaded, prohibiting any damage to the motor or electrical circuits.
4. Continue to use the machine in the overloaded situation may cause some other losses even machine can't work normally, then manufacturers warranty is unavailable.
5. The purpose of installing the inverter on the machine is to protect the user and the machine. It is forbidden to modify or adjust the inverter or modify the inverter parameters without the manufacturer's consent. If the unit fails, it is only allowed to replace the defective parts with the accessories provided by the manufacturer; (any damage caused by changing, adjusting or modifying the inverter parameters without the manufacturer's consent, will void the warranty).
6. Never modify the parts or lines inside the inverter by yourself.
7. Do not operate the machine when the distribution box is turned on.
8. If the machine current is overloaded, please pay special attention;
9. When the cables is energized or loaded, do not connect or disconnect the wires;
10. Using a damaged power cord may result in electric shock. Do not use a damaged power cord;
11. Cables should be kept away from hot surfaces;
12. The dryness of all electrical equipment should be maintained and the machine should be kept in a dry place;
13. After the power is turned off, before the panel indicator is off, it indicates that there is still high voltage inside the inverter, which is very dangerous. Do not touch the uninsulated electrical equipment;
14. The machine motor and the frequency conversion box are prohibited from entering water; (the other damage caused by the water inflow then the machine is not working properly, the manufacturer does not cover the warranty);
15. The machine must be connected to the qualified wire and voltage, specifications is noted by the manufacturer. (The machine label indicates the power supply specifications).

3. Machine Description

3.1 Overview

800LE is used to grind (rough grind, fine grind and polish) concrete, natural stone and terrazzo floors or other materials specified in this manual or recommended by XINGYI.

The 800LE is a self propelled grinder. The forward/reverse switch can be used to control the forward and backward movement of the driven wheel, so that the user can get rid of the action of manually pulling or pushing the machine to forward/reverse, which greatly saves manpower and facilitates user operation. The innovation of this equipment is that it equipped with a water tank and add additional weight iron. The heat dissipation openings on both sides of the water tank make the heat dissipation of the frequency conversion box faster and extend the service life of the internal electrical appliances. The design of the water tank allows the equipment to be applied not only in dry grinding but also wet grinding. The benefits of wet grinding are as follows: good flatness, small cutting amount, easy polishing, suitable for later stone polishing. Increasing additional weight makes the lifting easier, and the grinding pressure can be increased during grinding to make the surface smoother.

The swing lever and handle can be set in many different tilted positions. When the machine is manually operated, you can choose the most suitable position. The grinding head of the machine can be used with different grinding plate for operation. The dust belt covers the working area of grinding head. Because of floating design, it always touch the floor, which not only ensures that the operator does not touch the

rotating mechanical parts, but also reduces the exposure of dust and improves the dust absorption efficiency of the vacuum cleaner.

When dry grinding, to prevent dust from being exposed to air, posing a threat to the health of the operator and nearby people, make sure that the vacuum cleaner is connected to grinder (preferably equipped with a vacuum cleaner manufactured by Xingyi) Due to inhalation of dust is harmful in the course of operation, even there is a vacuum cleaner protective mask is also necessary to protect health.

The machine can use different Xingyi abrasive. Due to the different ground materials, the abrasive discs used in grinding are also different.

3.2 Machine parts

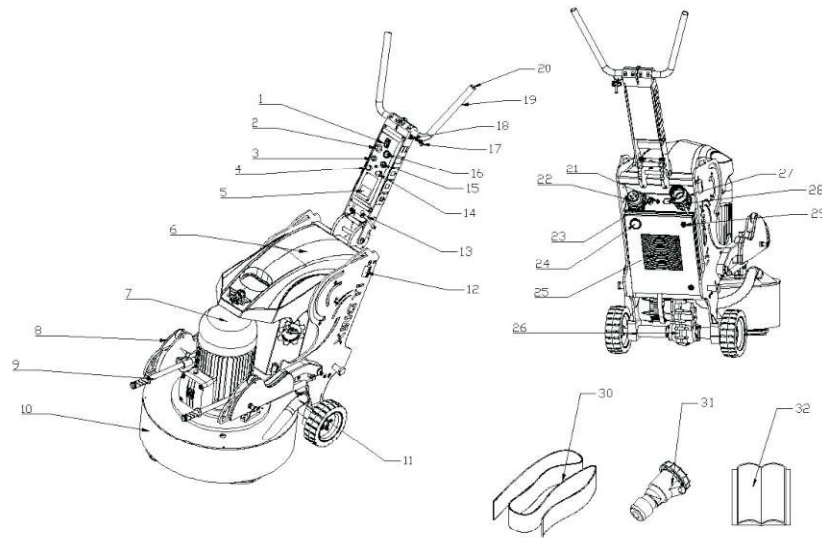

1. Forward and backward switch
2. Driving wheel speeder
3. Motor speeder (grinding disc)
4. LED light switch
5. Display screen
6. Water tank
7. Motor
8. Additional weight iron
9. Additional weight iron pole
10. Floating anti-dust tape
11. Suction hose
12. Additional weight iron limiting device
13. Connecting lock rod
14. Running indicator
15. Forward and reverse switch
16. Emergency stop switch

17. Main electric cabinet key
18. Handle adjustment bolt
19. Elbow handle
20. Handle rubber sleeve
21. LED lamp interface
22. Power outlet
23. Wire pipe connector
24. Timer
25. Heat sink
26. Driving wheel motor
27. Battery charging port
28. Suction connector
29. Electric cabinet lock
30. Anti-dust tape
31. Power plug
32. Manual

3.3 Swing lever assembly

3.3.1 Overview

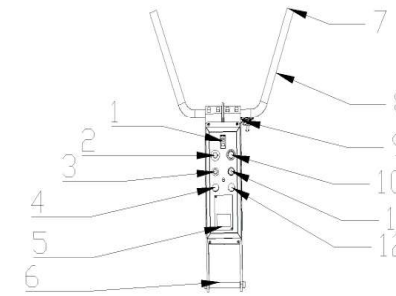

1. Forward/reverse switch: Controls the forward and backward movement of the machine.
2. Driving wheel speeder: adjust the walking speed of driving wheel.
3. Speeder: adjust the rotation speed of motor.
4. LED light switch: control the LED light.
5. Display screen: display some parameters, such as voltage, current, motor speed and fault code.
6. Swing lever locking rod: lock the rotation of swing lever.
7. Operation handle: Where people put their hands when operating the machine.
8. Sponge cover (handle): make the operation more comfortable.
9. Operation handle angle adjustment bolt: pull out the bolt and the handle can be rotated freely to the proper position to operate the device.
10. Emergency stop switch: When the device is in a dangerous state or needs to stop working, press the emergency stop switch to cut off the power and stop the operation of the device to achieve the protection of personal and equipment safety.
11. Forward/reverse switch: The switch has three gears. Turn on the emergency stop switch. Turn it to the left to rotate the motor forward, turn to the middle gear to prevent the motor from rotating, and turn to the right to reverse the motor.
12. Running indicator: When the device is working normally, the running indicator lights up.

3.3.2 Forward/ backward device

The forward / backward device is mainly used to control the forward or backward movement of the machine. Users can make the machine move forward/backward without pulling or pushing. Such this device greatly reduce the manpower, making the more convenient operation.

The forward / backward device has three main gears, one is forward: press forward, then the machine forward move; the second is the middle gear, press to the middle gear, the machine remains stationary (if the machine is currently forward, you should press back it to the middle gear; The third one is the reverse gear, press it back, then the machine to recede accordingly.

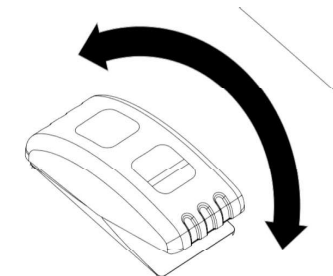

Note:

In the exchange of different gear, it should be noted that overexertion will lead to trip over stop. During grinding, do be sure to connect a vacuum cleaner. It is suggested to use the vacuum cleaner

produced by XINGYI to ensure the vacuuming efficiency. Bad vacuum cleaner is likely to clog the dust in forward / revers switch, resulting in a switch failure.

3.3.3 Handle

The handle adjusting bolt can be positioned at different round hole, so as to adjust the position of handle to meet different needs of users. Hold the handle with one hand, pull out the adjusting bolt with the other hand, then release the adjusting bolt when it is rotated to proper position.

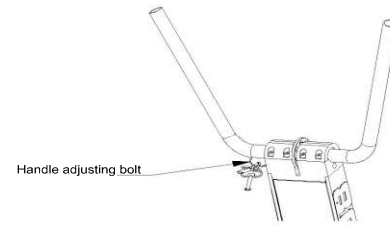

Note:

1. When plugging out the pin, sometimes it will be caught, and the pin can be pulled out by shaking the support wheel.
2. When the handle adjustment bolt is automatically reset, the hole may not be aligned, just rotate up and down
3. When adjusting the position of the handle, please check whether the handle adjustment pin has been automatically reset before operating the machine.

3.3.4 The angle adjustment of swing lever

Use the swing lever position adjusting handle to adjust the position of swing lever to realize conversion of the machine placement mode in different states. Hold the handle tightly with one hand to support the swing lever, turn the other hand counterclockwise and press down the adjustment handle, rotate according to the hole location on sector plate, and release the adjusting handle when it reaches required position.

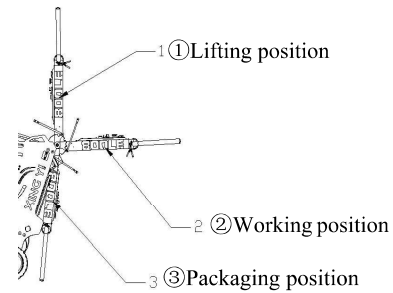
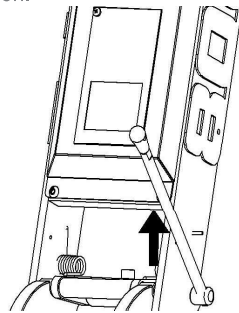

Note:

After adjusting the position of the swing rod, it is necessary to check whether the swing rod has been limited before operating the machine.

3.4 Water tank

There is a water inlet on the side of the water tank (open the water injection hole as shown below). The heat dissipation openings on both sides of the water tank make the heat dissipation of the inverter box of the equipment faster, and can extend the service life of the electrical appliances inside the inverter box. Turn the water switch clockwise to start water grinding.

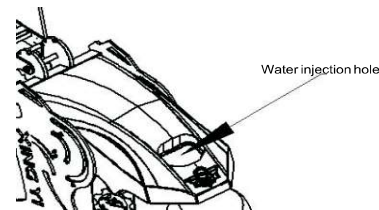

3.5 Suction connector

Grinding machine needs to be connected to a vacuum cleaner in drying grinding. As shown in figure, connect suction hose to the connector. (These steps are all shown in figure below)

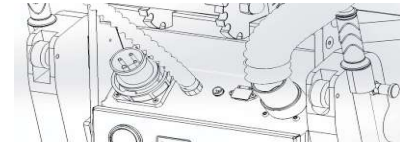

3.6 Additional weight iron

There are three positions for the additional weight iron: transporting, tilting, and working position. The adjustment and limit of the extra weight is mainly achieved by spring pin and limiting device on frame.

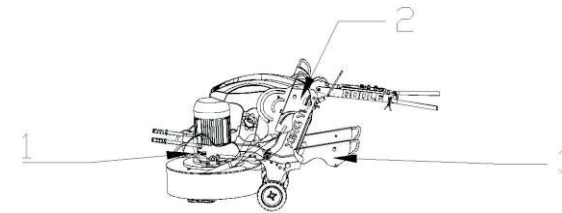

①Transporting position ②Tilting position ③Working position

Note:

Please hold the additional weight iron when you switch it. When the additional weight iron is switched from the transporting position to the other position, pull out the handle on the additional weight iron positioning pin. Then the position can be switched.

3.7 Clutch device

The clutch device (the device composed of the clutch rubber sleeve and clutch pin is collectively referred to as clutch device) has two main states:
Unlocking state: When the machine is not working, loosen the clutch device, then pull out the clutch pin, rotate the clutch pin sleeve, and stuck the clutch pin in the limit device of the clutch pin sleeve to tighten the clutch device.

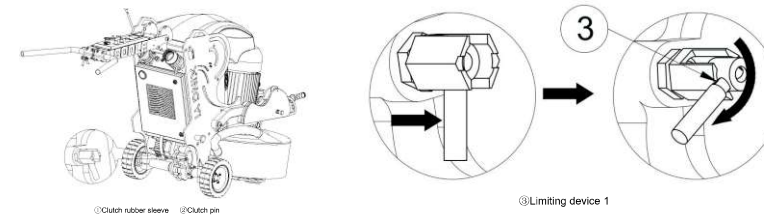

Locking state: When the machine starts working, loosen the clutch device, then pull out the clutch pin, rotate the clutch pin sleeve, and clamp the clutch pin on the limiting device 2 to tighten the clutch device.

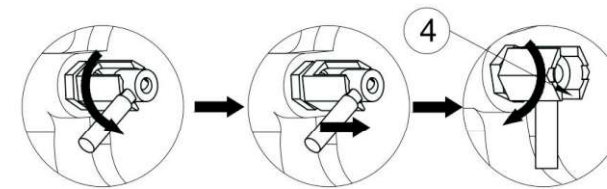

④Limiting device 2

1. The clutch may be stuck sometimes when you try to pull out, shake the machine in this case.
2. Rotate the clutch to proper position when grinding. Be sure to limit the clutch pin before working.
3. When pulling or rotating the clutch device, be sure to put the additional weight in working position first to prevent the iron from injuring or hitting people, causing unnecessary casualties.
4. When unplugging or screwing the clutch pin, do not screw the clutch device too loose or too tight, or the clutch pin cannot be pulled out and stuck in the limit device smoothly.

3.8 Main electric cabinet

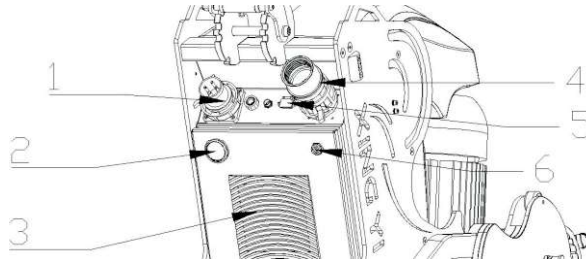

1. Power socket: connected to an external power, supply power to the machine
2. Timer: shows the total running time of the device.
3. Heating sink: play a role in heat dissipation, to avoid excessive temperature inside the electric cabinet burning out electrical components.
4. Vacuum hose connector: connection to the vacuum cleaner.
5. Charging hole: for the device's own internal battery to charge. Charge the internal battery of the machine.
6. Main electric cabinet key lock: used to lock the electric cabinet.

4. Machine operating

4.1 Overview

The following part mainly describes the grinder in different positions when the mode is switched to manual operation, the main operation of the grinder and how to install the grinding abrasive.

Note:

1. Grinders can only be used or repaired by personnel who have received the necessary theoretical and practical training and have carefully read the user manual.
2. Wear protective equipment such as protective gloves, protective masks, overalls, helmets, insulated shoes, etc. when operating the grinder.

4.2 Machine position description

4.2.1 Machine working position

During grinding, pull out the spring pin on the additional weight, reach the gasoline motor, gently lower the additional weight to the proper position, adjust the handle and swing lever position to achieve the most proper working position. Flip up or remove the support wheel.

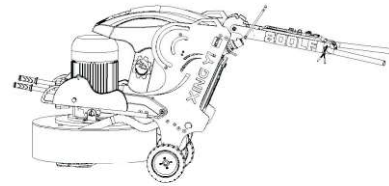

4.2.2 Machine carriage position

During transportation, adjust the additional weight iron, swing lever and handle to the transport position. Then, pull the clutch pin out. Lower and rotate the support wheels to lock, adjust the height of the support wheel so that the disc is off the ground for easy transportation.

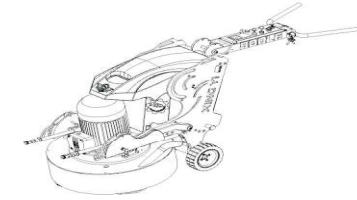

Note:

Do not rotate the support wheel to an excessive position to prevent it from falling off, which may cause dangerous accidents; When rotating the support wheel, always pay attention to the height of the grinding disc from the ground. Be careful not to make the grinding disc too low. When it is too low, the grinding disc will cause collision with the ground and damage the grinding disc; Rotate and lower the support wheel to raise the grinding machine from the working area. It is recommended that the lowest position of the grinding disc is 25mm from the ground.

4.2.3 Machine package position

Adjust the position of the swing lever, foot pedal and handle to the packaging position. The minimum package size is as follows and the machine can be packaged according to the specific size.

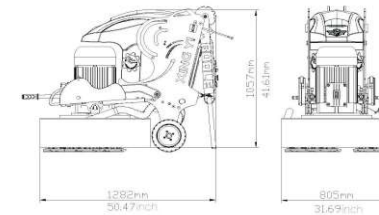

4.2.4 Machine upright position

Adjusting the bolt of the extra weight so that the extra weight is in tilted position, and adjust the handle, pedal and swing lever position to the lifting position. (Recommended best lift up position) Hold the handle with both hands and place one foot on the additional weight to force the machine down.

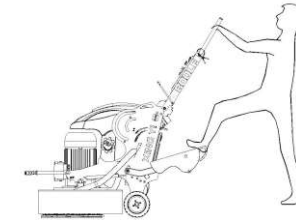

To put the machine down, you need to hold the handles tightly with both hands. Place feet on the handle of the additional weight iron lifter, balance the machine with your own gravity, and slowly lower it to protect the grinding head. When you put down the machine, pay attention to your own strength, and do your best to ensure the safety of the machine and the person. XINGYI company does not assume any responsibility for machine damage and personal injury caused by improper operation.

Note:

After lifting up the machine, remember to stand next to the grinding head, slightly press the grinding head to see if the machine is stable for personal safety.

4.2.5 Lift the machine

Tie the lifting strap tightly to both the two lugs, one is next to the motor and the other one next to the anti-dust tape. (Note: you need to use two ropes that can withstand 500 kg to bind the machine.

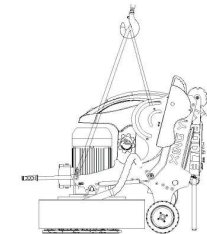

Note:

1. When lifting the machine, it may cause personal injury or damage to the machine and surrounding objects. Make sure that no one is present in the danger zone during the lift.
2. After the rope is fixed to the lifting hole, you should also check whether it is firmly fixed.
3. The two ropes need to be diagonally connected to the lifting mouth.

4.2.6 Precautions

1. Improper operation may lead to the grinding machine overturned and damaged, even endanger personal safety.
2. When the handle adjustment pin is pulled out, it may get stuck. Just shake the handle and pull out the pin.
3. During adjustment, it is necessary to confirm the reset of the locking device before operating the machine.
4. Be careful when the grinder is adjusted to the position of transportation or packaging and there is a risk of crushing injury.
5. Dust inhalation is harmful. Please bring a professional mask during operation to ensure physical safety.
6. In the process of lifting and downing the machine, we must pay special attention to our own safety and avoid damage to the machine.

4.3 Transportation

There are two types of transportation methods for this machine, manual and automatic. It depends on the storage battery of the machine itself during transportation.

4.3.1 Manual transportation

1. Adjusting the handle and swing lever to working position, additional weight to transport position. (The specific adjustment actions of each component are described above. The adjusted machine is shown below).
2. Rotating the support wheel handle can lower the support wheel and raise the grinding device from the working area. It is recommended that the lowest position of the grinding disc is 25mm from the ground;
3. Unlocking the clutch device: Unscrew the clutch device, then pull out the clutch pin and rotate the clutch pin sleeve, and embed the clutch pin in the inhibiting device of the clutch pin sleeve to tighten the clutch device.
4. Use the handle to push machine.

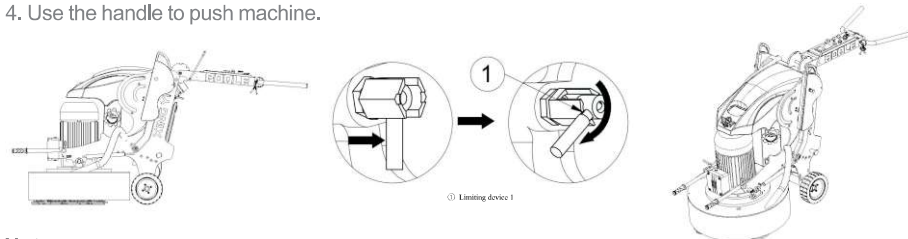

Note:

1. When the clutch pin is pulled out, it may get stuck. Just shake the machine and pull out the clutch pin.
2. Pay attention to your own safety when lifting the machine, be sure to do no more than you can.
3. Take out the grinding pads to prevent it drops and lost before transport, resulting in unnecessary losses.
4. When using manual push mode, the clutch must be unlocked.
5. Using hand-push way when clutch device in the locked state, will result in the drive motor damage!
6. When rotating the support wheel, remember do not to rotate to the highest position, to prevent the support wheel off lead and the final hole is not aligned well.
7. Rotating the support wheel, it is necessary to always pay attention to the height of the grinding disc from the ground, which can not be too low to prevent the disc shaking lead to collision with the ground, damage the disc; it is recommended that the disc minimum position is 25mm from the ground.

4.3.2 Automatic transportation

Rotating the support wheel handle can lower the support wheel and raise the grinding device from the working area. It is recommended that the lowest position of the grinding disc be 25mm above the ground

1. Adjusting the handle and swing lever to working position, and additional weight to transport position.

(The specific adjustment actions of each component are described above. The adjusted machine is shown below.

2. Locking the clutch device: When the machine starts working, unscrew the clutch device, then pull out the clutch pin and rotate the clutch pin sleeve, and embed the clutch pin in the inhibiting device of the clutch pin sleeve to tighten the clutch device.
3. Turn on the emergency stop on the swing lever control panel;
4. Press the button of drive wheel on the electric control box, adjusting the drive wheel speed to more than 30.
5. Using the forward and backward switch to transport.

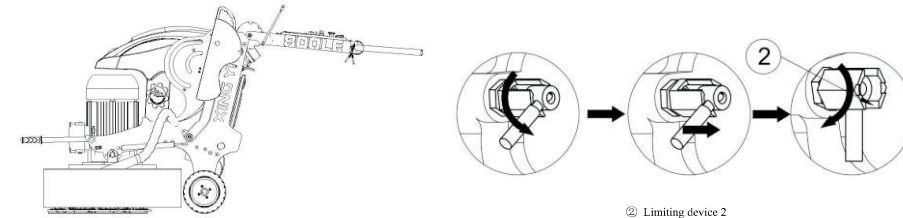

Note:

1. The emergency stop switch should be screwed or pressed, and cannot be pulled. The manufacturer does not compensate for any loss caused by improper operation.
2. Take out the grinding pads to prevent it drops and lost before transport, resulting in unnecessary losses.
3. During the operation, you must pay attention to the electric quantity of the reserve battery.
4. Be extremely careful when polishing or transport on slopes (up to 17° slope).
5. If it is a steep slope, must use a winch. Do not stand behind the machine.
6. Before walking on the slope, make sure the battery power is more than 40%, the clutch is in the locked state, and the AC input voltage is higher than 350v.
7. Moving down in slope, the machine should be driven slowly in the reverse direction.
8. Moving up in slope, the machine should be driven slowly in the forward direction.

4.3.3 Transportation and storage

1. It must be careful to move a machine in manual mode or on the slope. Even a small slope can create large forces. In this case, user can't hold the machine by hand.
2. The machine should not be lifted with the handles, motors, frames or other parts. It is best to transport the machine which is tightly held on the pallet/slide.
3. If there is no a crane or forklift never try to lift the machine.
4. If the machine is not parked on a pallet or bracket, do not use a forklift truck to lift below the planetary grinding head. Such behaviour may cause irreparable damage to the machine's discs and other internal components.
5. During transportation, please fix the machine firmly to avoid damage or accidents.
6. During transportation, the grinding device should touch the ground and a tool plate should be always installed to protect the locking mechanism.
7. Please store the machine in a lockable, keeping out of the reach of children.

4.4 Start and stop the grinder

1. Start the grinder

(1) Firstly adjust swing lever, handle and additional weight iron to the corresponding working position, place the supporting wheel device in the lowest position and invert it or disassemble it (as shown in the figure below).

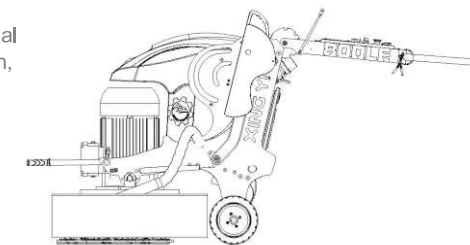

(2) Lock the clutch pin (unlock the clutch pin if in the manual mode), plug in the power cord (ensure that the emergency stop is pressed down and the switches are reset); if the machine using for dry grinding, connect the vacuum cleaner (Vacuum cleaner is equipped with a fast connector, so it can quickly connect to the vacuum cleaner); if the machine using for wet grinding, it's necessary to fill the water tank with water

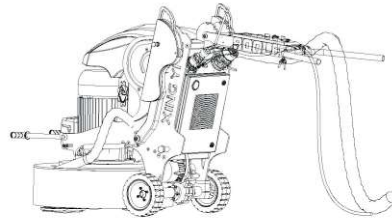

2. Stop machine: press the emergency stop switch and unplug the power to stop machine (remember to reset the speed regulator).

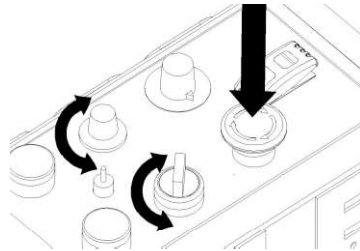

4.5 Replace abrasives

When changing the grinding disc, adjust machine to the lifting position, then tip the machine carefully and lay the machine flat. After leveling the machine, stand next to the machine and check whether the machine is stable. Change the polishing pads with a flat-blade screwdriver and replace it with a new one.

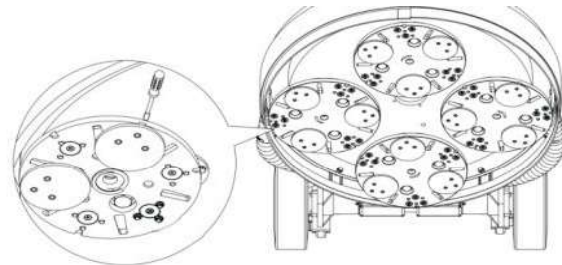

Note:

1. Please ensure that the machine won't tip forward before replacing the abrasive;
2. After the machine has been running for a period of time, the abrasive, grinding disc and the gear box will generate high temperature. Be careful to be burn when you replace the abrasive.
3. Replace the abrasive only when the power is unplugged and the emergency stop is pressed.

(3) Turn on the emergency stop switch, rotate the speed regulator to adjust the rotation speed of the motor, turn the switch to the left to rotate the motor forward (rotate to the right to reverse the motor) Press the forward and backward switch to control the machine move forward or backward. (turn on the water switch before water grinding)

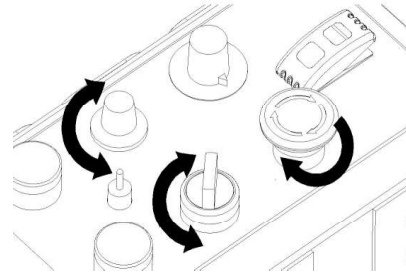

Note:

When stopping the machine, it is recommended to unplug the power supply for safety reasons. The emergency stop switch can only be rotated and pressed down according to the direction shows on its top, and cannot be pulled up.

4.6 The wire winding

During machine working process, the wire wind method is particularly important, you can greatly improve your work efficiency and improve your safety. The specific operation is as follows:

1. Plug in an external power supply;
2. Turn the power cord through the swing lever handle;
3. The power cord wrapped around the handle at least two laps;
4. Slightly hard to pull the power cord to ensure that the power cord has enough friction so that the power cord firmly fixed on the handle.

Note:

1. Make sure the power plug and socket are securely connected;
2. Please make sure the emergency stop has been pressed before plug the power supply, and the other switch has been reset;
3. Power supply line, please use (please find in Manual) wire minimum wire size;
4. Please use the correct power supply.

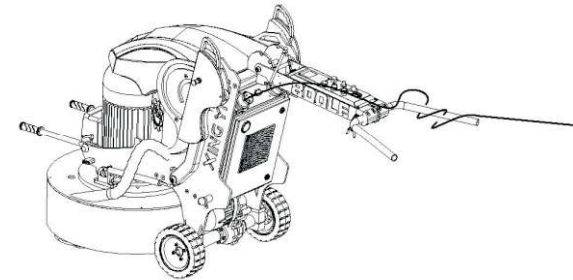

4.7 Optimal grinding route

When grinding the ground, it should be in accordance with the # method to grind the ground to get better effect. And according to # to grind ground, the machine grinding direction makes the wire more and more farther away, so that you can further avoid the interference of the wire to the normal work of the grinding machine.

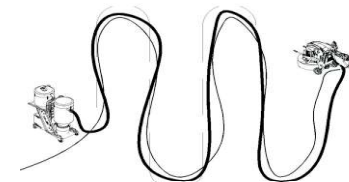

5. Equipment Maintenance

5.1 Overview

We recommend that the grinding machine be checked regularly to extend the service life.

Note:

During the maintenance and repair process, the power of the grinder must be disconnected. Wear protective equipment such as safety shoes, protective gloves, protective masks, etc.

5.2 Daily check

5.2.1 Check the switches

The emergency stop switch should be rotated along the rotation direction of the switch. Turn the motor

positive and negative knob to start the machine (Safely and normally start the machine, the running light will light up, if not normally start, then there will be the error code showed on the display screen)
Turn on the grinder and press the emergency stop switch to see if the machine stops.
Turn on the emergency stop switch and turn LED light switches to check if the corresponding light is on.

Note:

For safety reasons, it is strongly recommended to press the emergency stop switch when stopping the device, which would be safer.

When starting the machine, it is recommended to press the handle to lift the machine slightly, reduce the pressure of the grinding disc, and reduce the friction between the grinding abrasive and the ground, so as to avoid motor overloading when starting the machine.

5.2.2 Check the disc cover

When there is a large amount of dust, it is easy to cause dust nozzle of grinding disc cover clogged by dust, use flashlight to see if there is dust clogged, clean up if necessary.

5.2.3 Check the grinding plate

In the case of long hours of work or a large amount of dust, the grinding plate of grinding head may be stained with dust. It will lead lack of connection between grinding head and plate, which will affect grinding efficiency even lead to abrasive drop and cause accident. In view of this situation, please remember to clean up in time.

Note:

Be sure to wear protective equipment for maintenance checking such as protective gloves, protective masks, insulated shoes, etc.

The maintenance operation must be done when the emergency stop pressed and the power unplugged. When the machine is tilted, make sure that the machine is flat and then check the operation of the grinding disc.

5.2.4 Long-term storage of batteries

Stored for a long time, the machine battery should be maintained and charged once every 6 months

Note:

Be sure to wear protective equipment for maintenance checking such as protective gloves, protective masks, insulated shoes, etc.

The maintenance operation must be done when the emergency stop pressed and the power unplugged. When the machine is tilted, make sure that the machine is flat and then check the operation of the grinding disc.

5.3 Cleaning

5.3.1 Clean switches

Grinding machine works on site for a long time, and the switch will inevitably run into the dust. For this reason, please check switch after grinding, to see whether the part is clogged by dust. Otherwise, it may cause the switch failure.

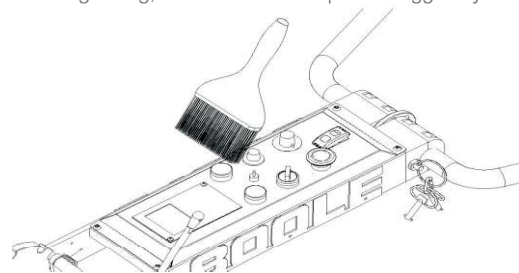

5.3.2 Clean the grinding plate cover

Remove the vacuum tube connection, illuminate the dust nozzle with a flashlight, clean the dust nozzle with brush. So that it will not clog the dust nozzle and affect dust collection efficiency.

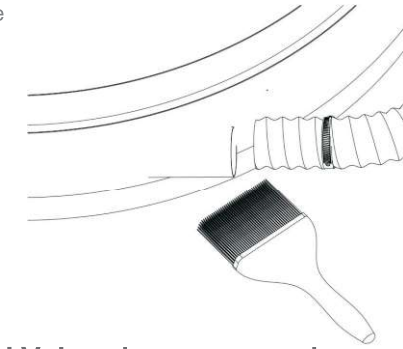

5.3.3 Clean the grinding plate and Velcro-iron accessories

Tilt the machine and use a cross screwdriver to remove the pads, and use shovel to remove dust. If you do not clean up in time, it is possible to make the pads disconnected, and pads fly out when grinding, causing damage to the machine and threaten personal safety.

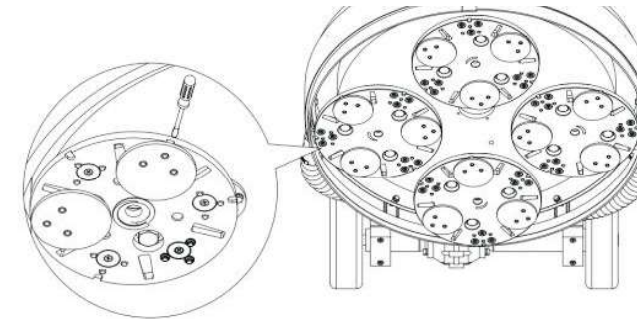

Note:

1. Be sure to disconnect the plug from the socket before cleaning, maintenance or assembly.
2. Be sure to clean the whole grinder after each day's working. Do not use a pressure washer to clean the machine directly.
3. In order to cool the equipment effectively, the cooling air port must be kept clear and clean.

5.4 Overloading

The machine is equipped with an overload protection function on the inverter. When the machine is overloaded, the overload error will be showed on the display of the control panel. In this case, just disconnect the power plug and then reconnect it.

5.5 Maintenance

Any repairs must be performed by Xingyi Service Center training service personnel and use original Xingyi accessories. If your machine needs repair, please contact with your retailer.

6. Frequently Asked Questions and Solutions

Problem	Possible reason	Solution
The machine can't run.	Emergency stop switch is pressed	Turn on the emergency stop switch
	Overload	Unplug the power cord and plug it in again.
	Power and power cable damage	Contact a licensed electrician
	There is a problem with the rear contact switch button	Make sure the wires are properly connected to the back button, check the contacts and the ignition button
The machine uttered a low buzz when turn on and turn off.	Dust in the motor impeller	Contact a licensed electrician
	Motor burned down	Contact a licensed electrician or check if the input power has three-phase input
	Phase loss input, currently only two phase inputs. Turn off the machine power to avoid burning the motor	Contact a licensed electrician or check if the input power has three-phase input
The machine is difficult to hold or the motor current consumption is large	There are not enough diamonds pads under the device or using wrong diamonds	Use the number of diamonds recommended by Xingyi to reduce workforce on the grinder and operator
Unable to charge	Field voltage is lower than 350v	
	Battery power is used to 0	Charge with a single-phase electric charger for 1 hour
	The battery is damaged, or the times of impulse electricity it has been exceeds its life.	Replace the battery
	Machine charger fuse burned	Consider replacing a fuse
Machine beating	Diamond pads may not be properly installed or heights are different	Properly install diamonds with the same height
	The grinding disk is not flat	Adjust and install the disks
Machine forward, backward out of control	Low battery	Check if the battery circuit is normal
	Walking motor damage	Check and contact with factory to repair and change the key
	Battery damage	Check and contact the factory for repair and replace the damaged button.

7. Technical parameter

The table and picture show the technical data and dimensions of the grinder.

800LE	
Engine power	15KW/20HP
Rated voltage	3P 240V / 3P 480V
Rated current	55.55A / 32.23A
Input hertz	50HZ/60HZ
Inverter power	15KW/20HP
Working width	800mm/31.50in
Diameter of grinding disk	Φ256mm/Φ10.07in
Grinding speed	450 ~ 1950 r/min
Dimension(rear position)L*W*H	1500×850×2180mm/59.06×33.46×85.83in
Dimension(working position)L*W*H	2450×850×1150mm/96.46×33.46×45.28in
Dimension(packing position)L*W*H	1430×850×1190mm/56.30×33.46×46.85in
Max.Length*width*height	2880×850×2180mm/113.39×33.46×85.83in
Total weight	556kg
Cable model	10mm ² / 6mm ²
Storage temperature	-20 ~ +60°C / -4 ~ +140°F
Working temperature	-10 ~ +40°C / +14 ~ +104°F
Humidity	Below 95% (no condensation)

7. Technical parameter

Xingyi does not bear the cost of machine damage caused by improper transportation, unpacking and improper use. Local distributors may be subject to specific warranty terms, please contact with your local distributor for specific warranty terms.