



HIGH TECH GRINDING

XINGYI

Operation Manual

XINGYI XINGYI MACHINE USA LLC.

WEBSITE: www.xingyimachineusa.com

VOICE: 425-321-6773

EMAIL: ronnie@xingyimachineusa.com

GX-750 Grinder Manual

GX750 Floor Grinder Manual

1. Introduction

1.1 Summary

Xingyi machines are used to handle the floor surface. The scope of use of the machine depends on the choice of the tool. In addition to the use and general functions, this manual describes information on the use, repair and maintenance of the grinder. You can contact your local retailer for further information.

1.2 Responsibility

We make every effort to make this manual as complete and accurate as possible, and we are not responsible for any errors or loss of information. Xingyi reserves the right to change the instructions in this manual without prior notice.

This manual is protected by copyright law and can not be reproduced or used in any part without the express written consent of Xingyi.

1.3 Accessories

Below accessories are included with the grinder. Contact your supplier if anything is missing.

- (1) 1 set of grinding machine
- (2) 1 copy of machine using manual
- (3) 9 pcs of Velcro-iron accessories
- (4) 1 pcs of socket
- (5) 1 pcs of dust skirt

1.4 Package acceptance

Check carefully to see if the package or the grinder has been damaged during delivery. If there is any sign of damage, contact your supplier and report it. Check that the delivery matches the order. If there are any discrepancies, contact your supplier.

1.5 Machine name plate

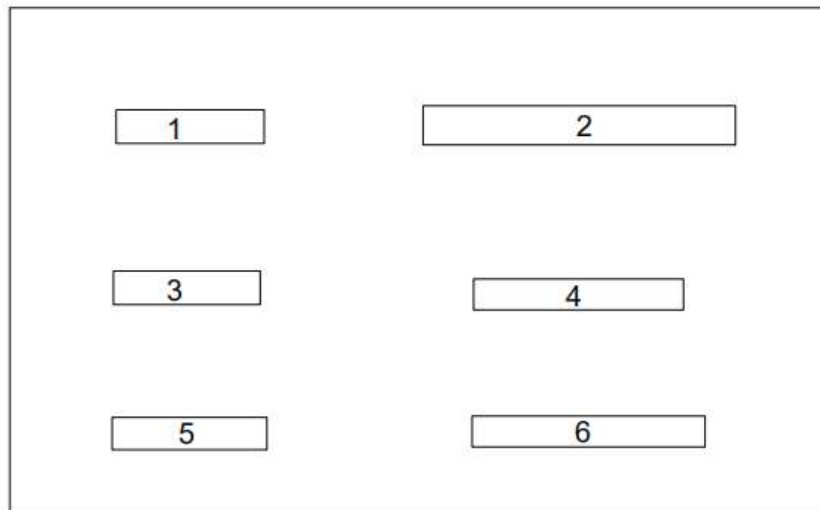

1. Model

2. Manufacturing date

3. Power

4. Voltage

5. Weight

6. Rotating speed

1.6 Handling and storage

The grinding machine should be stored in a dry place at room temperature when not in use. Otherwise it may be condensed and cold damaged. The size and weight of the grinder are given in the technical data of the Manual.

Note! Improper operation may lead to the grinding machine overturned and damaged, even endanger personal safety.

1.7 Warranty items

This warranty covers only manufacturing defects. Xingyi does not assume damage in the transport, unpacking or operation. The manufacturer is not responsible for any damage or defects caused by improper use, corrosion or use of specifications beyond the noted specifications. The manufacturer shall not be responsible for any indirect damage or expense under any circumstances. For complete information on the manufacturer's warranty period, please refer to the current warranty terms of Xingyi. Local retailer may have special warranty terms. If you have any uncertainty about the warranty terms, please contact with your retailer.

2. Safety Instructions

2.1 Overview

This manual records the key information for machine safety operation. Read the manual carefully before your first operation.

Non-standard operation, modification or maintenance without training may cause losses, machine problems or injury. You are allowed to operate the machine after training. All maintenance must be done by qualified professional technician. Any machine parts that need to be changed must be provided by XINGYI.

XINGYI machines only can be used in the way of XINGYI recommended. And they only can be used for commercial purposes. Anyone who uses a machine should know its function, the location of the emergency stop. The operator should have to ensure the safety rules that the unauthorized person can not be stationed at work area when the machine starts.

The operator should be equipped with professional personal protective equipment when you are at work: safety goggles, protective gloves, safety shoes, breathing masks, protective earmuffs, etc. Do not wear loose clothes or anything that can grasp things such as scarves, bracelets, rings and so on.

Note:

1. This machine is only used for floor grinding, polishing;

2. Read and understand the safety guide totally. Different models have different accessories and operation instructions.

3. Operation of this machine only needs one person. Keep children and irrelevant person away. Keep in mind that “one machine one person”.

4. Operator who is in poor physical state or without training is not allowed to operate the machine. The operator and the repairman must be physically strong and able to withstand the weight of the whole machine and the working intensity of the motor.

5. Do not lend or rent the machine without instruction manual.

6. Wear helmet, safety shoes, the headset, non-moist goggles and masks when operating the machine.

7. Keep body, jewelry or any loose clothing away from machine moving parts. Otherwise, it may endanger personal safety.

8. Random modification of the machine is not allowed. Only XINGYI accessories can be used for maintenance and adjustment.

9. Do not operate the machine in rainy or foggy days.

10. Ensure no explosive flammable materials and steam nearby when operate machine. Do not operate machine nearby the place with fuel, grain dust, solvents, dilution agent or other flammable items.

2.2 Operational safety instructions

1. Operators should wear protective equipment when using the machine, such as dust masks, protective gloves, overalls, helmets, insulated shoes and so on.

2. Make sure there is no oil leakage, electric leakage, water leakage on the machine before using. The machine can be used normally.

3. Check the machine control switches and electric parts are in good conditions without moisture.

4. Make sure no obstacle or human being at working area. and make sure there is enough lighting device.

5. The dust cover should be installed on the machine for safety. It is necessary to connect to industrial vacuum cleaner when dry grinding.

6. The machine should be connected to appropriate electrical outlet. Only use the power cables that can withstand high current.

7. Do not adjust the handle during machine operation. Only when the machine is stopped and the emergency stop switch has been pressed, the worker can adjust the machine.

8. The handle has different functions when it is in different positions. Please read the manual for more information.

9. Ensure the machine has stopped operating and the emergency stop button is pressed when changing abrasives or accessories. If necessary, disconnect the power and the plug.

10. Keep the machine away from drains and furnace mouths or other dangerous goods, otherwise it may cause personal injury or loss of machinery and property.

11. Tight-hold hand grip, clockwise rotate the emergency switch, then turn on the power button and start the machine.

12. Please note that the emergency stop switch can only be pressed or rotated. Prohibit upward pull.

13. Before operation, check the working surface and remove any protrusion to prevent machine plates and pads from damage.

14 Double check before connecting to power, make sure the working Voltage, HZ is same with input Voltage and HZ, no lack of phase of input power. (If the machine do not work normally , and it results in the input power and working power is not the same, then manufacturers warranty is unavailable.)

15. Connecting with vacuum to achieve dust free working condition.

16. Install appropriate abrasive. Improper abrasive may cause personal injury and floor damage.

17. After installing the abrasive, keep the grinding plate touch with ground directly, adjust handle bar to the "lifting position", so that the operator could operate the machine easily.

18. When the inverter turns to overload protection, it means there is something wrong with the machine(cable is too small or voltage is unstable) , if so please reference the following cable sizes which are recommend. Or reduce the abrasive pressure(adjust the additional weight iron to suitable position) if users keep using the machine when overload leads to damage, it would be not allowed to guarantee.

19. After few minutes of grinding, stop to check how much the abrasive uses. This behavior could reduce economic loss when using wrong polishing pads.

20. Please do not upward the machine when machine is still running, otherwise the polishing pads may fly out and cause injury.

2.3 Electrical safety instructions

1. All circuit repairs can only be carried out by qualified personnel.

2. Note: After the machine is stopped, the line is still energized. Disconnect all power before servicing the machine.

3. The machine is equipped with an overload protection device, and it will automatically jump off when the machine is overloaded, to prohibit the machine from running; (re-adjust this overload in case of safety)

4. Continue to use the machine in the overloaded situation may cause some other losses even machine can't work normally, then manufacturer's warranty is unavailable.

5. The purpose of installing an inverter in the machine is to speed and protect the user and the machine. It is forbidden to modify or adjust the inverter and modify the inverter parameters without the manufacturer's consent. If the unit fails, it is only allowed to replace the defective parts with the accessories provided by the manufacturer; (Other loss caused by changing, adjusting or modifying the inverter parameters without the manufacturer's consent, and the machine is not working properly, the manufacturer does not afford warranty)

6. Never modify the parts or lines inside the inverter by yourself.

7. Do not operate the machine when the distribution box is turned on.

8. If the machine current is overloaded, please pay special attention.

9. When the cables is energized or loaded, do not connect or disconnect the wires.

10. Using a damaged power cord may result in electric shock. Do not use a damaged power cord;

11. Cables should be kept away from hot surfaces.

12. The dryness of all electrical equipment should be maintained, and the machine should be kept in a dry place;

13. After the power is turned off, before the panel indicator is off, it indicates that there is still high voltage inside the inverter, which is very dangerous. Do not touch the uninsulated electrical equipment.

14. The machine motor and the frequency conversion box are prohibited from entering water; (the other damage caused by the water inflow then the machine is not working properly, the manufacturer does not afford the warranty).

15. The machine must be connected to the qualified wire and voltage; specifications is noted by the manufacturer. (The machine label indicates the power supply specifications).

3. Machine Description

3.1 Overview

GX750 is used to grind (rough grind, fine grind) concrete, natural stone and terrazzo floors or other materials specified in this manual or recommend by XINGYI.

The swing lever and handle can be set in many different tilted positions. The grinding head of the machine can be used with different grinding plate for operation. The anti-dust tape covers the working area of grinding head. Because of the floating design, it always touch the floor, which not only ensures that the operator does not touch the rotating mechanical parts, but also reduces the exposure of dust and improves the dust absorption efficiency of the vacuum cleaner.

When dry grinding, to prevent dust from being exposed to air, posing a threat to the health of the operator and nearby people, make sure that the vacuum cleaner is connected to grinder (preferably equipped with a vacuum cleaner manufactured by Xingyi) Due to inhalation of dust is harmful in the course of operation, even there is a vacuum cleaner protective mask is also necessary to protect health.

The machine can use different Xingyi abrasive. Due to the different ground materials, the abrasive discs used in grinding are also different.

3.2 Parts description

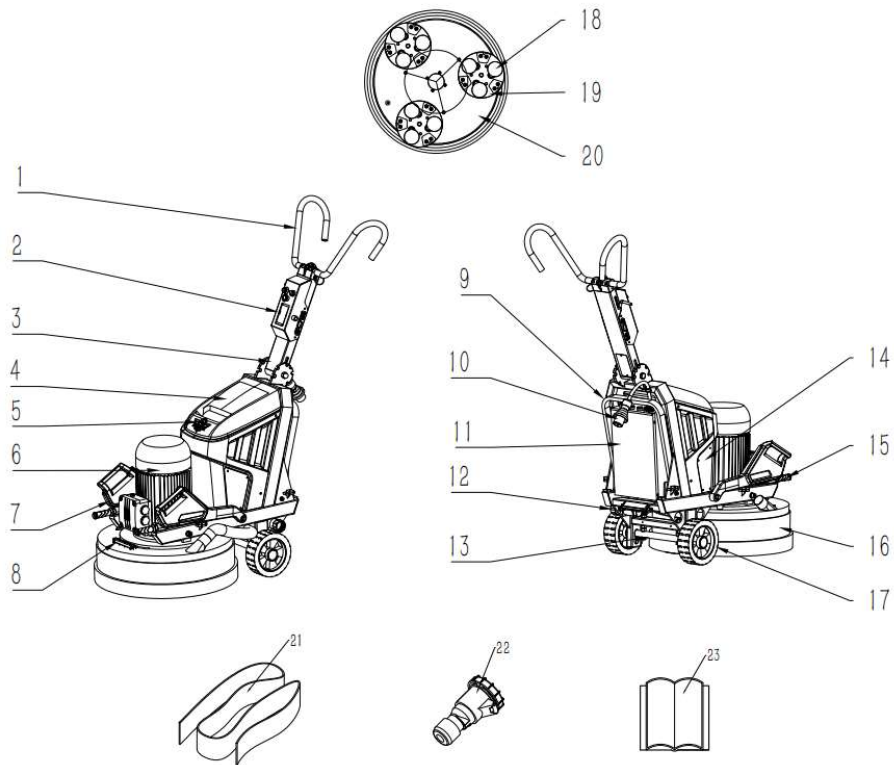

1. Swing lever handle
2. Control panel
3. Swing lever welding
4. Water tank
5. Logo part
6. Motor
7. Additional weight iron
8. Front LED light
9. Pedal
10. Plug
11. Electric cabinet
12. Rear led light

13. Wheel axle
14. Decorative plate
15. Lifting bar
16. Gearbox cover
17. Wheel
18. Velcro-iron accessories
19. Grinding disc assembly
20. Gearbox
21. Dust skirt
22. Socket
23. Manual

3.3 Swing lever assembly

3.3.1 Overview

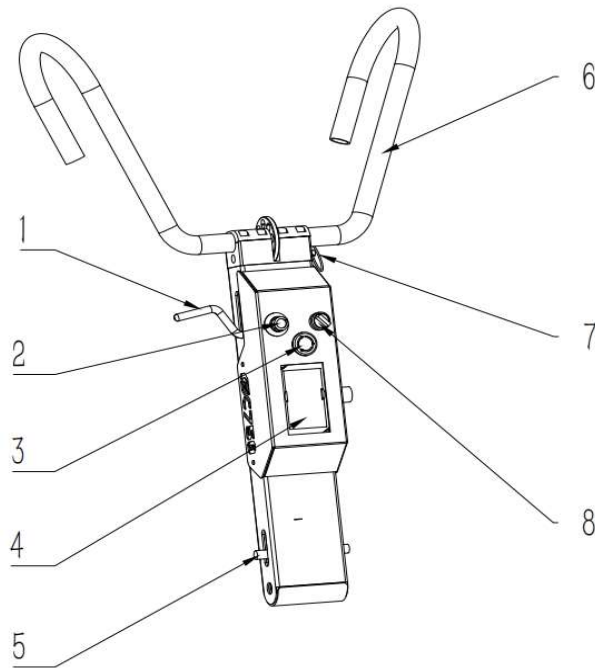

1. Handle angle adjustment bolt: pull out the bolt and the handle can be rotated freely to the proper position to operate the device.

2. Potentiometer: adjust the rotation speed of motor.

3. Emergency stop switch: When the device is in a dangerous state or needs to stop working, press the emergency stop switch to cut off the power and stop the operation of the device to achieve the protection of personal and equipment safety.

4. Display screen: display some parameters, such as voltage, current, motor speed, overload fault prompt, etc.

5. Swing lever locking rod: lock the rotation of swing lever.

6. Operation handle: the position of the user's hand in operation.

7. Handle angle adjustment bolt: pull out the bolt and the handle can be rotated freely to the proper position to operate the device.

8. Forward/reverse switch: it has three gears, the motor rotates forward on the left gear, does not rotate at the middle gear and rotates reversely on the right gear.

3.3.2 LED light switch device

Toggle the LED light switch to ON, LED light will be turned on, otherwise turned off.

The LED light base is a fixed , which can slightly adjust the far and near positions of lighting. It is convenient for users to adjust the far and near positions of ground illumination when operating the equipment. In this case, just rotate the LED light upward or downward.

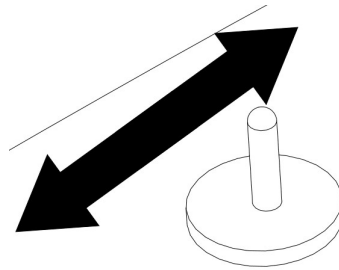

3.3.3 Handle

The adjusting pin on the handle adjusts the handle in different positions by locating different round hole positions to meet the different needs of the user. Hold the armrest in one hand, pull out the adjusting pin in the other hand, rotate to the right position, then release the adjusting pin.

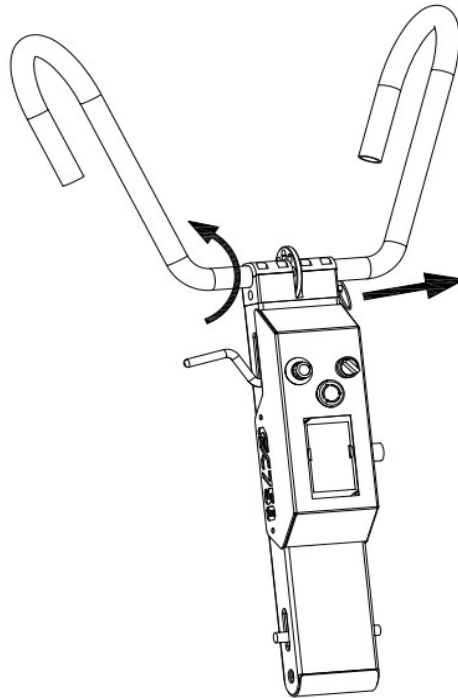

Note:

1. When plugging out the pin, sometimes it will be caught, and the pin can be pulled out by shaking the support wheel.

2. When the handle adjustment bolt is automatically reset, the hole may not be aligned, just rotate up and down

3. When adjusting the position of the handle, please check whether the handle adjustment pin has been automatically reset before operating the machine.

3.3.4 The angle adjustment of swing lever

Use the swing lever position adjusting handle to adjust the position of swing lever to realize conversion of the machine placement mode in different states. Hold the handle tightly with one hand to support the swing lever, the other hand tightens the swing level adjusting handle and press down the adjustment handle, rotate according to the hole location on sector plate, and release the adjusting handle when it reaches required position.

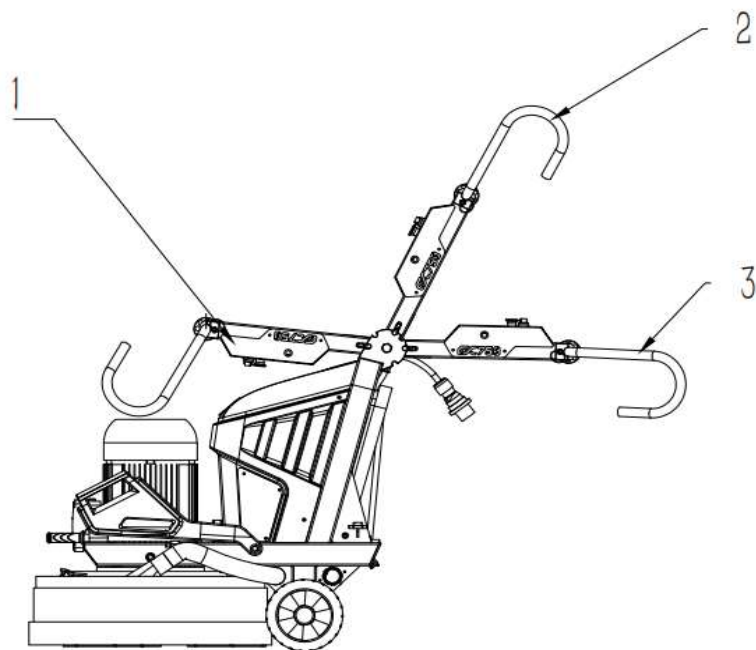
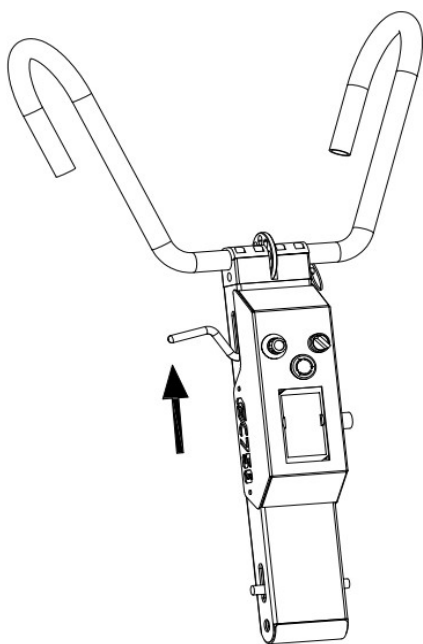

① Packing position ② Tilting position ③ Working position

Note: After adjusting the position of the swing rod, it is necessary to check whether the

swing rod has been limited before operating the machine.

3.4 Water tank

There is a water inlet on the top of the water tank. Water grinding can be carried out by turning the water switch clockwise.

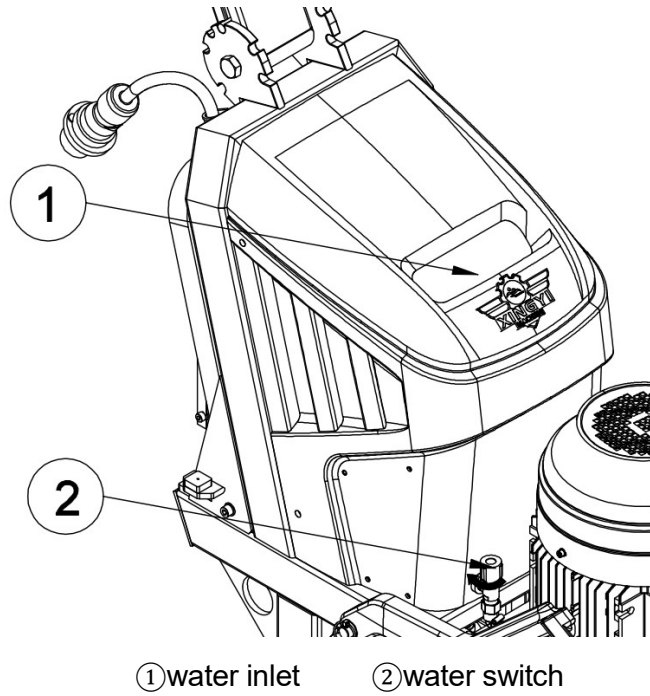

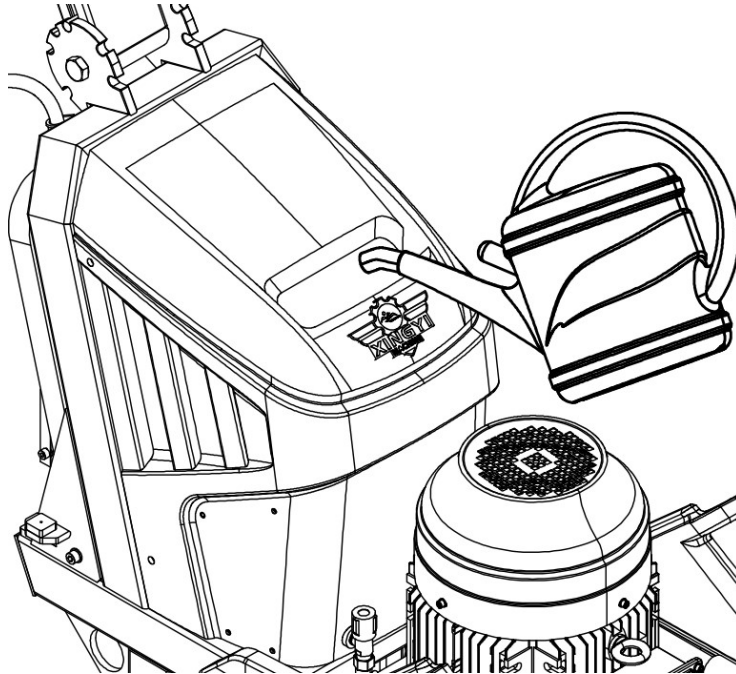

3.5 Vacuum hose installation

Installation and removal of the vacuum hose (as shown in the figure below), it is only necessary to assemble the three-way interface of the grinder with the vacuum hose when dry grinding (insert the vacuum hose interface directly into the three-way interface as shown in the figure below). Pull out the vacuum hose interface when wet grinding (as shown in the figure below).

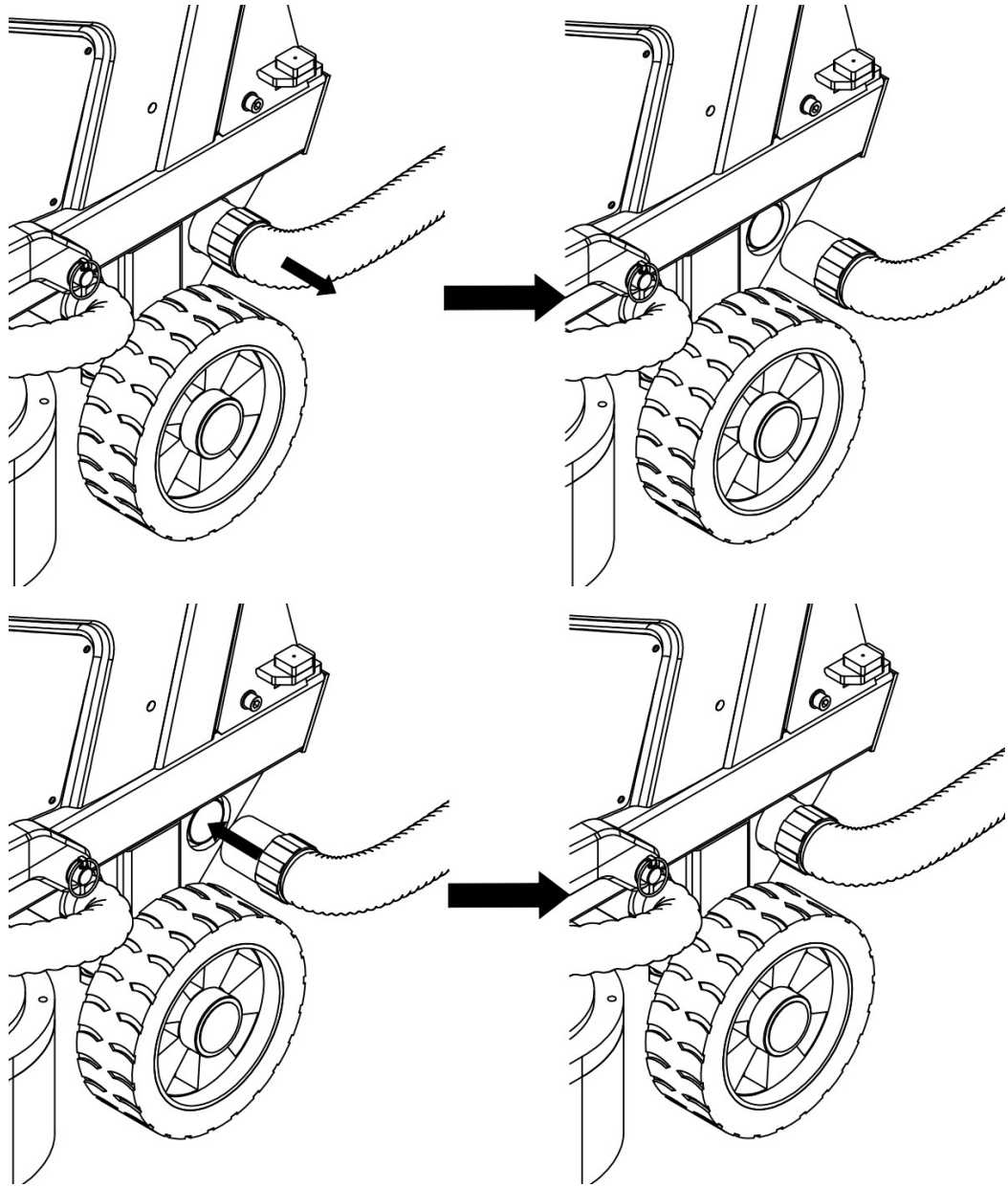

3.6 Additional weight iron

There are two positions for the additional weight iron: tilting, and working position. The adjustment of the additional weight iron depends on rotating, fixing the silicone pad support and its own weight.

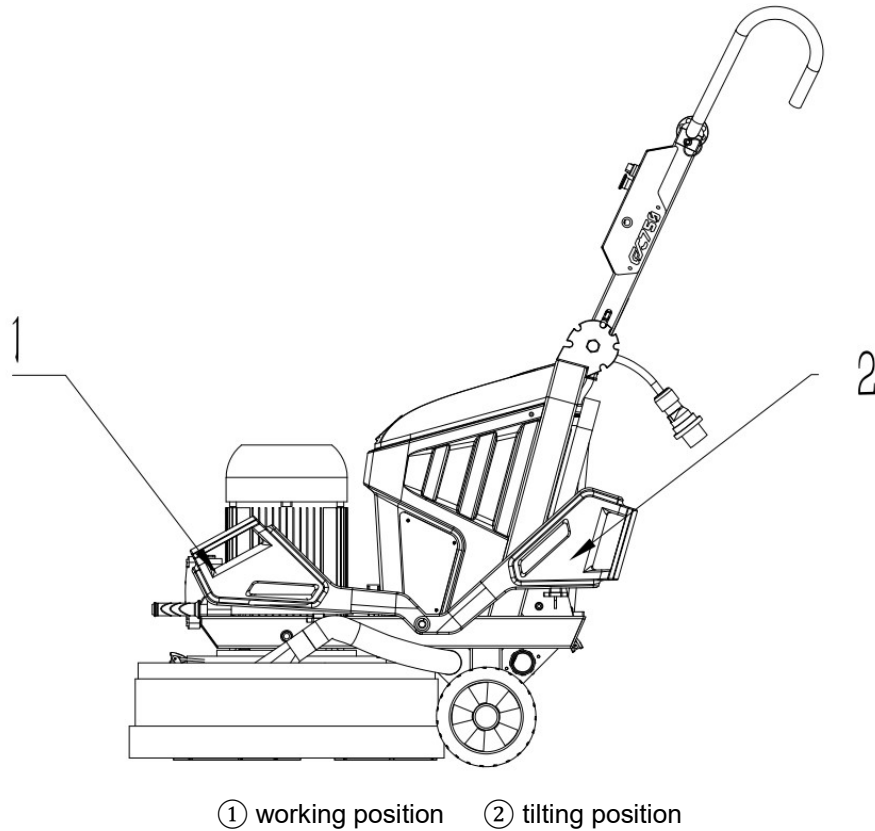

Note:

Hold the additional weight iron with one hand when switching the position

Hold the additional weight iron and swing in the required direction when you switch the working position to tilting position.

3.7 Pedal

The pedal has two different positions corresponding to the working position and the lifting position . Rotate the locating spring pin to adjust the position of the pedal.

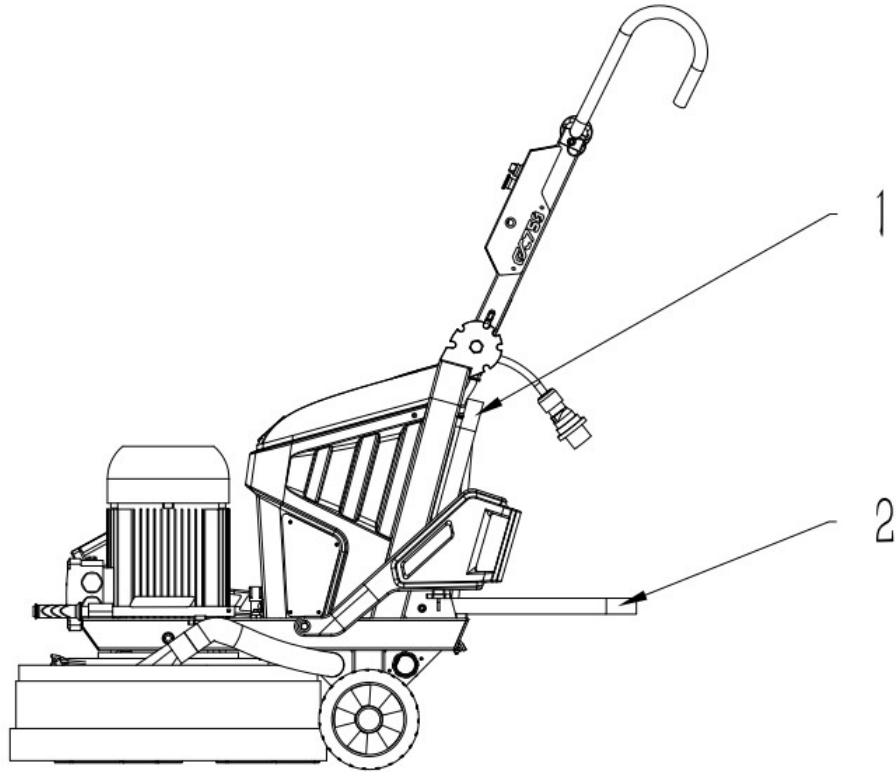

① working position ② tilting position

Note:

You only need to rotate the pedal to the required position when switching the pedal position.

Hold and swing the pedal to the position required when you need to switch the pedal from the working position to tilting position.

3.8 Inverter box

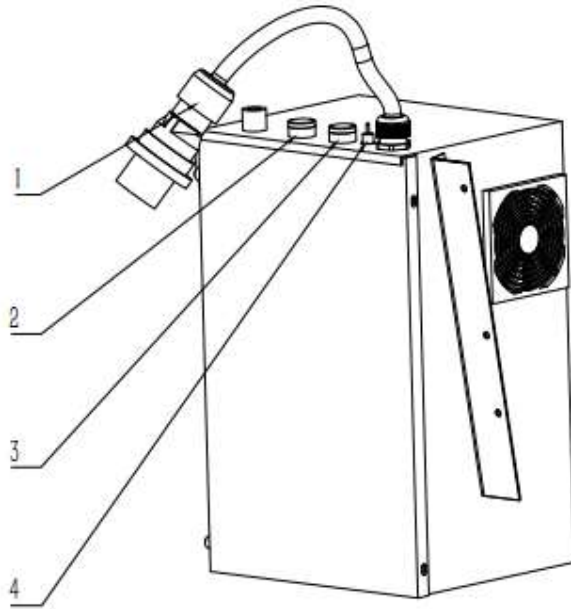

1. Power plug: used for connecting with external power supply to supply power to the equipment.

2. Power indicator light: the power indicator light will be on when the equipment is connected with power supply,

3. Operation indicator light: When the equipment is working normally, the operation indicator light will be on.

4. LED light switch: control the LED light.

4. Machine operating

4.1 Overview

The following part mainly describes the grinder in different positions, the main operation of the grinder and how to install grinding abrasive.

Note:

1. Grinders can only be used or repaired by personnel who have received the necessary theoretical and practical training and have carefully read the user manual.

2. Wear protective equipment such as protective gloves, protective masks, overalls,

helmets, insulated shoes, etc. when operating the grinder.

4.2 Machine position description

4.2.1 Machine working position

During grinding, gently lower the additional weight to proper position, adjust the handle and swing lever position to achieve the most proper working position.

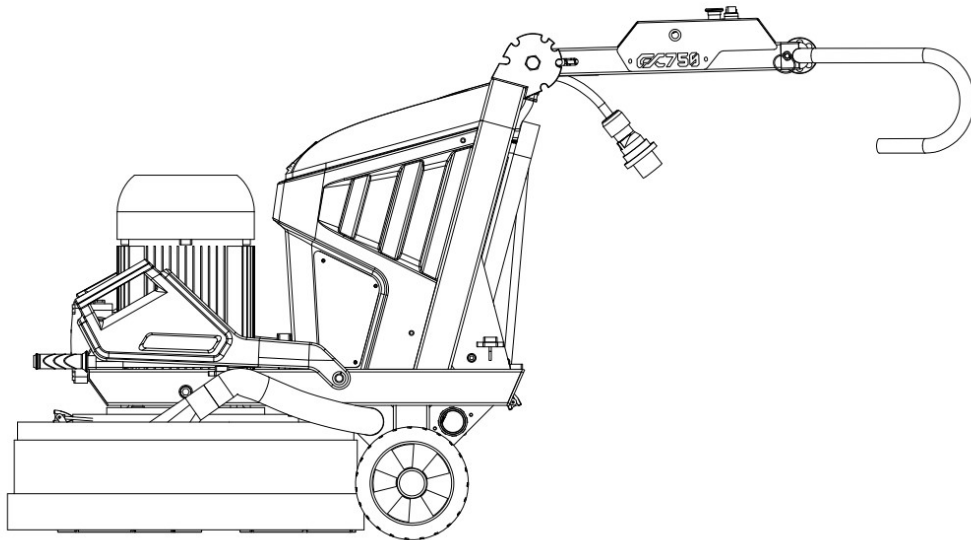

4.2.2 Machine carriage position

When the machine is transported, If you need to lift the machine, just pull the adjustable tightening handles on both sides of the rack and then tighten them. Then one person lifts the machine by using the lifting rod, and the other person lifts the machine by using the handle. Lift the machine at the same time.

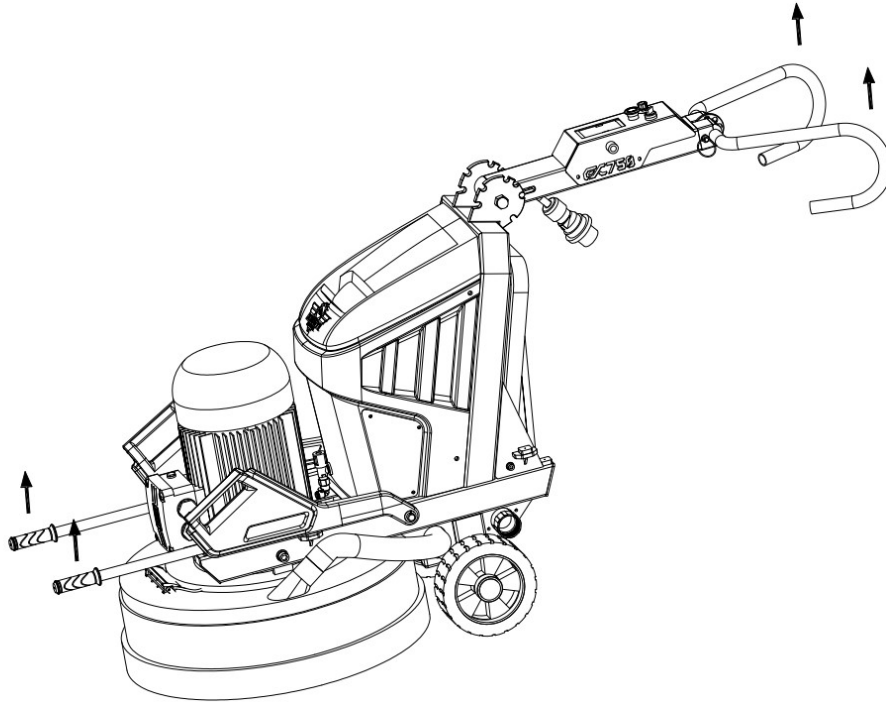

4.2.3 Machine package position

Adjust the position of the swing lever, foot pedal and handle to the packaging position. The minimum package size is as follows and the machine can be packaged according to its size.

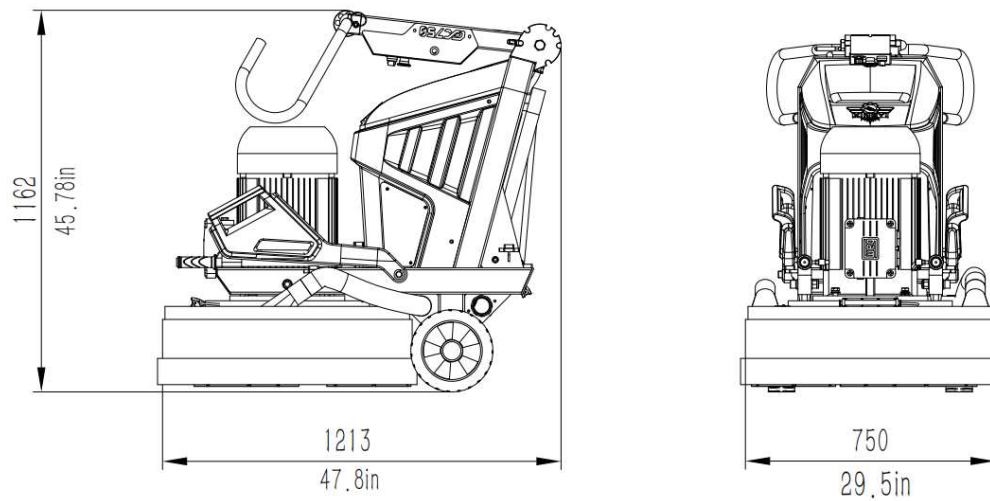

4.2.4 Machine tilting position

Adjust the additional weight to the tilting position, adjust the handle, pedal and swing lever position to the lifting position. (Recommended best lift up position)

Hold the handle with both hands and place one foot on the pedal to force machine down.

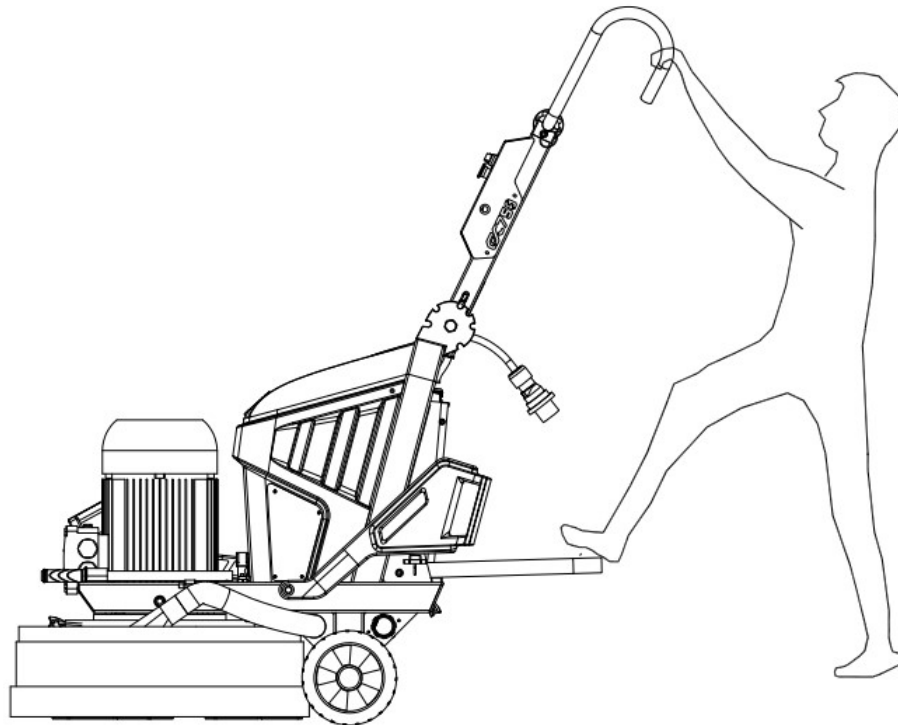

To put the machine down, you need to hold the handles tightly with both hands. Place your feet on the weighting iron lever handle, balance the machine with your own gravity, and slowly lower it to protect the grinding head. When you put down the machine, pay attention to your own strength, and do your best to ensure the safety of the machine and person. The supplier does not assume any responsibility for machine damage and personal injury caused by improper operation.

Note:

After lifting, stand near the grinding head and gently press it to see whether the machine is stable and whether there is a threat of toppling in front to ensure personal safety.

4.2.5 Precautions

1. Improper operation may lead to the grinding machine overturned and damaged, even endanger personal safety.
2. When the handle adjustment pin is pulled out, sometimes it will be stuck, and the handle needs to be pulled out while shaking the handle.
3. During adjustment, it is necessary to confirm the reset of the locking device before operating the machine.
4. Be careful when the grinder is adjusted to the position of transportation or packaging and there is a risk of crushing injury.
5. Dust inhalation is harmful. Please bring a professional mask during operation to ensure physical safety.
6. In the process of lifting and downing the machine, pay special attention to your safety and avoid damage to the machine.

4.3 Start and stop the grinder

1. Turn on the emergency stop switch and turn the three- gear switch to start the machine (the middle gear is stop, and the left and right gears are positive and reverse).

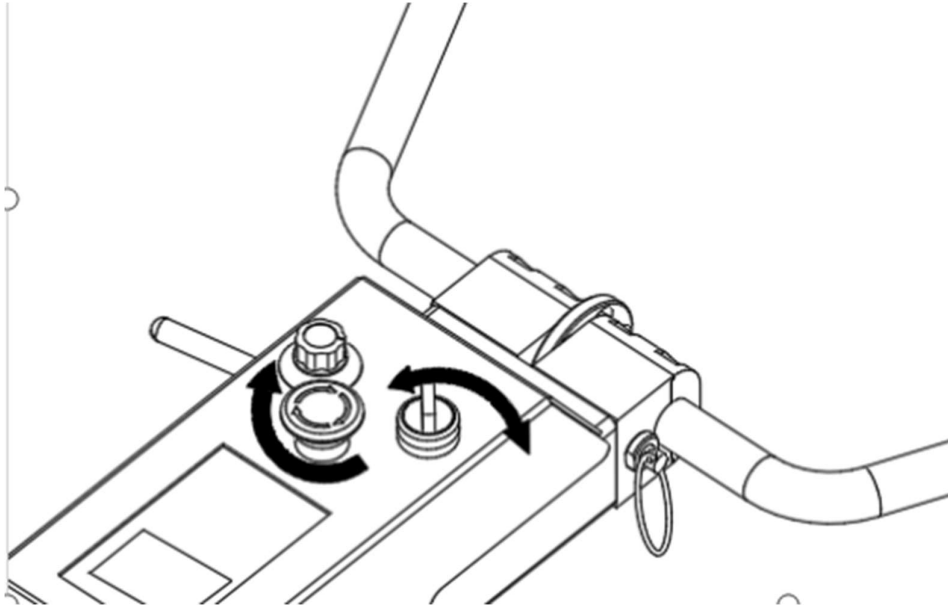

3. Stop machine: Press the emergency stop switch to stop machine.

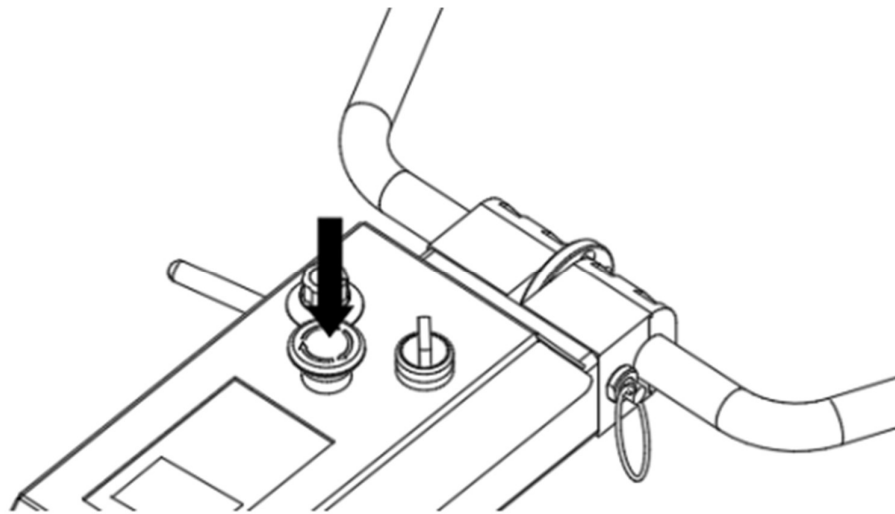

Note:

When stopping the device, it is recommended to unplug the power supply for safety reasons.

The emergency stop switch can only be rotated and pressed down according to the direction of rotation above the emergency stop switch, and cannot be pulled up.

When starting the machine, it is recommended to press the handle to lift the machine slightly, reduce the pressure of the grinding disc, and reduce the friction between the grinding disc and the ground, so as to avoid motor overloading when starting the machine.

4.4 Replace abrasives

When changing the abrasives, adjust machine to lifting position, then tip the machine carefully and lay it flat. After leveling the machine, stand next to the machine and check whether the machine is stable. Change the abrasives with a flat-blade screwdriver or scraper knife .

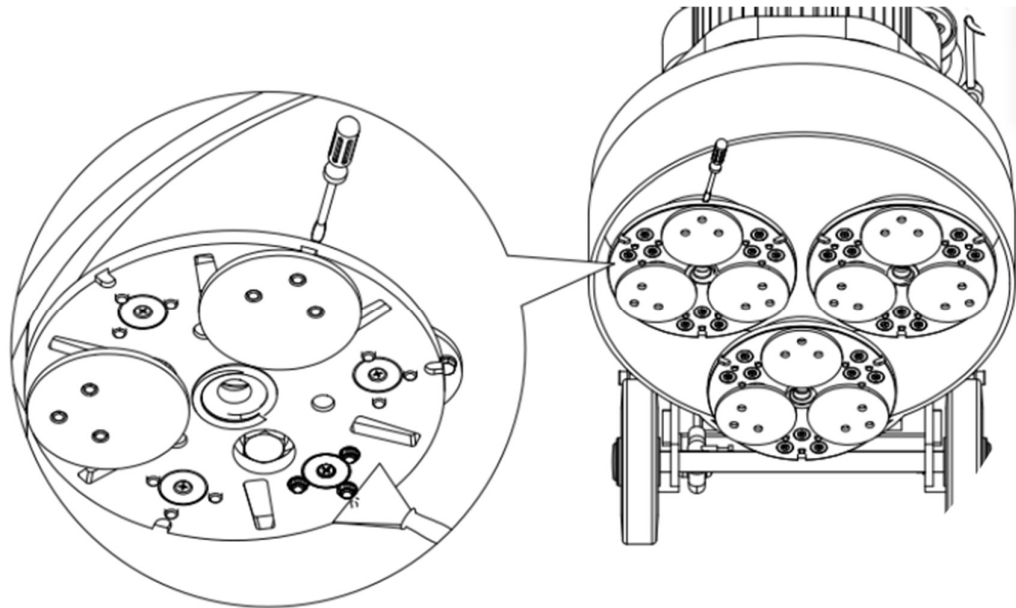

Note:

1. Please ensure that the machine won't tip forward before replacing the abrasive;
2. After the machine has been running for a period of time, the abrasive, grinding disc and the gear box will generate high temperature. Be careful to be burn when you replace the abrasive.

3. Replace the abrasive only when the power is unplugged and the emergency stop is pressed.

4.5 The wire winding

During machine working process, the wire wind method is particularly important, you can greatly improve your work efficiency and improve your safety. The specific operation is as follows:

1. Plug in an external power supply;
2. Turn the power cord through the swing lever handle;
3. The power cord wrapped around the handle at least two laps;
4. Slightly hard to pull the power cord to ensure that the power cord has enough friction so that the power cord firmly fixed on the handle.

Note:

1. Make sure the power plug and socket are securely connected;
2. Please make sure the emergency stop has been pressed before plug the power supply, and the other switch has been reset;
3. Power supply line, please use (please find in Manual) wire minimum wire size;
4. Please use the correct power supply.

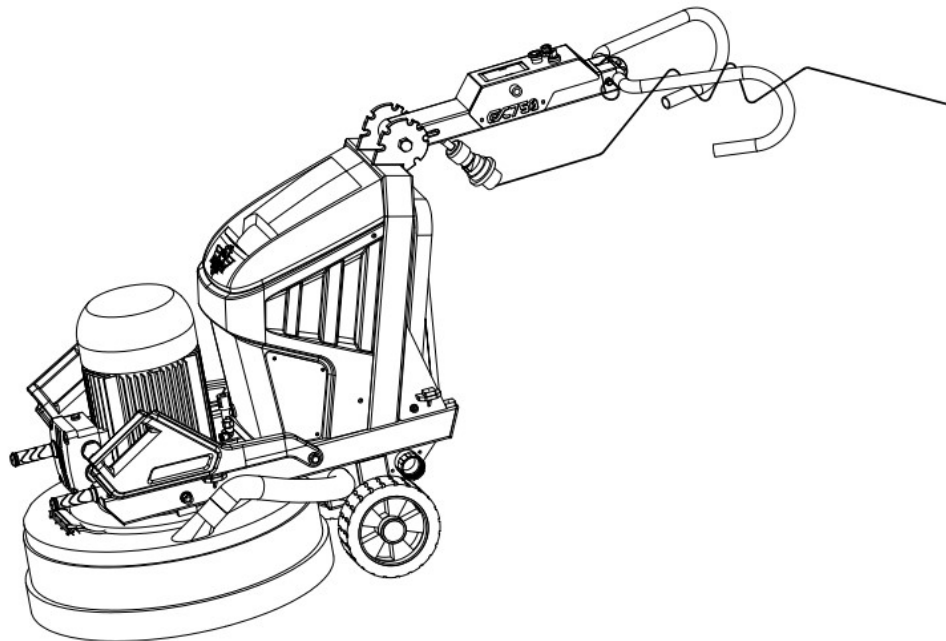

4.6 Grinding route (for reference)

When grinding the ground, it should be in accordance with the # method to grind the ground to get better effect. And according to # to grind ground, the machine grinding direction makes the wire more and more farther away, so that you can further avoid the interference of the wire to the normal work of the grinding machine.

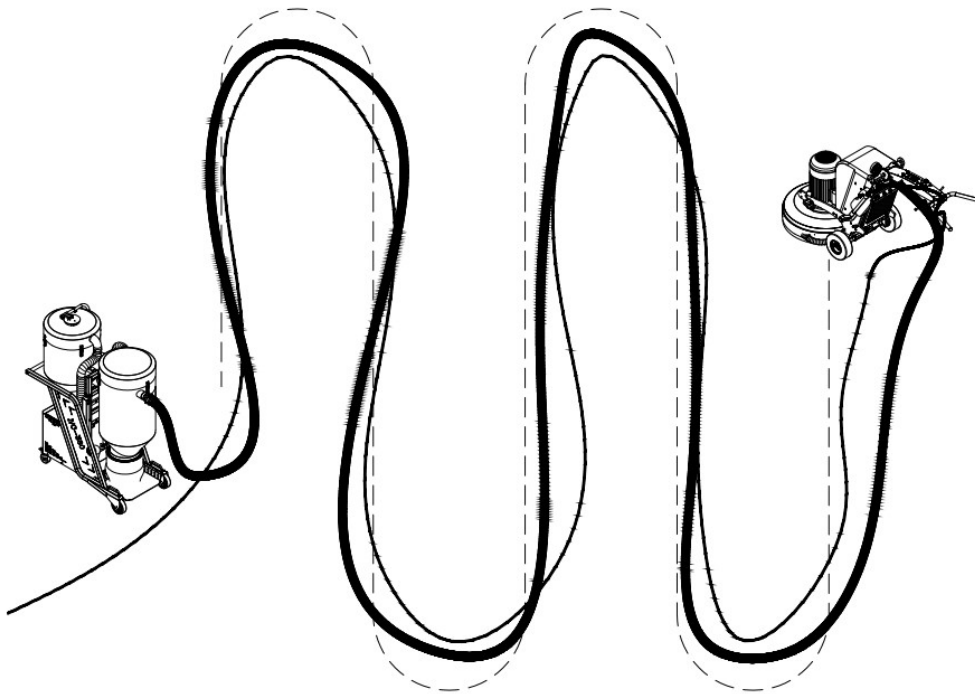

Note:

The above picture for machine model can be ignored. The grinding route and winding method are for reference only.

5. Equipment maintenance

5.1 Overview

We recommend that the grinding machine be checked regularly to extend the service life.

Note:

During the maintenance and repair process, the power of the grinder must be disconnected.

Wear protective equipment such as safety shoes, protective gloves, protective masks, etc.

5.2 Daily check**5.2.1 Check the switches**

The emergency stop switch should be rotated along the rotation direction of the switch. Turn the motor positive and negative knob to start the machine (Safely and normally start the machine, the running light will light up, if not normally start, then there will be the error code showed on the display screen)

Turn on the grinder and press the emergency stop switch to see if the machine stops.

Note:

For safety reasons, it is strongly recommended to press the emergency stop switch when stopping the device, which would be safer.

When starting the machine, it is recommended to press the handle to lift the machine slightly, reduce the pressure of the grinding disc, and reduce the friction between the grinding disc and the ground, so as to avoid motor overloading when starting the machine.

5.2.2 Check the disc cover

When there is a large amount of dust, it is easy to cause dust nozzle of grinding disc cover clogged by dust, use flashlight to see if there is dust clogged, clean up if necessary.

5.2.3 Check the disc

In the case of long hours of work or a large amount of dust, the grinding plate of grinding head may be stained with dust. It will lead lack of connection between grinding head and plate, which will affect grinding efficiency even lead to abrasive drop and cause accident. In view of this situation, please remember to clean up in time.

5.2.4 Note:

Be sure to wear protective equipment for maintenance checking such as protective gloves, protective masks, insulated shoes, etc.

The maintenance operation must be done when the emergency stop pressed and the power unplugged.

When the machine is tilted, make sure that the machine is flat and then check the operation of the grinding disc.

5.3 Cleaning

5.3.1 Clean switches

Grinding machine works on site for a long time, and the switch will inevitably run into the dust. For this reason, please check switch after grinding, to see whether the part is clogged by dust. Otherwise, it may cause the switch failure.

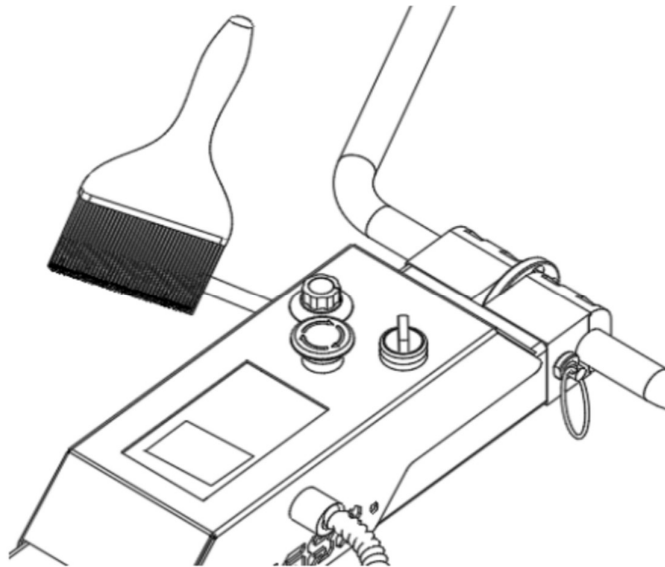

5.3.2 Clean the grinding plate and Velcro-iron accessories

Tilt the machine and use a cross screwdriver to remove the pads, and use shovel to remove dust. If you do not clean up in time, it is possible to make the pads disconnected, and pads fly out when grinding, causing damage to the machine and threaten personal safety.

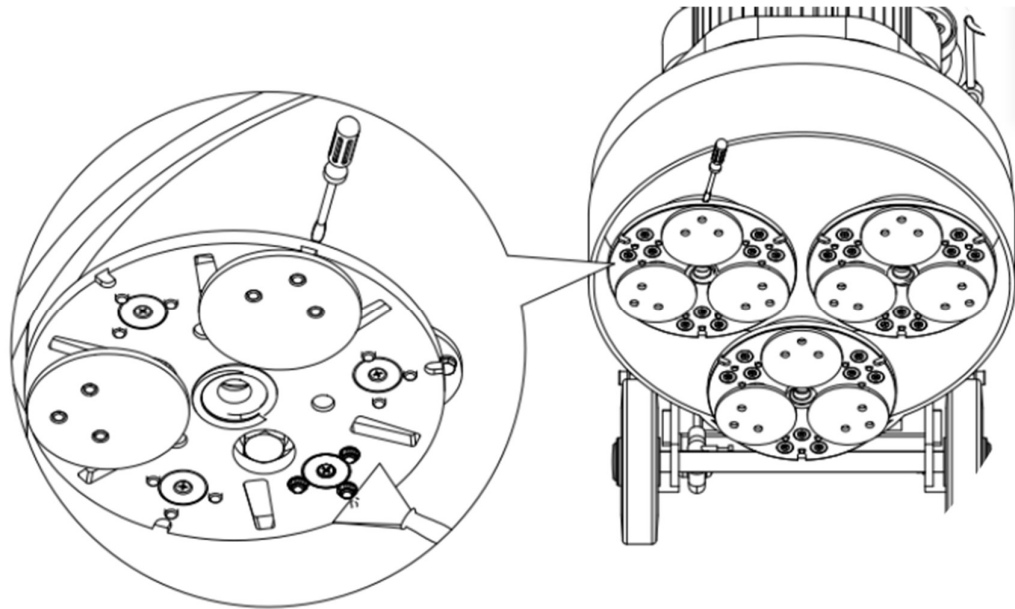

5.3.3 Note:

1. Be sure to disconnect the plug from the socket before cleaning, maintenance or assembly.
2. Be sure to clean the whole grinder after each day's working. Do not use a pressure washer to clean the machine directly.
3. In order to cool the equipment effectively, the cooling air port must be kept clear and clean.

5.4 Overload protection

The machine is equipped with an overload protection function on the inverter. When the machine is overloaded, the overload error will be showed on the display of the control panel. In this case, it is necessary to cut off the power, reduce the load, stop the machine for 10-30 minutes (depending on the motor temperature), and then restart the machine.

5.5 Maintenance

Any repairs must be performed by Xingyi Service Center training service personnel and use original Xingyi accessories. If your machine needs repair, please contact with your retailer.

6. Frequently Asked Questions and Solutions

This chapter describes some of the possible failures and how to handle them. If you still can not resolve or have an error, please contact your nearest retailer.

Problem	Potential cause	Solution
The machine can't run.	Emergency stop switch is pressed	Turn on the emergency stop switch
	Overload	Reduce the load and try to restart
	Power and power cable damage	Contact a licensed electrician
	Problem with the motor start switch	Change the switch
The machine stops immediately after starting	Overload protection	Reduce the load and try to restart
The machine is difficult to control or the motor current is consumed	There are not enough diamonds pads under the device or using wrong diamonds	Use the number of diamonds recommended by Xingyi to reduce workforce on the grinder and operator
Machine beating	Diamond pads may not be properly installed or heights are different	Properly install diamonds with the same height
	The grinding disk is not flat	Adjust and install the disks

7. Technical Data

The table and picture show the technical data and dimensions of the grinder.

	GX750	
Engine power	11KW/15HP	
Rated voltage	3P220V	3P380V
Rated current	41.58A	24.09A
Input hertz	50HZ/60HZ	
Inverter power	15KW/20HP	11KW/15HP
Working width	760mm/29.92in	
Diameter of grinding disk	Φ256mm/Φ10.08in	
Grinding speed	450 ~ 1950r/min	
Grinding pressure (weight iron in front)	239Kg	
Grinding pressure (weight iron is behind)	197Kg	
Total weight	395.5KG	
Cable model	6mm ²	
Storage temperature	-20 ~ +60° C / -4 ~ +140° F	
Working temperature	-10 ~ +40° C / +14 ~ +104° F	
Humidity	Below 95% (no condensation)	

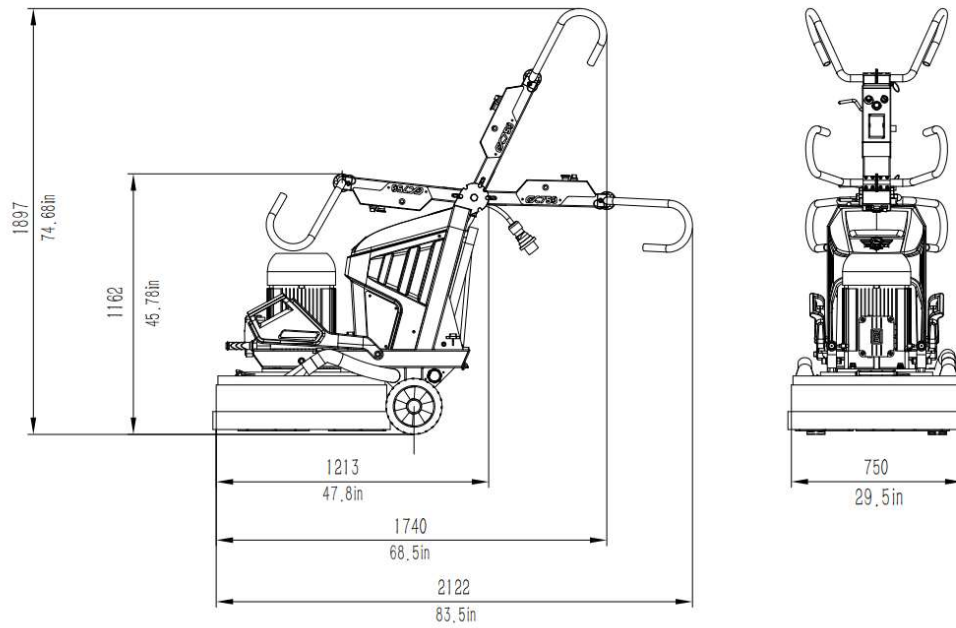

8. Warranty

Xingyi does not bear the cost of machine damage caused by improper transportation, unpacking and improper use. Local distributors may be subject to specific warranty terms, please contact your local distributor for specific warranty terms.