



HIGH TECH GRINDING

XINGYI

Operation Manual

XINGYI XINGYI MACHINE USA LLC.

WEBSITE: www.xingyimachineusa.com

VOICE: 425-321-6773

EMAIL: ronnie@xingyimachineusa.com

GX-65 Grinder

GX65 Floor Counter Rotary Grinder Manual

1. Introduction

- 1.1 Summary
- 1.2 Responsibility
- 1.3 Accessories
- 1.4 Package acceptance
- 1.5 Machine name plate
- 1.6 Handling and storage
- 1.7 Warranty items

2. Safety Instructions

- 2.1 Overview
- 2.2 Operational safety guidance
- 2.3 Electrical safety guidance

3. Machine Description

- 3.1 Overview
- 3.2 Parts description
- 3.3 Swing lever assembly
 - 3.3.1 Overview
 - 3.3.2 The angle adjustment of swing lever
- 3.4 Water tank
- 3.5 Vacuum hose installation
- 3.6 Additional weight iron
- 3.7 Foot pedal

4. Machine Operation

- 4.1 Overview
- 4.2 Machine position description
 - 4.2.1 Machine working position
 - 4.2.2 Machine Transport position
 - 4.2.3 Machine package position
 - 4.2.4 Machine upright position
 - 4.2.5 Precautions
- 4.3 Start and stop the grinder
- 4.4 Replace abrasives
- 4.5 Method of machine wire winding
- 4.6 Grinding route (for reference)

5. Maintenance Items

- 5.1 Overview
- 5.2 Daily check
 - 5.2.1 Check the switches
 - 5.2.2 Check the disc cover
 - 5.2.3 Check the disc

5.2.4 Note

5.3 Cleaning

5.3.1. Clean switch

5.3.2 Clean the grinding disc cover

5.3.3 Clean up the grinding disc and conversion block

5.3.4 Note

5.4 Overload protection

5.5 Maintenance

6. Frequently Asked Questions and Solutions

7. Technical Data

8. Warranty

1. Introduction

1.1 Summary

Xingyi machine are used to handle the floor surface. The scope of use of the machine depends on the choice of the tool. In addition to the use and general functions, this manual describes information on the use, repair and maintenance of the grinder. You can contact your local retailer for further information.

1.2 Responsibility

We make every effort to make this manual as complete and accurate as possible, and we are not responsible for any errors or loss of information. Xingyi reserves the right to change the instructions in this manual without prior notice.

This manual is protected by copyright law and can not be reproduced or used in any part without the express written consent of Xingyi.

1.3 Accessories

Below accessories are included with the grinder. Contact your supplier if anything is missing.

- (1) 1set of grinding machine
- (2) 1 copy of machine using manual
- (3) 1set of Velcro-iron accessories
- (4) 1pcs of socket (apply with machine's plug)
- (5) 1pcs of dust skirt

1.4 Package Acceptance

Check carefully to see if the package or the grinder has been damaged during delivery. If there is any sign of damage, contact your supplier and report it.

Check that the delivery matches the order. If there are any discrepancies, contact your supplier.

1.5 Machine name plate

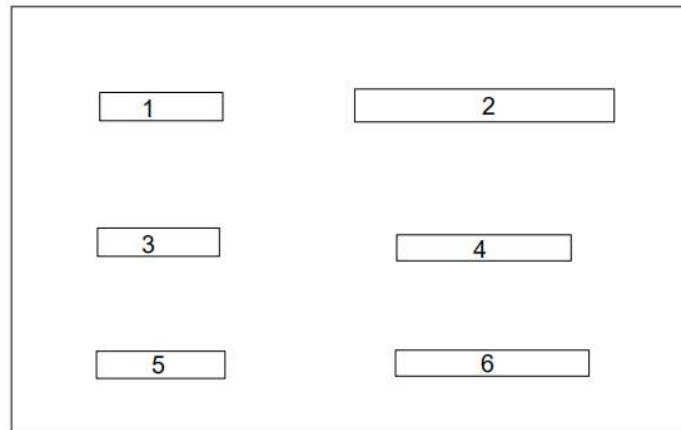

1. Model

4. Voltage

2. Manufacturing date

5. Weight

3. Power

6. Rotating speed

1.6 Handling and storage

The grinding machine should be stored in a dry place at room temperature when not in use. Otherwise it may be condensed and cold damaged. The size and weight of the grinder are given in the technical data of the Manual.

Note! Improper operation may lead to the grinding machine overturned and damaged, even endanger personal safety.

1.7 Warranty items

This warranty covers only manufacturing defects. Xingyi does not assume damage in the transport, unpacking or operation. The manufacturer is not responsible for any damage or defects caused by improper use, corrosion or use of specifications beyond the noted specifications. The manufacturer shall not be responsible for any indirect damage or expense under any circumstances. For complete information on the manufacturer's warranty period, please refer to the current warranty terms of Xingyi. Local retailer may have special warranty terms. If you have any uncertainty about the warranty terms, please contact with your retailer.

2. Safety Instructions

2.1 Overview

This manual lists the significant information for machine safety operation. Read the manual carefully before your first operation.

Non-standard operation, modification or maintenance without training may cause losses danger and machine problems. All maintenance must be done by qualified professional technician. Any machine parts that need to be changed must be provided by XINGYI.

Xingyi machines only can be used in the way of xingyi recommended. And they only can be used for commercial purposes.

The operator should be equipped with professional personal protective outfit when you are at work: safety goggles, protective gloves, safety shoes, breathing masks, protective earmuffs, etc. Do not wear loose clothes or anything that can grasp things such as scarves, bracelets, rings and so on.

Note:

1. This machine is only used for floor grinding, polishing;
2. Read and understand the safety guide. Different machines have different accessories and operation instructions.
3. Operation of this machine only needs one person. Keep children and irrelevant person away. Keep in mind that "one machine one person".
4. Operator who is in poor physical state or without training is not allowed to operate the machine. The operator and the repairman must be strong and able to withstand the weight of the whole machine and the working intensity of the motor.
5. Do not lend or rent the machine without instruction manual.
6. Wear helmet, safety shoes, the headset, non-moist goggles and masks when operating the machine.
7. Keep body, jewelry or any loose clothing away from moving parts of machine. Otherwise, it may endanger personal safety.
8. Random modification of the machine is not allowed. Only XINGYI accessories can be used for maintenance and adjustment.
9. Do not operate the machine in rainy or foggy days.

10. Ensure no explosive flammable materials and steam nearby when operate machine. Do not operate machine nearby the place with fuel, grain dust, solvents, dilution agent or other flammable items.

2.2 Operation safety guidance

1. Operators should wear protective equipment when using the machine, such as dust masks, protective gloves, overalls, helmets, insulated shoes and so on.

2. Make sure there is no oil leakage, electric leakage, water leakage on the machine before using. The machine can be used normally.

3. Check the machine control switches and electric parts are in good conditions without moisture.

4. Make sure no obstacle or human being at working area. And make sure good light.

5. The anti-dust tape should be installed on the machine for safety. It is necessary to connect to industrial vacuum cleaner when dry grinding.

6. The machine should be connected to appropriate electrical socket outlet. Only use the power cables that can withstand high current.

7. Do not adjust the machine during machine operation. when the machine stopped and the emergency stop switch has been pressed, the worker can adjust the machine.

8. The handle has different functions when it is in different positions. Please read the manual for more information.

9. Ensure the machine has stopped operating and the emergency stop button is pressed when changing abrasives or accessories. If necessary, disconnect the power and the plug.

10. Keep the machine away from drains and furnace mouths or other dangerous goods, otherwise it may cause personal injury or loss of machinery and property.

11. Hold the handle tightly, rotate the emergency switch clockwise, then turn on the power button to start the machine.

12. Please note that the emergency stop switch can only be pressed or rotated. Pulling upward is prohibited.

13. Before operation, check the working surface and remove any nails, bolts to prevent machine and pads from damage.

14. Double check before connecting to power, make sure the working Voltage, HZ is coincident with input Voltage and HZ, no lack of phase of input power. (If the machine do not work normally, and it

results in the input power and working power is not the same, then manufacturers warranty is unavailable.)

15. Connecting with vacuum to achieve dust free working condition.

16. Install appropriate abrasive. Improper abrasive may cause personal injury and floor damage.

17. After installing the abrasive, keep the grinding plate touch with ground directly, adjust handle bar to the "lifting position", so that the operator could operate the machine easily.

18. When the inverter turns to "overload protection", which means there is something wrong with the machine(cable is too small or voltage is unstable). In this case,please refer the following recommend cable sizes, or reduce the abrasive pressure(adjust the additional weight to suitable position). The damage caused by continuous operating of machine in overload situation will not be allowed to guarantee.

19. After few minutes of grinding ,stop to check how much the abrasive uses. This behavior could reduce the economic loss caused by using wrong pads.

20. Please do not elevate the machine when machine is still running , otherwise the polishing pads may fly out to threaten the human safety.

2.3 Electrical safety guidance

1. All circuit repair should be carried out by qualified personnel only;

2. Note: After the machine is stops, the circuit is still alive is still energized. Disconnect all power before repairing the machine.

3. The machine is equipped with an overload protection device and it will automatically turn off when the machine is overloaded, to prohibit the machine from running; (re-adjust this overload in case of safety)

4. The damage caused by continuous operating of machine in overload situation will not be allowed to guarantee.

5. The purpose of installing an inverter in machine is to speed and protect the user and the machine. It is forbidden to modify or adjust the inverter and adjust the inverter parameters without the manufacturer's consent. If the device fails, it is allowed to replace the defective parts with the accessories provided by the manufacturer; (Other loss caused by changing, adjusting or modifying the inverter parameters without the manufacturer's consent, and the machine is not working properly, the

manufacturer does not afford warranty)

6. Never modify the parts or circuits inside the inverter by yourself.
7. Do not operate the machine when the distribution box is turned on.
8. If the machine current is overloaded, please pay special attention;
9. When the wires do not connect or remove the electrical wires;
10. Using a damaged power cord may result in electric shock. Do not use a damaged power cord;
11. Cables should be kept away from hot surfaces;
12. The dryness of all electrical equipment should be maintained and the machine should be kept in a dry place;
13. After the power is turned off but the panel indicator is still on, which indicates that there is still high voltage inside the inverter, which is very dangerous. Do not touch the uninsulated electrical equipment;
14. The machine motor and the inverter box must be prevented from water. The manufacturer does not provide warranty for other loss or machine failure caused by water.
15. The machine must be connected to the wire and voltage, specifications is specified by the manufacturer. (The machine label indicates the power supply specifications).

3. Machine Description

3.1 Overview

GX65 is used to grind (rough grind, fine grind) concrete, natural stone and terrazzo floors or other materials specified in this manual or recommend by XINGYI.

The swing lever and handle can be set in many different tilted positions. The grinding head of the machine can be used with different grinding plate for operation. The anti-dust tape covers the working area of grinding head. Because of floating design, the dust cover always touch the floor, which not only ensures that the operator does not touch the rotating mechanical parts, but also reduces the exposure of dust and improves the dust absorption efficiency of the vacuum cleaner.

When dry grinding, In order to being exposed to air and posing a threat to the health of the operator and nearby people. Make sure that the vacuum cleaner is connected to grinder (equipped with a vacuum cleaner manufactured by Xingyi makes better effect) Due to inhalation of dust is harmful in the course

of operation, even there is a vacuum cleaner protective mask is also necessary to protect health. Dust is harmful, so please wear protectively.

The machine can used with different Xingyi abrasive. Due to the different ground materials, the abrasive discs used in grinding are also different.

3.2 Parts description

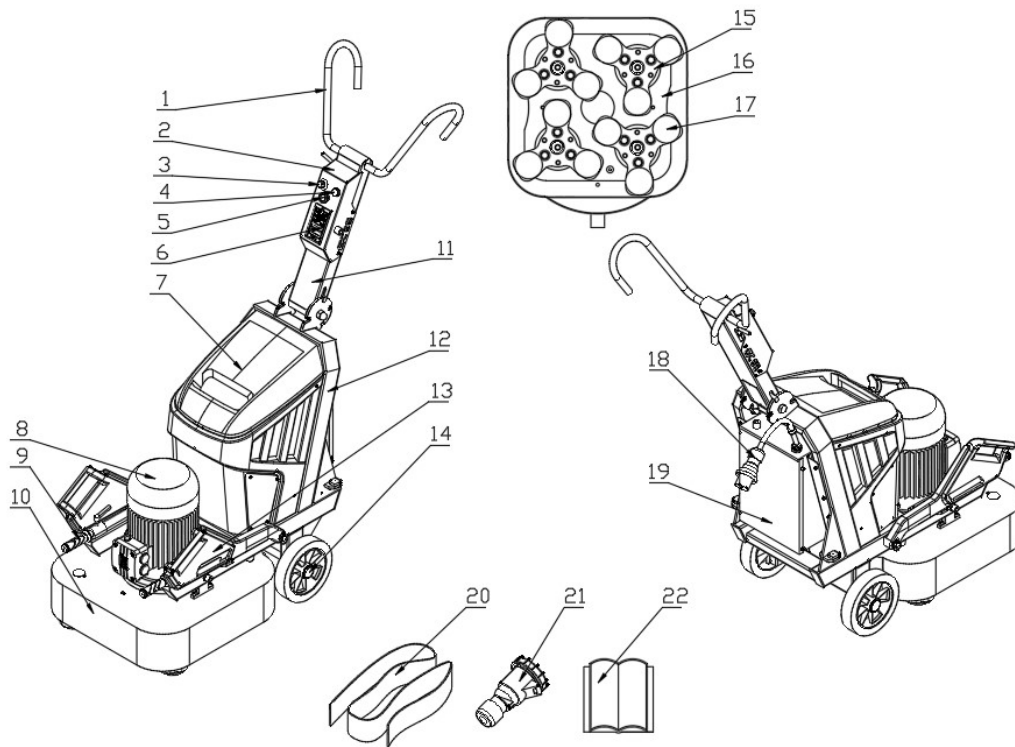

- 1. Operating handle
- 2. Control panel
- 3. Motor governor
- 4. Start button
- 5. Emergency stop button
- 6. Display screen
- 7. Water tank
- 8. Motor
- 9. Carrying Poles
- 10. Gear box
- 11. Swing lever

- 12. Frame
- 13. Additional weight iron
- 14. Wheels
- 15. Grinding plate
- 16. Gear box
- 17. Velcro-iron accessories
- 18. Power plug
- 19. Inverter box
- 20. Dust skirt
- 21. Plug
- 22. Manual

3.3 Swing lever assembly

3.3.1 Overview

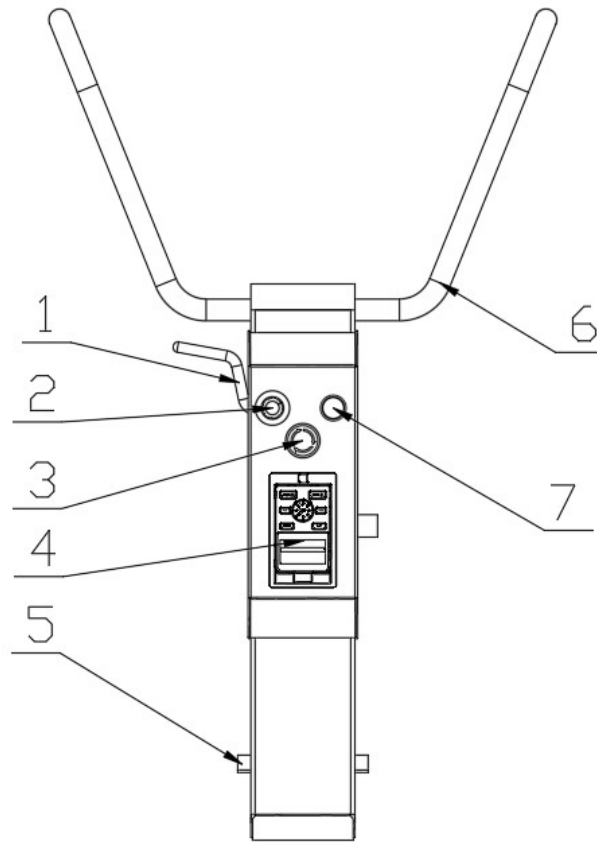

1. Swing lever angle adjustment handle: adjust the angle of swing lever to corresponding location.
2. Speeder: adjust the rotation speed of motor.
3. Emergency stop switch: When the device is in a dangerous state or needs to stop working, press the emergency stop switch to cut off the power and stop the operation of the device to protect of personal and equipment safety.
4. Display Screen: Display some parameters, such as voltage, current, motor speed, overload fault.
5. Swing lever locking: lock the rotation of swing lever.
6. Operation handle: The position of people's hands when operating the machine.
7. Start button: This button only works when the emergency stop switch is reset, and the grinder will start when pressed.

3.3.2 The angle adjustment of swing lever

Use the swing lever position adjusting handle to adjust the position of swing lever to realize conversion of the machine placement mode in different states(Different equipment states are as follows). Hold the handle tightly with one hand to support the swing lever, turn the other hand counterclockwise and press down the adjustment handle, rotate according to the hole location on sector plate, and release the adjusting handle when it reaches required position.

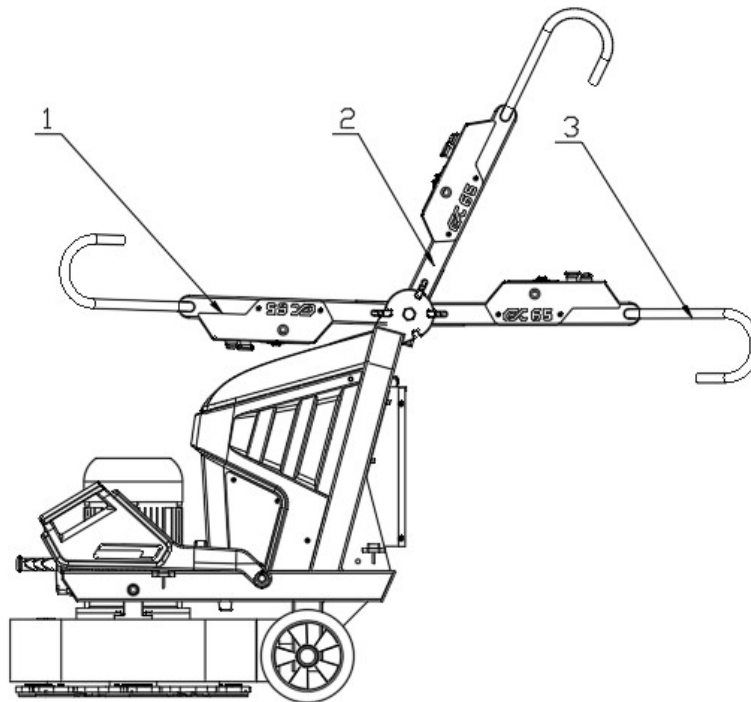
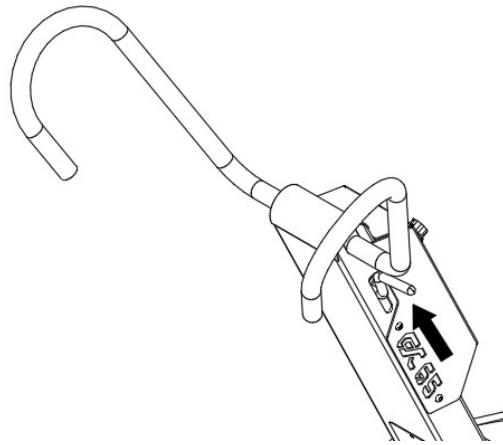

1 Packing position 2 Tilting position 3 Working position

Note: After adjusting the position of the swing rod, it is necessary to check whether the swing rod has been limited before operating the machine.

3.4 Water tank

There is a water injection port on the top of the water tank, which can be filled with water. When the equipment needs to perform water grinding work, turn the water switch clockwise to start water grinding work. When the water grinding is working, water is sprayed on the grinding disc to cool the abrasive, so that the grinding is more efficient. It can also prevent dust and protect the personal safety of users.

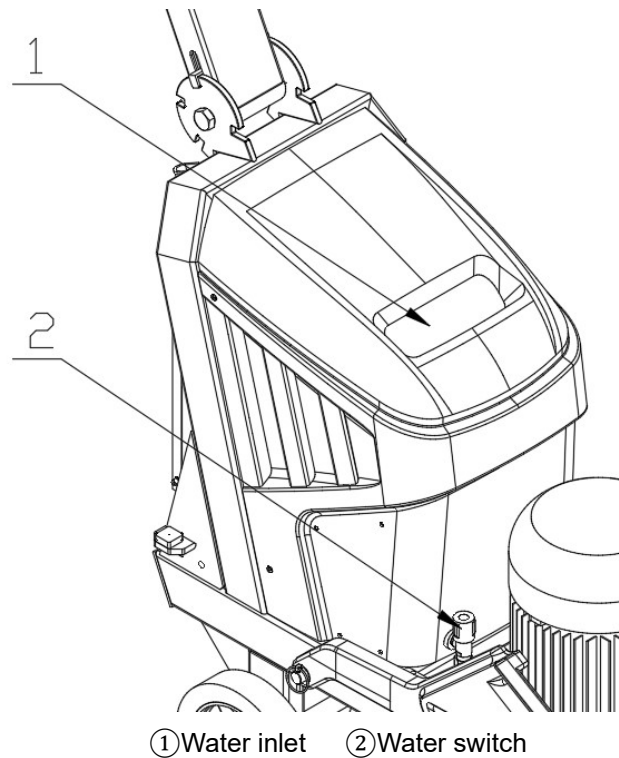

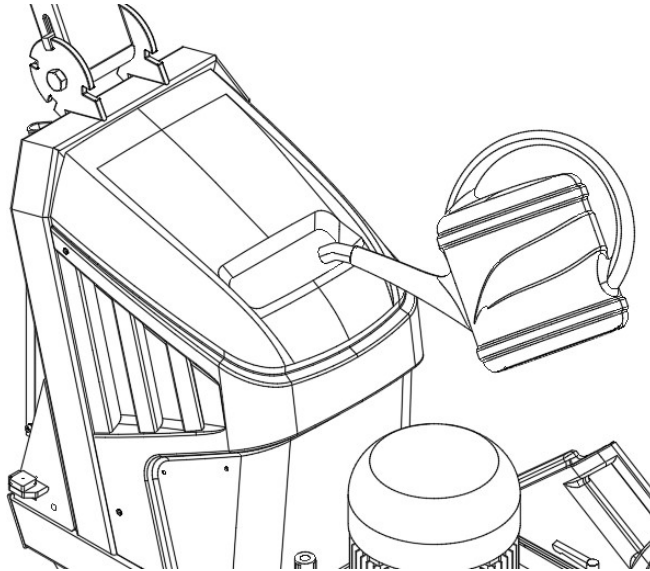

Note: Do not add too much water to avoid water overflow. When water grinding, always pay attention to the amount of water in the water tank.

3.5 vacuum hose installation

This machine is a dual-purpose model of dry grinding and wet grinding. When dry grinding, connect one end of a 50mm vacuum hose to the connection of the vacuum port on the gear box cover, lock it with a throat hoop, and connect one end to the vacuum cleaner. The vacuum hose can be threaded out of the pedal to avoid contact with the wheels.

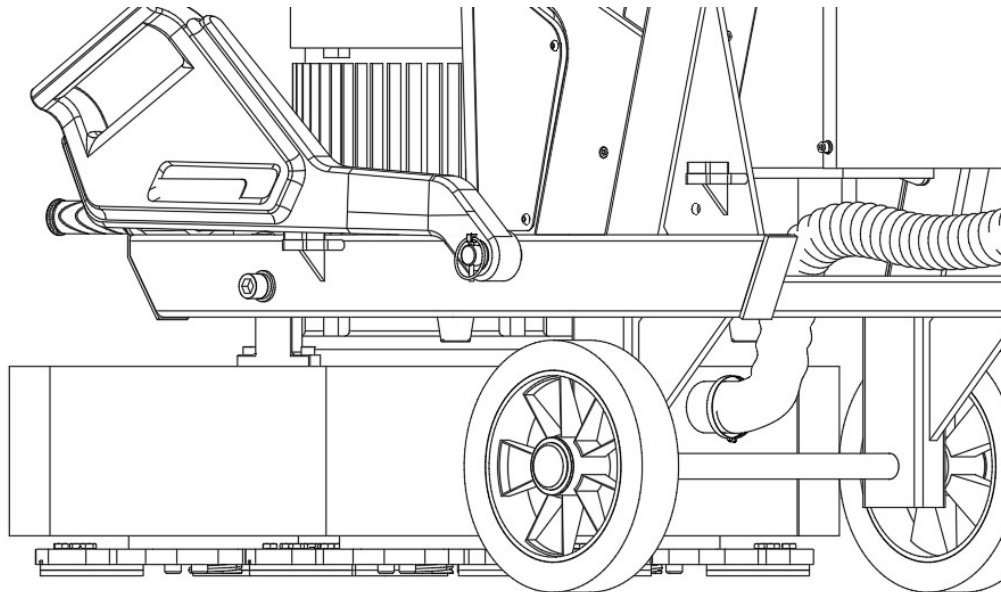

3.6 Additional weight iron

The additional weight iron has two different positions, which correspond to the working position and the tilting position on the equipment respectively. The adjustment of the position of the Additional weight iron is mainly based on the rotation and the fixed position of the silicone pad support and the dead weight to achieve the purpose of limit.

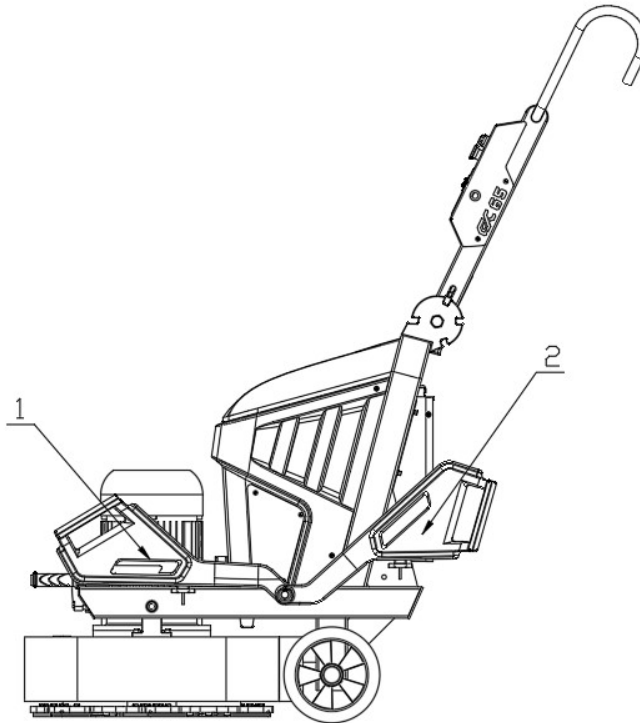

① Working position ② Tilting position

Notice:

When switching the position of the additional weight iron, you need to hold the additional weight iron with one hand;

When the additional weight iron is switched from the working position to the tilting position, the position can be switched by holding the additional weight iron and swinging in the required swing direction.

3.7 Foot pedal

The foot pedal has two different positions, which correspond to the working position and the tilt position on the equipment respectively. The adjustment of the pedal position is mainly for the purpose of rotating and positioning the beads to the limit.

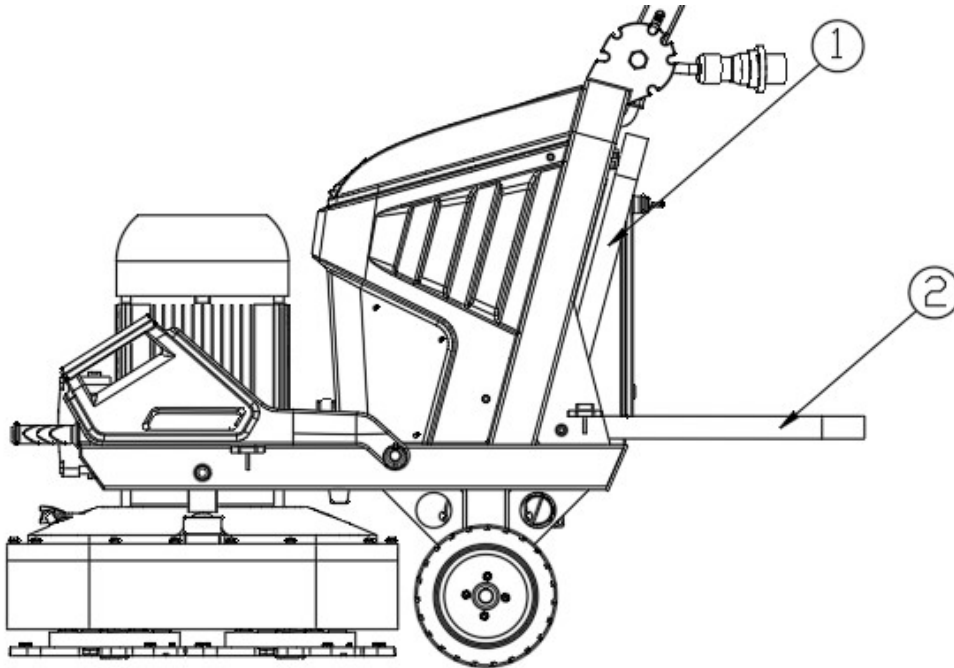

① Working position ② Tilting position

Notice:

When switching the position of the foot pedal, simply rotate the foot pedal to the desired position;

When the pedal is switched from the working position to the tilted position, hold the pedal and swing in the desired swing direction to switch the position.

4. Machine Operation

4.1 Overview

The following part mainly describes: When the mode is switched to manual operation, grinding machines in different positions, and the main operation of the grinder and how to install the grinding pads.

Note:

1. Grinders can only be used or repaired by person who have learned the necessary theoretical and practical training and have carefully read the user manual.
2. Wear protective outfit such as protective gloves, protective masks, overalls, helmets, insulated shoes, etc. when operating the grinder.

4.2 Machine position description.

4.2.1 Machine working position

When the grinder is working, the weighting iron needs to be lifted and rotated to reach the motor, gently lower the weighting iron to a suitable position and adjust the position of the handle and swing rod to achieve the most suitable working position.

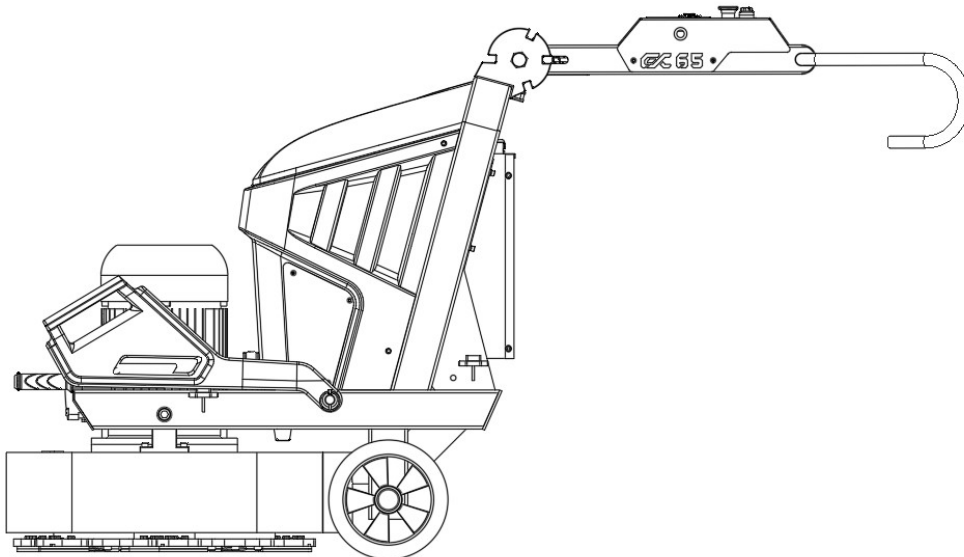

4.2.2 Machine Transport position

During the transportation of the machine, if it is necessary to lift the machine, loosen the adjustable and tightening handles on both sides of the frame, pull out the lifting rod, and then tighten it. Then one person uses the lifting rod to lift the machine, and the other uses the handle to lift the machine. The machine can be lifted and transported by applying force at the same time.

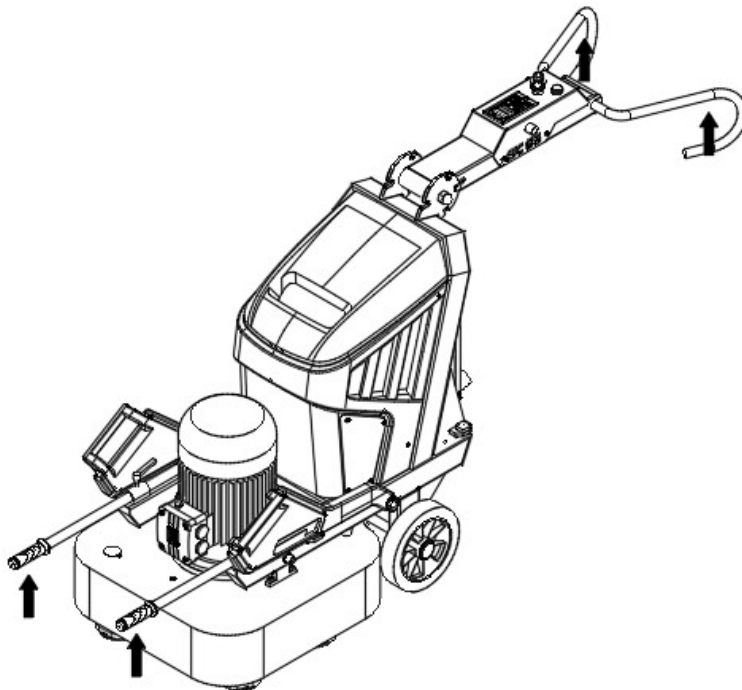
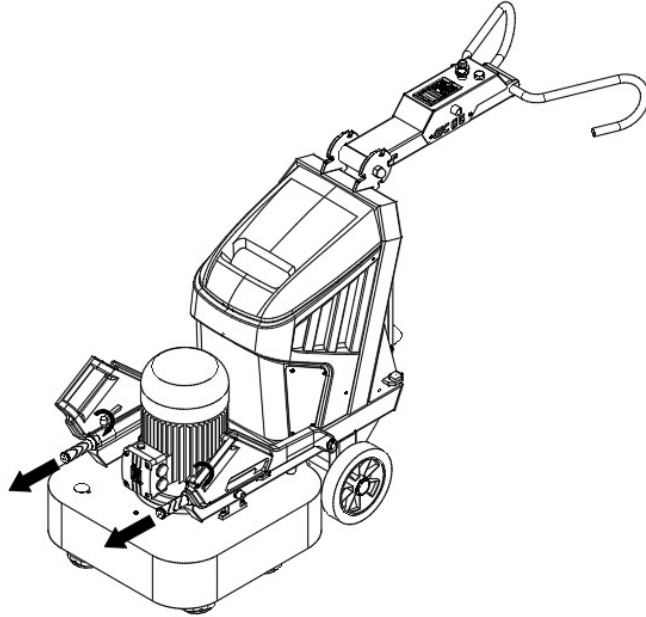

4.2.3 Machine package position

When packing, can adjust the position of swing rod, pedal, handle, so that it reaches the packing position.

The minimum packing size is as follows, which can be packed according to its size.

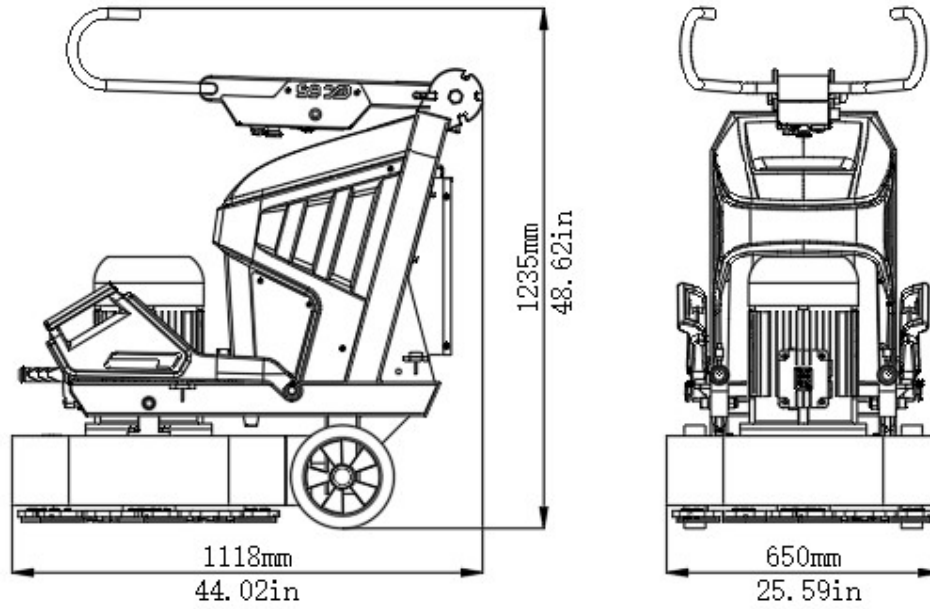

4.2.4 Machine upright position

Adjust the bolt of the additional weight iron so that the additional weight iron is in the upturned position, and adjust the swing lever to the upturned position of the equipment.
(Suggested best position to lift up)

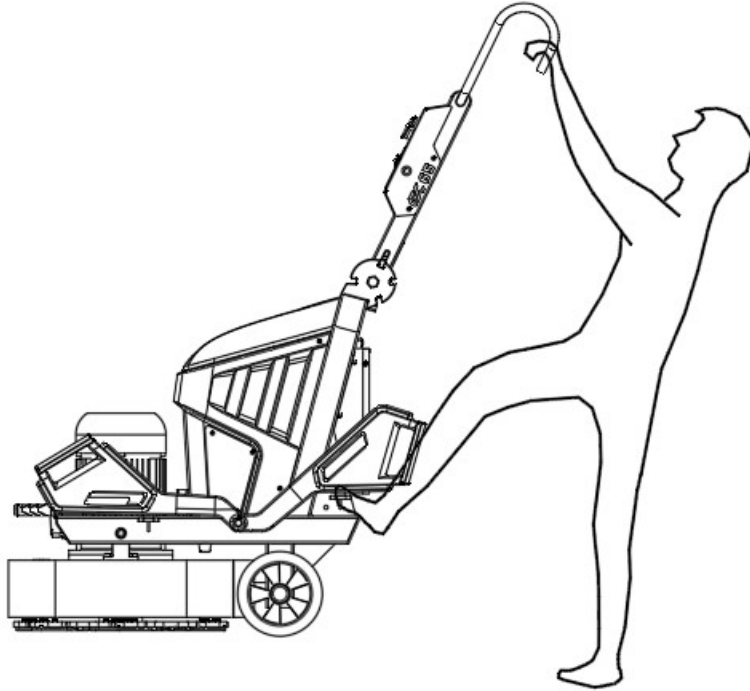

To put the machine down, you need to hold the handles tightly with both hands. Place feet on the handle of the extra weight iron lifter, balance the machine with your own gravity, and slowly lower it to protect the grinding head. When you put down the machine, pay attention to your own strength, and do your best to ensure the safety of the machine and the person. XINGYI company does not assume any responsibility for machine damage and personal injury caused by improper operation.

Note:

After lifting up the machine, remember to stand next to the grinding head, slightly press the grinding head to see if the machine is stable for personal safety.

4.2.5 Precautions

- 1、 If there is a operation inadvertently, the machine will be overturned, resulting in equipment damage and personal injury.

2、 At the adjustment process, we must make sure the lock device reset, before the operation of the machine.

3、 when the machine is located at the transport or packaging position, there is the risk of extrusion, be sure to be careful.

4、 At the grinding process, the dust inhalation is harmful, please bring a professional masks in operation to ensure personal safety.

5、 At the process of upward and laying down, must pay the attention to own safety, and avoid damage to the machine.

4.3 Start and stop the grinder

1. Start the grinder

(1) Put the grinder where you want to start the grinding work, and check whether the grinding pads is properly installed.

(2) Adjust the swing rod and additional weight iron to the corresponding working position. (After adjustment, as shown in the figure below).

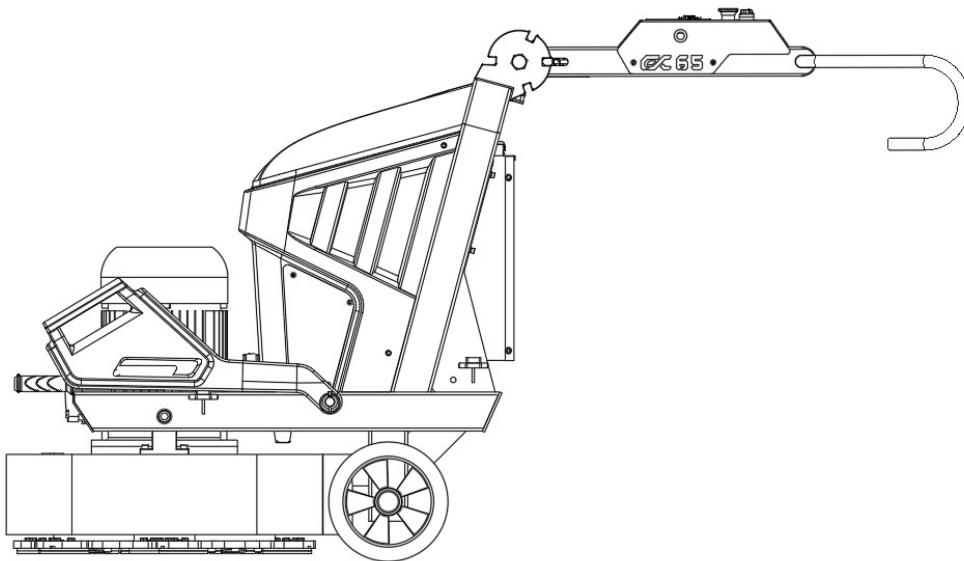

(3) Connect the grinder to the power supply. Use a cable suitable for the grinder (see technical data for minimum cable area).

(4) Start the grinder: rotate according to the rotation direction on the emergency stop switch, and press the start switch. Rotate the governor to adjust the rotational speed of the motor.

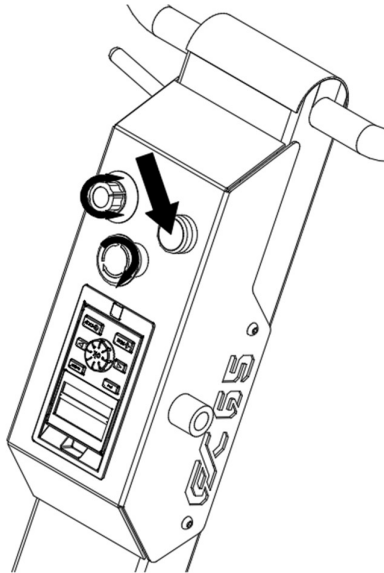

2. Stop the grinder

Press the emergency stop switch to stop the equipment (remember to reset the motor forward and reverse switch and unplug the power plug).

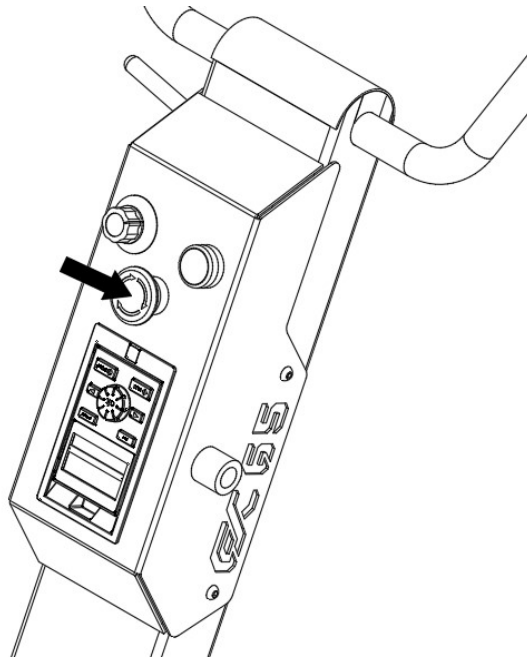

Notes:

When stopping the machine, it is recommended to unplug the power supply for safety reasons.

Please note that the emergency stop switch can only be pressed or rotated. Prohibit upward pull.

When starting the machine, it is recommended to press the handle to make the machine slightly raise and tilt back, reduce the pressure on the grinding disc, and reduce the friction between the grinding disc and the ground, so that the motor will not be overloaded when starting the machine.

4.4 Replace abrasives

When changing the grinding pad, adjust machine to lifting position, then tilt the machine carefully and lay it flat. After laying the machine, stand next to the machine and check whether the machine is stable. Change the grinding pads by a flat-blade screwdriver or scraper knife .

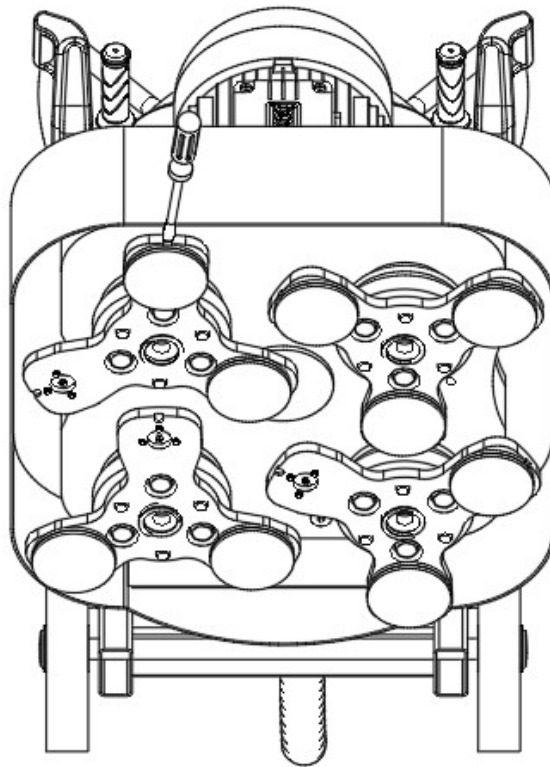

Notice:

Please make sure that the equipment does not tilt forward before changing the abrasive;

When the equipment is running for a period of time, the abrasives, grinding discs, and gearboxes will generate high temperatures. Please pay attention when changing abrasives to avoid scalding.

Make sure to replace the grinding disc after the power is unplugged and the emergency stop is pressed.

4.5 Method of machine wire winding

During machine working , the wire winding method is particularly important, to greatly improve your work efficiency and improve your safety. The specific operation is as follows:

1. Plug in an external power supply;
2. The power cord wrapped around the handle at least two laps;
3. Pull the power cord to ensure that the power cord slightly has enough friction so that the power cord firmly fixed on the handle.

Note:

1. Make sure the power plug and socket are securely connected;
2. Please make sure the emergency stop has been pressed before plug the power supply, and the other switch has been reset;
3. Please use the power cord according to the minimum specification of the wire ;
4. Please use the correct power supply.

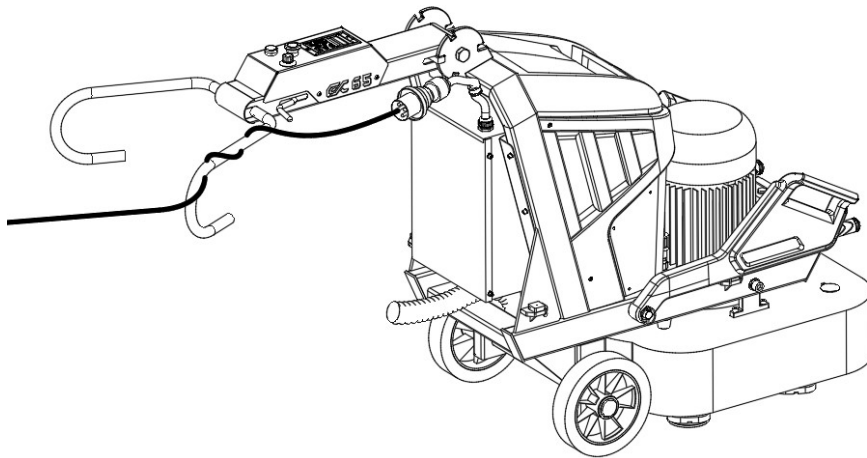

4.6 Grinding route (for reference)

When grinding the ground, it should be in accordance with the # method to grind the ground to get better effect. And according to # to grind ground, the machine grinding direction makes the wire more and more farther away, so that you can further avoid the interference of the wire to the normal work of the grinding machine.

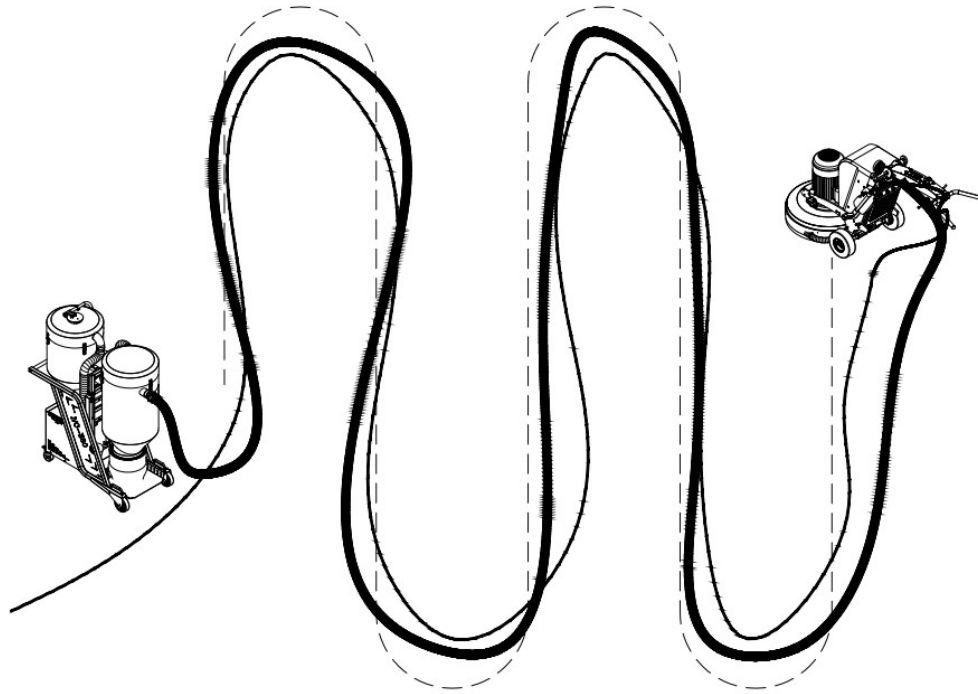

5. Maintenance Items

5.1 Overview

We recommend that the grinding machine be checked regularly to extend the service life.

Note:

During the maintenance and repair process, the power of the grinder must be disconnected.

Wear protective outfit such as safety shoes, protective gloves, protective masks, etc.

5.2 Daily check

5.2.1 Check the switches

The emergency stop switch should be rotated along the rotation direction on the switch. Click the start button to start the machine and see if the machine is started. (Safely and normally start the machine, the running light will light up, if not normally start, then there will be the error code showed on the display screen)

Turn on the grinder and press the emergency stop switch to see if the machine stops.

Note:

For safety reasons, it is strongly recommended to press the emergency stop switch when stopping the device, which would be safer.

When starting the machine, it is recommended to press the handle to lift the machine slightly, reduce the pressure of the grinding disc, and reduce the friction between the grinding disc and the ground, so as to avoid motor overloading when starting the machine.

5.2.2 Check the disc cover

When there is a large amount of dust, it is easy to cause dust blockage on the suction pipe of the disc cover, check if there is dust clogged by flashlight and clean up if necessary.

5.2.3 Check the disc

In the case of long hours of work or a lot of dust, the conversion block of grinding head may be stained with dust. It will lead lack of connection between grinding head and plate,

which will affect grinding efficiency even lead to abrasive drop and cause accident. In view of this situation, please remember to clean up in time.

5.2.4 Note

Be sure to wear protective outfit for maintenance checking such as protective gloves, protective masks, insulated shoes, etc.

The maintenance operation must be done when the emergency stop pressed and the power unplugged.

When the machine is tilted, make sure that the machine is flat and then check the operation of the grinding disc.

5.3 Cleaning

5.3.1 Clean switch

Grinding machine works on site for a long time, and the switch will inevitably be stained by dust. Therefore, please check switch after grinding, to see whether the part is clogged by dust. Otherwise, it may cause the switch failure.

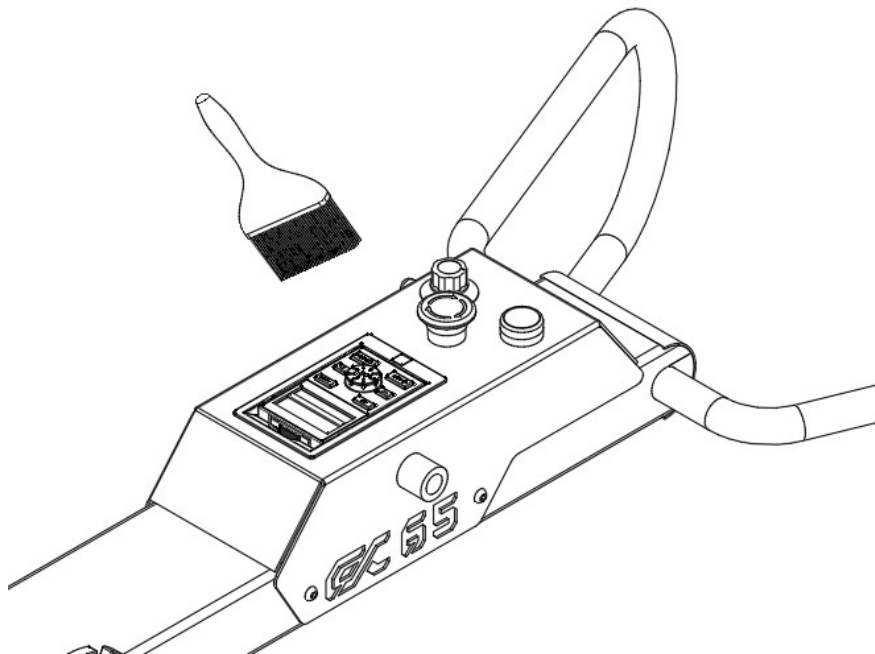

5.3.2 Clean the grinding disc cover

Remove the vacuum house connection, illuminate the dust nozzle with a flashlight, clean the dust nozzle with brush. So that it will not clog the dust nozzle and affect dust collection efficiency.

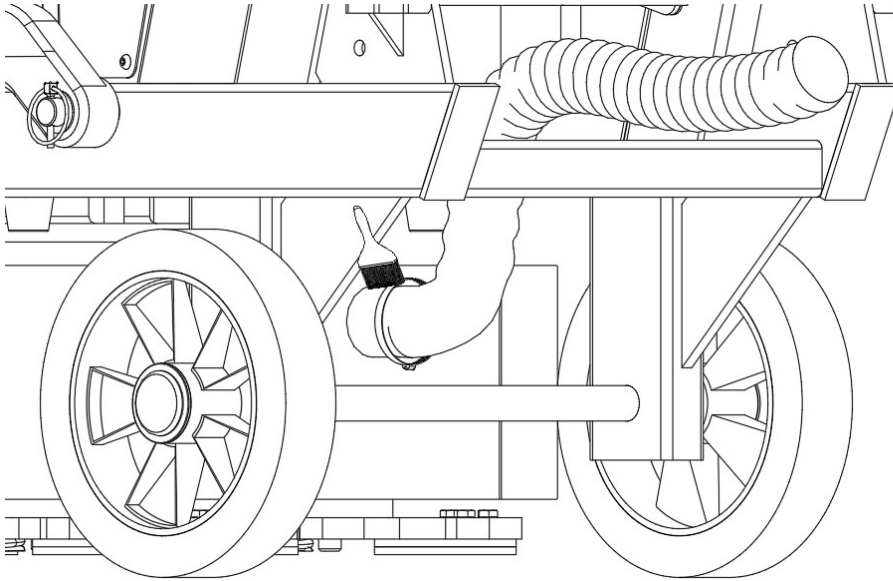

5.3.3 Clean up the grinding disc and conversion block

Tilt the machine and use a cross screwdriver to remove the pads, and use shovel to remove dust. If you do not clean up in time, it may make the pads disconnected, and pads fly out when grinding, which will cause damage to the machine and threaten personal safety.

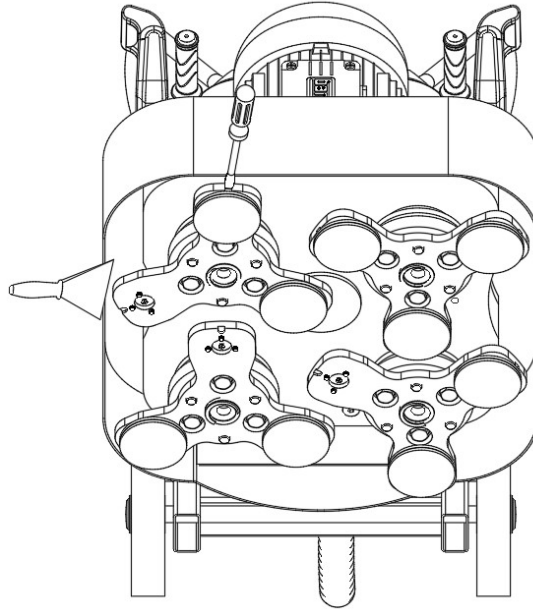

5.3.4 Note

1. Be sure to disconnect the plug from the socket before cleaning, maintenance or assembly.
2. Be sure to clean the whole grinder after each day's working. Do not use a high pressure washer to clean the machine directly.
3. In order to cool the equipment effectively, the cooling air port must be kept clear and clean.

5.4 Overload protection

The machine is equipped with an overload protection function on the inverter. When the machine is overloaded, the overload error will be showed on the display of the control panel. In this case, just disconnect the power plug and then reconnect it.

5.5 Maintenance

Any repairs must be performed by Xingyi Service Center trained service person and use original Xingyi accessories. If your machine needs repair, please contact with your retailer.

6. Frequently asked Questions and Solutions

This chapter describes some of the possible failures and how to handle them. If you still can not resolve and have an error, please contact your nearest retailer.

Problem	Possible reason	Solution
The machine can't run.	Emergency stop switch is pressed	Turn on the emergency stop switch
	Overload	Unplug the power cord and plug it in again.
	Power and power cable damage	Contact a licensed electrician
	There is a problem with the rear contact switch button	Make sure the wires are properly connected to the back button, check the contacts and the ignition button
The machine stops after starting	Overload	Unplug the power plug directly and plug it in again
The machine is difficult to hold or the motor current consumption is large	There are not enough diamonds pads under the device or using wrong diamonds	Use the number of diamonds recommended to reduce workforce on the grinder and operator
Machine leaping	Diamond pads may not be properly installed or heights are different	Properly install diamonds with the same height
	Uneven chassis	Adjust and install the chassis

7. Technical Data

The table and picture show the technical data and dimensions of the grinder.

	GX65	
Engine power	9.5KW/13HP	
Rated voltage	3P220V	3P380V
Rated current	34A	19.2A
Input hertz	50HZ/60HZ	
Inverter power	11KW/15HP	
Working width	638mm/25.12in	
Diameter of grinding disk	Φ348mm/Φ13.7in	
Grinding speed	350 ~ 1680 r/min	
Grinding and pressing (additional weight iron working position)	224kg	
Grinding and pressing (additional weight iron tilting position)	172kg	
Dimension(tilting position)L*W*H	1591×650×1831mm/62.64×25.59×72.09in	
Dimension(working position)L*W*H	1980×650×1135mm/77.95×25.59×46.74in	
Dimension(packing position)L*W*H	1118×650×1235mm/44.02×25.59×48.62in	
Max.Length*width*height	1980×650×1831mm/77.95×25.59×72.09in	
Total weight	305kg	
Cable model	6mm ²	
Storage temperature	- 20 ~ +60° C / - 4 ~ +140° F	
Working temperature	- 10 ~ +40° C / +14 ~ +104° F	
Humidity	95%以下(无冷凝)	

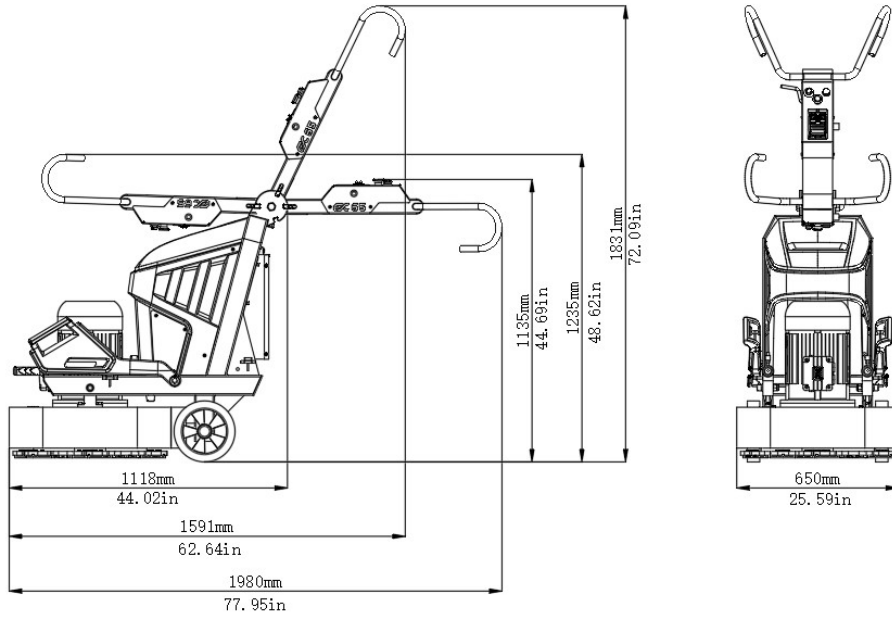

8. Warranty

Warranty Regulations

Xingyi does not bear the cost of machine damage caused by improper transportation, unpacking and improper use. Local distributors may be subject to specific warranty terms, please contact with your local distributor for specific warranty terms.