

Tank 1500 Floor Grinder Manual



Contents

1. Introduction

- 1.1 Summary
- 1.2 Responsibility
- 1.3 Spare part
- 1.4 Receiving
- 1.5 Equipment nameplate
- 1.6 Processing and storage
- 1.7 Guarantee

2. Safety Guidance

- 2.1 Summary
- 2.2 Operation safety guidance
- 2.3 Electrical safety guidance

3. Equipment

- 3.1 Summary
- 3.2 Description of parts
- 3.3 Control box assembly
 - 3.3.1 Summary
 - 3.3.2 Direction control stick
 - 3.3.3 USB interface
 - 3.3.4 Gearbox angle adjustment
 - 3.3.5 Water tank
- 3.4 Automatic dust collection system
 - 3.4.1 Description of electric control panel
 - 3.4.2 Cyclone separation drum
 - 3.4.3 Cartridge barrel
 - 3.4.4 Lifting device
 - 3.4.5 Quick connector
- 3.5 Remote-control - control panel
 - 3.5.1 Control description - control panel
- 3.6 Remote-control device box
 - 3.6.1 General
 - 3.6.2 Use of remote controller
 - 3.6.3 Use of remote-control charger
- 3.7 Clutch

4. Operation of Equipment (Driving mode operation)

- 4.1 General
- 4.2 Quick disassembly and assembly
 - 4.2.1 Quick disassembly of gearbox
 - 4.2.2 Quick disassembly of vacuum cleaner
 - 4.2.3 Quick disassembly of wire support rod
- 4.3 Equipment location description

Tank-1500 Grinder Manual

- 4.3.1 Equipment working position
- 4.3.2 Equipment packaging and transportation location
- 4.4 Starting and stopping the grinder
 - 4.4.1 Start the grinder
 - 4.4.2 Stop the grinder
- 4.5 Replacement of grinding disc
- 4.6 Winding method of equipment working wire
- 4.7 Start and stop the vacuum cleaner
- 4.8 Dust cleaning device
- 4.9 Dust collection device
- 4.10 Best grinding route

5. Equipment Operation (Remote operation)

- 5.1 General
- 5.2 Equipment location description
- 5.3 Starting and stopping the grinder
- 5.4 Replacement of grinding disc
- 5.5 Best grinding route
- 5.6 Precautions

6. Equipment Maintenance

- 6.1 Overview
- 6.2 Daily inspection
 - 6.2.1 Check the switch
 - 6.2.3 Inspection of grinding disc
 - 6.2.4 Long term storage of battery
 - 6.2.5 Be careful
- 6.3 Cleaning
 - 6.3.1 Cleaning switch
 - 6.3.2 Clean the grinding disc cover
 - 6.3.3 Clean the grinding disc conversion block
 - 6.3.4 Clean the filter element
 - 6.3.5 Notes
- 6.4 Overload protection
- 6.5 Maintenance

7. Common Problems and Solutions

- 7.1 Overview
- 7.2 Common problems and solutions of grinder
- 7.3 Common problems and solutions of vacuum cleaner

8. Technical Data

9. Warranty

Tank-1500 Grinder Manual

1.Introduction

1.1 Summary.

Xingyi's equipment is used to treat the floor surface. The scope of use of the equipment depends on the choice of tools. In addition to the use and general functions, this manual introduces the use, repair and maintenance of the grinder. For further information, contact your local retailer.

1.2 Responsibility.

We make every effort to make this manual as complete and accurate as possible, and we are not responsible for any error or loss of information. Xingyi reserves the right to change the instructions in this manual without prior notice.

This manual is protected by copyright law. No part of this manual may be copied or used without the written consent of Xingyi.

1.3 Spare parts.

The product mainly includes the following spare parts. If anything is lost, please contact the retailer.

- (1) One grinder
- (2) One copy of instructions
- (3) 24 conversion blocks
- (4) One power plug
- (5) One dust belt
- (6) Quick connector
- (7) Two volumes of dust bags
- (8) Two bags of nylon ties
- (9) Two lifting straps and accessories

Tank-1500 Grinder Manual

1.4 Receiving.

Carefully check the packaging and equipment for transport damage. If there are any signs of damage to the equipment, please contact the retailer and report the damage. If the package is damaged, report the damage to the transportation company.

Check whether the delivery meets the order. If you have any questions, please contact your retailer.

1.5 Equipment nameplate.

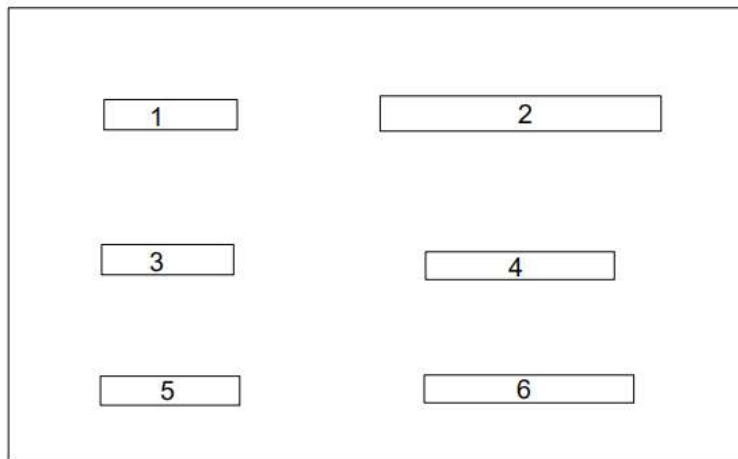

- | | |
|--------------------|----------------|
| 1. Model | 4. Voltage |
| 2. Production date | 5. Weight |
| 3. Power | 6. Revolutions |

1.6 Processing and storage.

The grinder shall be stored in a dry place at normal temperature when not in use. otherwise, it may be damaged by condensation and cold. The size and weight of the grinder are given in the technical data.

Be careful! If you operate carelessly, the grinder may overturn, causing personal injury and equipment damage.

Tank-1500 Grinder Manual

1.7 Guarantee.

This warranty covers manufacturing defects only. Xingyi will not bear any damage occurred during transportation, unpacking or use. In no case shall the manufacturer be liable for damage and defects caused by improper use, corrosion or use beyond the specified specifications. Under no circumstances shall the manufacturer be liable for consequential damages or costs. For complete information about the manufacturer's warranty period, please refer to the current warranty terms of Xingyi. Local dealers may have special warranty provisions. If you have any uncertainty about the warranty terms, please contact your retailer.

2. Safety Guidance

2.1 Summary.

This manual lists the important information of using this equipment and safe operation! Read this manual carefully before operating the equipment for the first time!

Any non-standard operation or unauthorized modification and maintenance of the equipment may cause the equipment to fail to work normally or other losses and may be dangerous. All work must be completed by qualified professional personnel, and any parts of the replaced equipment must be provided by Xingyi.

Xingyi equipment can only be used in the way recommended by Xingyi.

Xingyi equipment can only be used for commercial purposes.

Anyone using the equipment should know its function, emergency stop position, safety rules that operators should ensure, and unauthorized persons cannot be stationed in the work area when the equipment is started.

When working, professional personal protective equipment should be equipped: safety goggles, protective gloves, safety shoes, respiratory mask, protective earmuffs, etc. do not wear loose clothes or anything that can be grasped, such as scarves, bracelets, rings, etc.

Tank-1500 Grinder Manual

Cautions & Attentions:

1. It is strictly prohibited to operate when the power is less than 20%, especially on slopes, so as to avoid personal injury.
2. When driving on a ramp, check that the battery power is greater than 40%, confirm that the clutch is locked, and the AC input voltage shall not be less than 480V.
3. The machine must be operated at a place with a gradient of less than 25 °. If the gradient is greater than 25 °, the company will not bear any responsibility for the accidents caused by the operation.
4. This machine is only used for ground surface grinding and polishing.
5. Read and understand the safety instructions in the equipment manual. Different models have different accessories and control operations.
6. Only one person is needed to operate this machine when the equipment is working, pay attention to children or irrelevant personnel approaching the equipment, maintain a certain working distance.
7. Untrained and physically ill persons are prohibited from operating the equipment.
8. Do not rent the equipment without the equipment operation manual.
9. Clothing required for operation and use of equipment, such as dust mask, protective gloves, work clothes, safety helmet, insulating shoes, etc.
10. body, hand ornaments and spacious clothes should avoid the moving parts of the equipment, otherwise it may cause physical injury.
11. Do not change the equipment at will. Only the accessories provided by Xingyi company can be used for maintenance and modification.
12. Do not use the equipment in case of rain or dense fog.
13. Do not start the machine when the operator has not installed the dust bag.
14. During equipment operation, there shall be no explosive and flammable materials and steam nearby. Do not operate this equipment near dust, solvents, diluents or other flammables.

Tank-1500 Grinder Manual

2.2 Operation safety guidelines.

1. When driving on a ramp, check that the battery power is greater than 40%, make sure that the clutch is locked, and the AC input voltage shall not be less than 480V.
2. The operator shall wear protective equipment when using the equipment, such as dust mask, protective gloves, work clothes, safety helmet, insulating shoes, etc.
3. The equipment shall be checked before operation, and the equipment shall be free of electric leakage, water leakage, etc. Confirm that the equipment can be used normally.
4. Before operation, check the integrity of the equipment to ensure that the equipment operation control and electrical parts are free of moisture, and the operation control switch knob is intact.
5. Ensure that there are no obstacles or people in the working area and that there are sufficient lighting equipment in the working area.
6. For the safety of the operator and others, the dust shroud must be in place at all times, and the vacuum cleaner must be turned on during dry grinding.
7. Connect the equipment to a suitable power outlet. Only use the power cord that can withstand required current.
8. Do not make any action to adjust the angle of the gearbox during the operation of the equipment. Adjustments can only be made after the equipment is stopped and the emergency stop switch has been pressed.
9. The gear box of the equipment has different position locking functions. The functions of these positions are described with pictures in this manual.
10. When changing grinding discs or accessories, ensure that the whole machine has stopped running, confirm that the emergency stop button has been pressed, and disconnect the power supply or pull out the plug if necessary.
11. Keep the equipment away from the water outlet, furnace mouth or other dangerous goods, otherwise personal injury or equipment and property damage will be caused.
12. After rotating the emergency stop switch clockwise, rotate the forward and reverse switch to start the equipment.
13. Note that the emergency stop switch can only be pressed or rotated, and it is forbidden to pull it up.
14. Check the ground area to be ground before the equipment works and remove any hard objects such as bolts and nails that may cause damage to the grinding plate and equipment.
15. When the equipment is plugged into the power supply, make sure that the working voltage and frequency of the equipment are consistent with the input voltage and frequency, and make sure that the input power supply is free of phase loss. (if the input power supply is inconsistent with the normal working power supply of the equipment, resulting in equipment damage, no warranty will be given).

Tank-1500 Grinder Manual

16. Install a suitable dust suction pipe on the interface of the dust suction pipe to facilitate dust-free operation.

17. Install appropriate abrasives, improper Abrasives may cause personal injury.

18. After installing the abrasive, when the grinding disc is to contact the ground, the gearbox should be adjusted to the "warping position", and the operator can operate comfortably.

19. The "overload protection" of the equipment frequency converter indicates that there is a problem with the equipment (the power line specification is too small, or the voltage is unstable). At this time, please refer to the power line specification recommended below. (Other losses caused by continuous use of the equipment under overload will not be guaranteed).

20. After grinding for several minutes, stop the equipment to check the consumption of grinding discs. This can effectively save economic loss after using the wrong grinding discs.

21. Do not tilt up the equipment while the equipment is still running, otherwise the grinding disc flying disc will cause personal threat.

22. When the equipment is working, raise the filter barrel to the working position.

23. During the operation of the machine, do not do any action to adjust the height of the lifting support.

24. Observe the value on the pressure sensor after the equipment operates for a period. If the value (regardless of the symbol) is too large (about 2KPa), it indicates that the dust suction hose is blocked. Please swing the hose in time to dredge it.

25. After the equipment operates for a period, observe the dust amount of the dust collection bag and make corresponding treatment.

Tank-1500 Grinder Manual

2.3 Electricity safety guidelines.

1. All circuit maintenance can only be operated by professionals.
2. Note: after the equipment is stopped, the line is still energized. Cut off all power supplies before servicing the equipment.
3. The equipment is equipped with an overload protection device, which will automatically trip when the equipment is overloaded and prohibit the operation of the equipment (readjust the overload under safe conditions).
4. The manufacturer will not provide a warranty for other losses caused by continuous use of the equipment under overload and the equipment cannot work normally.
5. The purpose of adding frequency converter to the equipment is to speed regulation and protect the safety of users and equipment. It is forbidden to change and adjust the frequency converter and modify the frequency converter parameters without the consent of the manufacturer. If the device fails, only the accessories provided by the manufacturer can be used to replace the damaged accessories. (the manufacturer will not provide warranty for other losses and equipment failure due to modification and adjustment of frequency converter and modification of frequency converter parameters without the consent of the manufacturer.)
6. Never refit the internal parts or circuits of the frequency converter.
7. Do not operate the equipment when the distribution box is not closed.
8. If the equipment current is overloaded, special attention must be paid.
9. When the wire is live or loaded, do not connect, or remove the wire.
10. Using a damaged power cord may cause an electric shock. Do not use a damaged power cord.
11. Wires should be kept away from hot surfaces.
12. The dryness of all electrical equipment of the equipment shall be maintained, and the equipment shall be stored in a dry place.
13. After cutting off the power supply and before the panel indicator light goes out, it indicates that there is still high voltage inside the frequency converter, which is very dangerous. Do not touch the uninsulated electrical equipment.

Tank-1500 Grinder Manual

14. No water is allowed to enter the equipment motor and frequency conversion box (the manufacturer will not provide warranty for other losses caused by water inflow and the equipment cannot work normally).

15. The equipment must use the wire specification and voltage specification specified by the manufacturer (the power specification is indicated on the equipment brand).

3. Equipment

3.1 Summary.

Tank1500 is used to handle various types of floors. For grinding (rough grinding, grinding, polishing) concrete, natural stone and terrazzo floors, the corresponding abrasive or the abrasive recommended by Xingyi shall be used.

Tank1500 can use remote-control operation. The remote-control can control the movement of the machine at a certain distance, and the setting change and operation can be completed only through the buttons on the remote-control through the digital display screen on the remote-control device, the operator can easily adjust and monitor the system information. The machine can be controlled from the seat of the machine and through the buttons on the console. The buttons control the movement of the machine; through the digital display screen on the console, a new generation HMI system is configured with voice broadcasting function, so that the operator can easily adjust and monitor the system information; the machine is equipped with ground video monitoring technology, and the operations can be observed without getting off the machine.

Tank1500 gearbox uses super synchronous technology, with no gap in the middle, wider grinding width and higher efficiency; the gearbox can raise or lower the angle electrically, which saves time and labor when replacing the abrasives; the gearbox uses 3D suspension technology, and the grinding pressure will never change, making the floor more consistent; the gearbox uses fast decomposition technology, which makes the gearbox and machine can be decomposed quickly and convenient for machine handling.

Tank1500 adds the function of water tank, so that the equipment can be used not only for dry grinding, but also for water grinding. The advantages of water grinding include: the grinding ground has good adhesion, small cutting amount and easy light, which is suitable for later stone polishing. Users can choose water grinding or dry grinding according to their own needs; the change of grinding disc cover makes the floating mode of floating dust cover more smooth, and the grinding head area of working environment is blocked. The grinding disc cover is covered. Because it is floating, it is always in contact with the floor, which not only ensures that the operator does not contact the rotating mechanical parts, but also reduces

Tank-1500 Grinder Manual

the exposure of dust, and improves the dust absorption efficiency of the vacuum cleaner; the addition of water spraying system makes the water spraying more uniform and greatly improves the grinding efficiency.

Tank1500 is equipped with an automatic dust collection system. The automatic dust collection system is opened during dry grinding to prevent dust exposure to the air, which poses a threat to the health of operators, and nearby people. Because dust inhalation is harmful, even with a vacuum cleaner, you should wear a protective mask to ensure your health during operation.

The machine can use different grinding discs of Xingyi, and the grinding discs used in grinding are also different according to different ground materials.

Tank-1500 Grinder Manual

3.2 Description of parts.

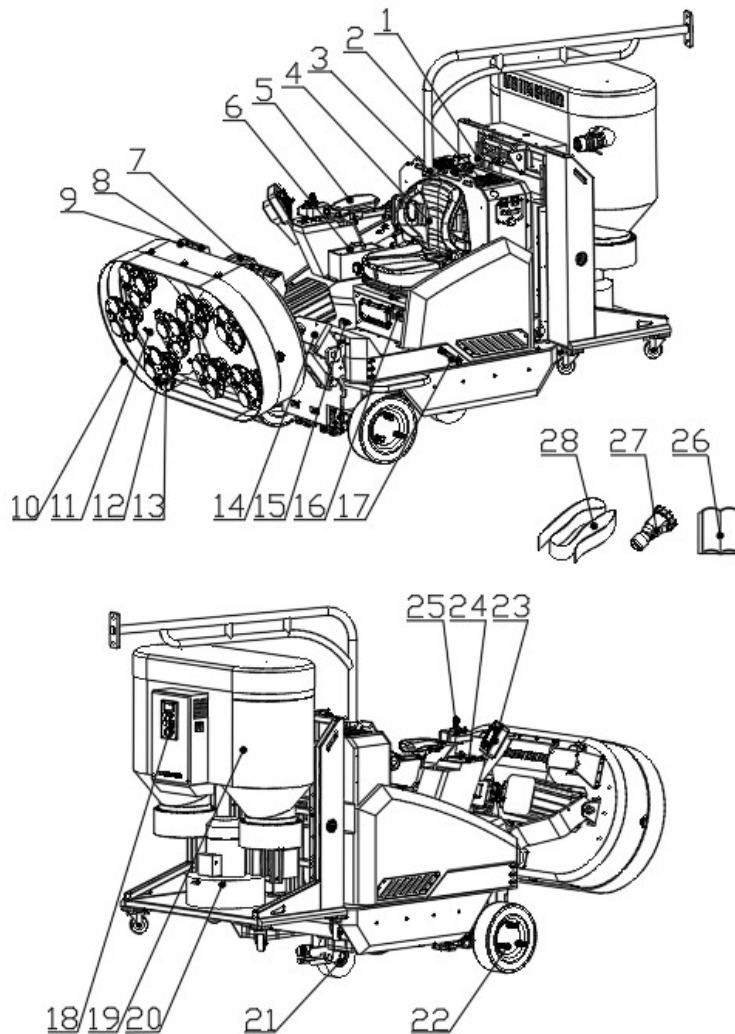

- | | |
|------------------------------------|------------------------------|
| 1.Vacuum bucket lifting guide rail | 15.Gearbox positioning limit |
| 2.Electric control panel | 16.Water tank pouring cover |
| 3.Wire support rod | 17.Water tank level gauge |
| 4.Chair | 18.Vacuum electric cabinet |
| 5.Handrail | 19.Vacuum bucket |
| 6.Hold-all | 20.Turbine fan |
| 7.Permanent magnet motor | 21.Damping caster |
| 8.LED light | 22.Drive wheel |
| 9.Spray head | 23.Display |
| 10.Gearbox cover | 24.Control box |
| 11.Gear box | 25.Armrest control box |
| 12.Millstone | 26.Instructions |
| 13.Conversion block | 27.The power plug |
| 14.Lifting arm | 28.Dust belt |

Tank-1500 Grinder Manual

3.3 Control box assembly

3.3.1summary

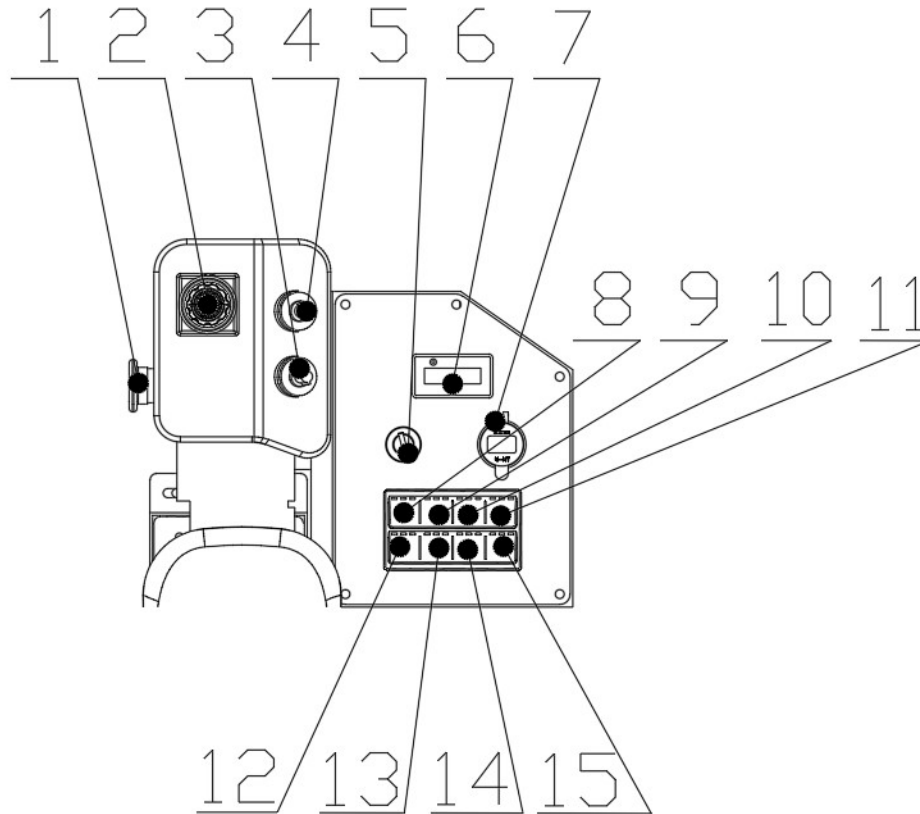

1. Emergency stop switch: when the equipment is in a dangerous state or needs to stop working, press the emergency stop switch to cut off the power supply and stop the operation of the equipment, so as to protect personal and equipment safety.

2. Direction control stick: controls the machine forward, backward, left and right.

3. Motor governor: adjust the rotation speed of grinding motor.

4. Traveling governor: adjust the traveling speed of the driving wheel.

5. Mode switching key: used to switch between remote control mode and car mode.

6. Power display: displays the remaining power of the machine.

7. USB interface: it can be used for charging, such as mobile phone charging.

8. Motor forward rotation button: controls the forward rotation of the machine motor.

9. Gearbox lowering button: controls gearbox lowering.

10. Gearbox lifting button: controls gearbox lifting.

Tank-1500 Grinder Manual

11.3D suspension button: intelligently adjust the height of gearbox and ground.

12.Motor reverse button: controls the machine motor to reverse.

13.Reset button: release the machine alarm.

14.Spray switch: control the opening and closing of the sprinkler head in the front of the mill cover.

15.LED light switch: the switch that controls the LED light.

3.3.2 Direction control stick.

The direction control stick is mainly used to control the movement of the machine forward, backward, left and right. It allows the user to get rid of the action of manually pulling or pushing the equipment, so as to make the machine forward, backward, left and right. It greatly simplifies the manpower and makes the user operation more comfortable and convenient.

The direction control stick mainly has five gears. The first is forward gear: push the direction control stick forward, and the equipment will walk forward according to the speed set on the speeder. The second is backward gear: push the direction control stick backward, and the equipment will walk backward according to the speed set on the speeder. The third is right gear: push it long to the right, and the equipment will turn right according to the speed set on the speeder Bend. After the steering is completed, the stick is reset, and the equipment will move according to the forward or backward command set in the previous step. The fourth is the left gear: push to the left, and the equipment will turn to the left according to the speed set on the speeder. The fifth is the brake gear: press once in the middle of the direction control stick, and the equipment will stop walking.

Tank-1500 Grinder Manual

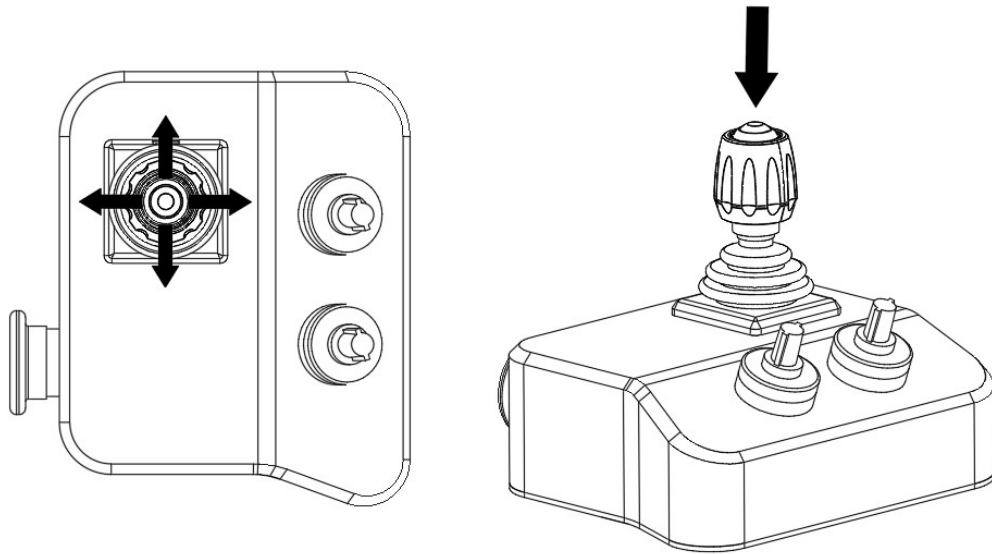

Be careful:

When reversing different gears, pay attention not to exert too much force, otherwise gear skipping may occur.

Tank-1500 Grinder Manual

3.3.3 USB interface.

There is a display screen on the control panel, which is convenient for users to understand the current time. Turn the display screen up, and we can see the USB interface, which is convenient for users to charge their mobile phones and other devices.

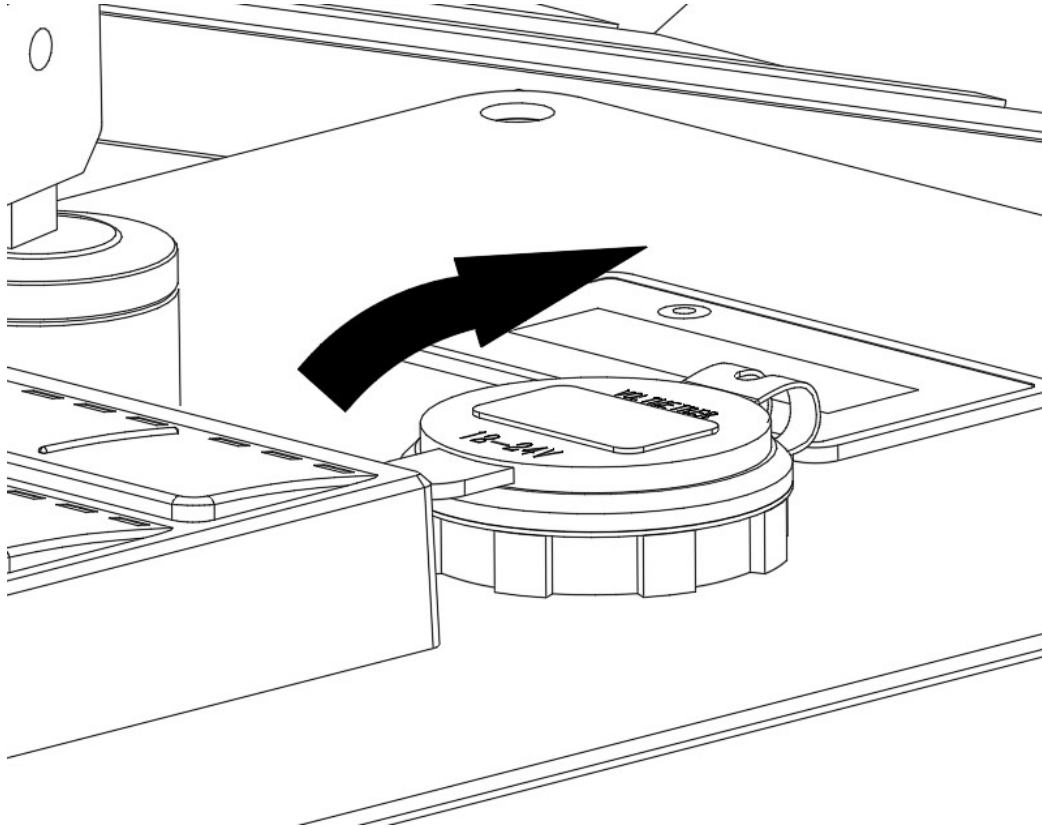

Be careful:

When not charging, be sure to cover the cover and do not expose the USB to prevent dust from running in, blocking or damaging the USB interface.

3.3.4 Gearbox angle adjustment.

The gearbox angle adjusting device controls different positions of the gearbox by controlling the angle of the lifting arm to adapt to the change of equipment placement mode in different states (different equipment states are as follows) When the gearbox needs to be lifted to the warping position, step on the positioning limit of the gearbox with one foot, press and hold the lifting button of the gearbox without moving. When the gearbox needs to be lifted to the warping position, release the lifting button of the gearbox, and then

Tank-1500 Grinder Manual

release the positioning limit of the gearbox. When the gearbox needs to be lowered to the working position, step on the positioning limit of the gearbox with one foot, press and hold the lowering button of the gearbox without moving, and wait to descend to the working position. When setting, release the gearbox lowering button, then release the gearbox positioning limit, and press the 3D suspension button to make the gearbox more close to the ground.

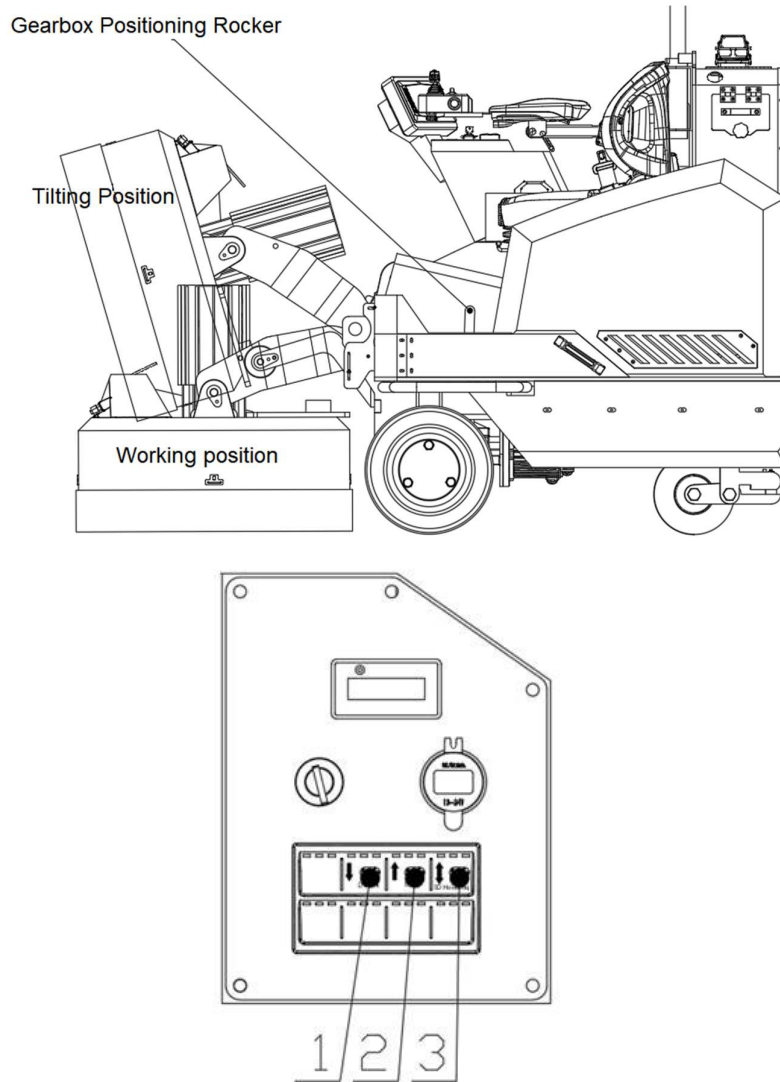

- ① Gearbox lowering button ② Gearbox lifting button ③ 3D suspension button

Be careful:

After adjusting the angle of the gearbox, check whether the positioning limit of the gearbox has been limited before operating the equipment.

Tank-1500 Grinder Manual

3.3.5 Water tank.

There is a water injecting port on the side of the water tank (the opening of the water injecting port is shown below). The tank can be filled with water. The water level of the tank can be observed through the water level gauge. When the water level of the water tank is confirmed to be safe, press the spray switch, the two spray heads work, and a large quantity of water mist is sprayed, so that the water can be grind.

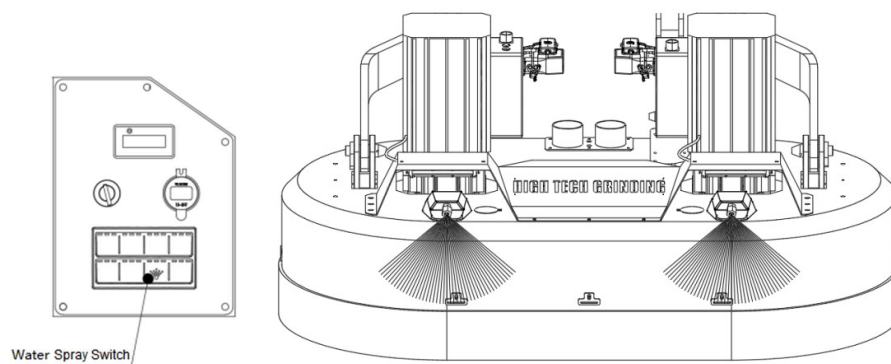
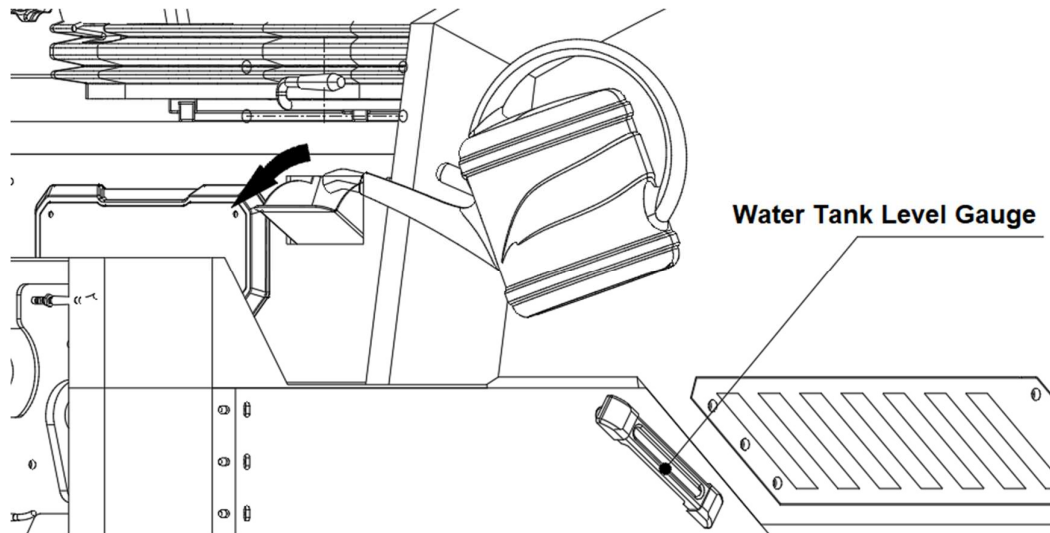

Tank-1500 Grinder Manual

3.4 Automatic dust collection system.

3.4.1 Description of electric control panel.

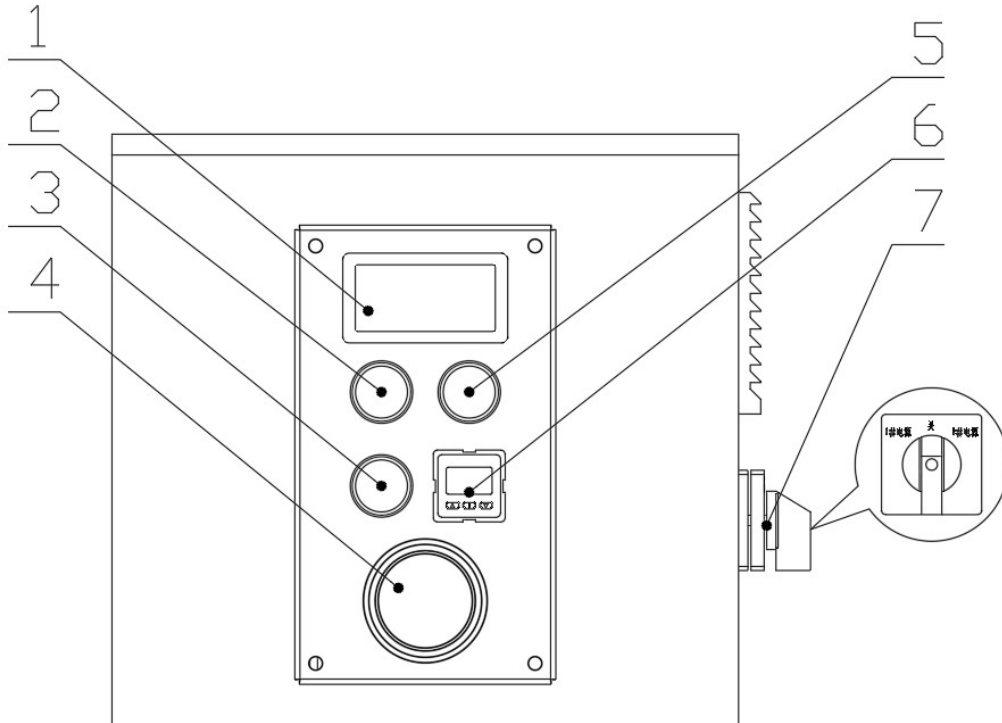

1. Digital display screen: the display screen displays the interval time of three ash cleaning devices under automatic ash cleaning mode. (0: three ash cleaning devices operate without interval cycle; 5: ash cleaning devices operate with interval of 5 minutes; 10: ash cleaning devices operate with interval of 10 minutes; 20: ash cleaning devices operate with interval of 20 minutes;)

2. Start stop button: control the start and stop of the equipment. (press the button once to start the equipment and then press the button again to stop the equipment)

3. Time adjustment button: click this button to switch the interval cycle time of ash cleaning device. (0, 5 minutes, 10 minutes, 20 minutes)

4. Timer: displays the accumulated running time of the device.

5. Ash cleaning button: press this button, and the ash cleaning device enters the manual ash cleaning mode for 15 seconds.

6. Pressure sensor: displays the current vacuum pressure in the filter barrel. When the value of the pressure gauge (regardless of the symbol) becomes larger and larger, it indicates that there is dust blockage in the dust suction hose or too much dust accumulation on the filter element. At this time, swing the dust suction hose to dredge the pipeline or jog the dust cleaning button for many times (jogging interval is more than 15 seconds)

7. Vacuum cleaner lifting knob: 1# power supply vacuum cleaner barrel rises upward as a whole, 2# power supply vacuum cleaner barrel drops downward as a whole, and rotates to the middle to stop the current movement.

3.4.2 Cyclone separation drum.

The cyclone separator is a cyclone type. Its principle is to separate large solid particles or droplets from the outer wall by the rotary movement caused by the introduction of air flow, which has high separation efficiency. The cyclone separation barrel is also equipped with a quick connector, which can be safely and quickly connected with the grinder for the function of dust collection, through centrifugal force.

Most of the dust is separated in the cyclone separator, and the separated dust mainly falls on the inner side of the lower part of the cyclone separation barrel. There is a locked rotating mechanism under the cyclone separation barrel, and a dust bag hanging barrel with a dust bag is sleeved under the barrel. When the dust in the barrel reaches a certain amount, due to the action of gravity, the locked rotating mechanism will unlock and the dust will fall inside the dust bag.

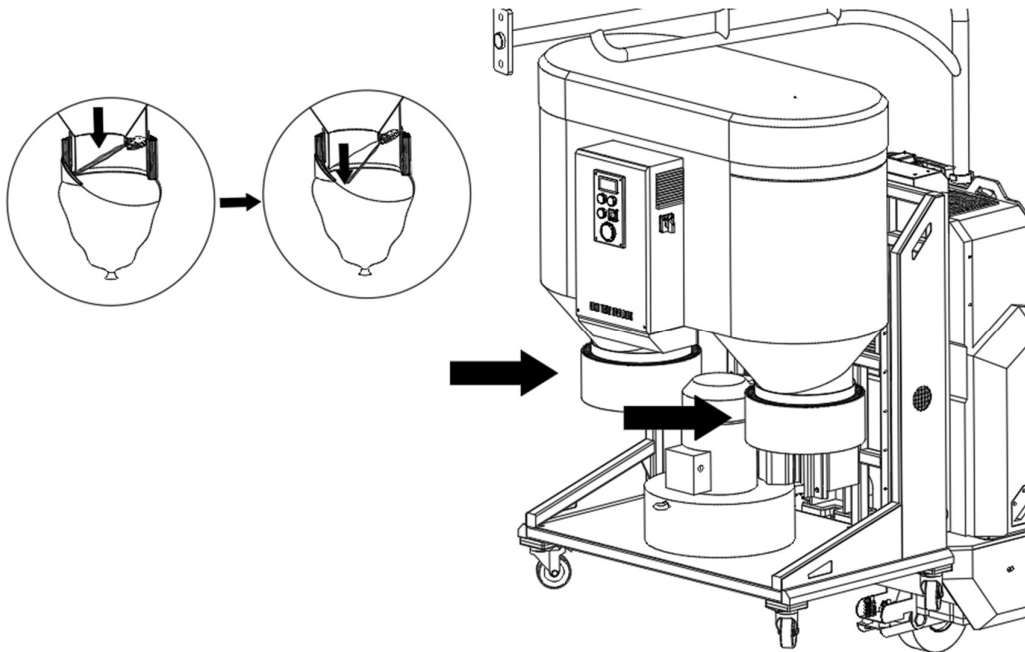

3.4.3 Cartridge barrel.

The filter cartridge is mainly composed of three filter cartridge devices. When the primary filtered air passes through the filter cartridge, due to the adsorption of the filter cartridge, the dust in the air will be adsorbed on the filter cartridge surface when passing through the filter cartridge device or fall on the dust collection equipment of the filter cartridge due to gravity.

Due to the adsorption of the filter element, too much dust will be collected, which will affect the filtration efficiency. Therefore, an ash cleaning device is installed on the filter barrel. The ash cleaning device can clean the dust collected on the filter element, so as to improve the filtration efficiency. There are two operation modes of the ash cleaning device, one is controlled by the set program, and the other is controlled by manually inching the time-adjusting ash cleaning button (see details later for specific operation.).

Tank-1500 Grinder Manual

3.4.4 Lifting device.

The height adjustment device of the vacuum cleaner controls the different height positions of the vacuum cleaner by controlling the height of the electric push rod to adapt to the conversion of the equipment working mode in different states (different equipment working states are as follows). When it is necessary to lift the vacuum cleaner to a special working position, rotate the vacuum cleaner lifting knob to the "1# power supply" position. The position does not move. When it is lifted to the special working position, rotate the vacuum cleaner lifting knob to the "off" position. When it is necessary to lower the vacuum cleaner to the normal working position, rotate the vacuum cleaner lifting knob to the "2# power" position. When it is lowered to the normal working position, rotate the vacuum cleaner lifting knob to the "off" position.

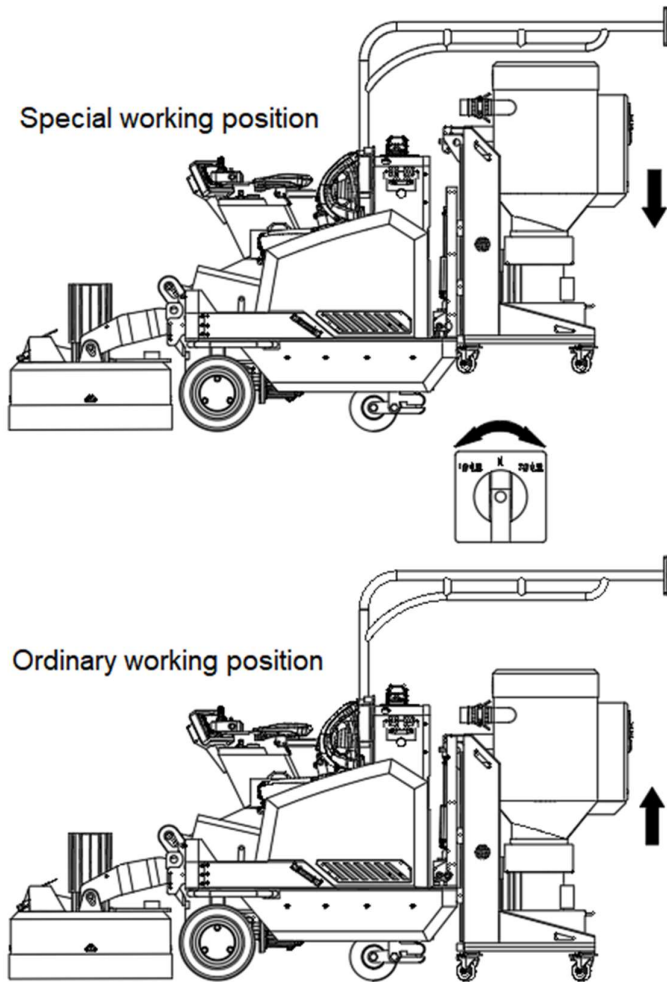

3.4.5 Quick connector

Tank-1500 Grinder Manual

The quick connector is composed of front and rear parts. The front part is usually assembled with the dust suction pipe orifice of the grinder (screw the front part into the dust suction pipe interface and tighten it), and the rear part is matched with the dust suction pipe (screw the copper wire dust suction pipe into the rear and tighten it). When it is necessary to connect the dust collector on the dry grinding ground, connect the rear part matched with the dust suction pipe with the front part (the rear part is screwed into the front part, and both sides of the front part are pulled forward for locking. The specific action is shown in the figure below).

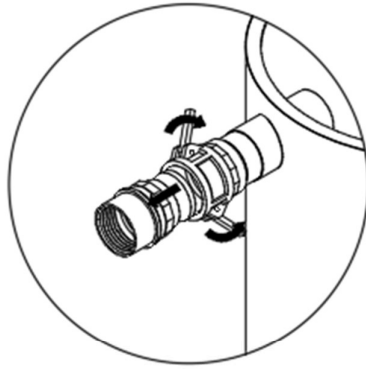

Loosen the two clamping buckles and take out the front part of the quick connector

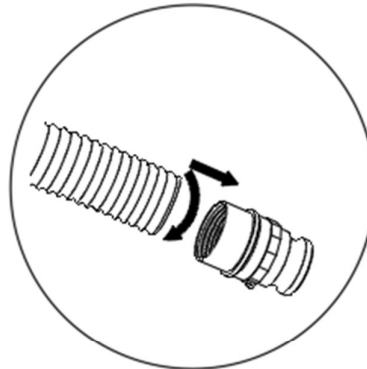

Screw the vacuum tube into the front to match the internal thread

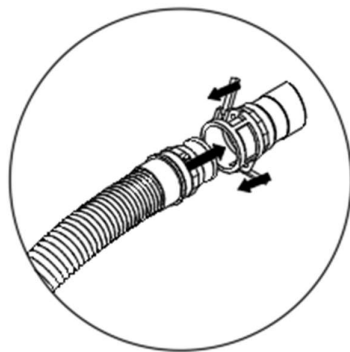

Match the locked front part with the rear part, and break the lock buckle forward to lock it

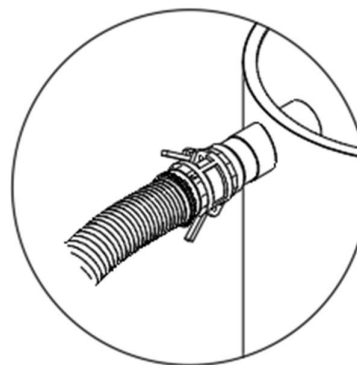

Final rendering

Tank-1500 Grinder Manual

3.5 Remote control - control panel.

3.5.1 Control description - control panel.

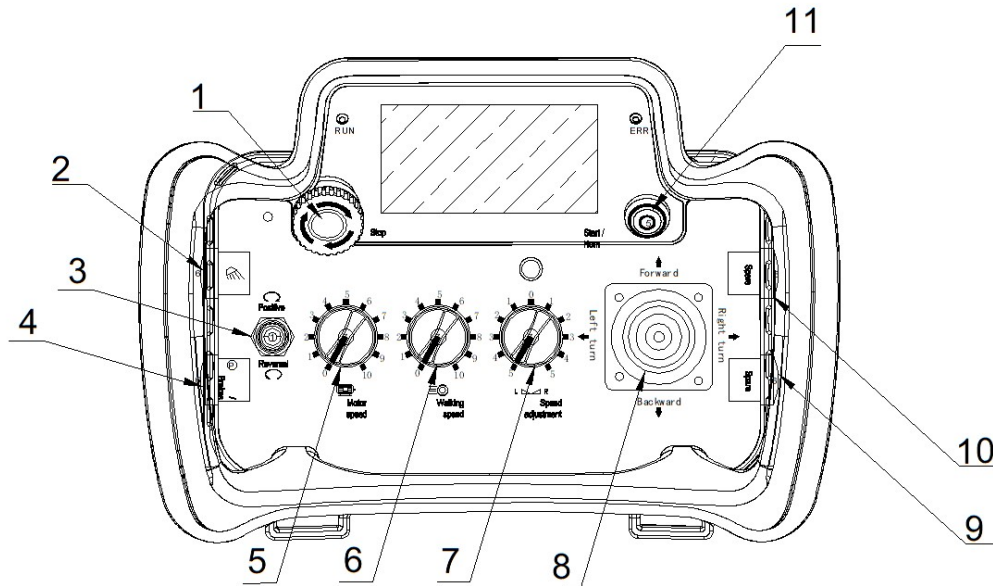

1. Emergency stop switch: turn on or interrupt the control of radio use to stop the equipment.

2. LED light switch: used to control the LED light switch on the grinder.

3. Motor forward and reverse rotation switch: the switch has three gears: pushing forward controls the forward rotation of the motor, the middle gear is that the motor does not rotate, and pushing back controls the reverse rotation of the motor.

4. Brake switch: the driving wheel brakes instantaneously.

5. Motor speed adjustment switch: controls the speed of the grinding disc drive motor.

6. Drive wheel speed regulating switch: controls the traveling speed of the equipment.

7. Left and right wheel speed adjustment switch: ensure that the equipment is grinded in a straight line. When the equipment deviates slightly from the straight line to the right (left), rotate the switch to the left, and the speed of the left wheel will be reduced, making the equipment deviate to the left (right) to maintain the straight line.

Tank-1500 Grinder Manual

8. Direction control stick: controls the equipment to move forward, backward, turn left and turn right.

① Push the direction stick forward slightly, and the equipment will travel at the speed set on the speeder.

② Push the direction stick back slightly, and the equipment will walk backward according to the speed set on the speeder.

③ Push to the right for a long time, and the equipment moves to the right according to the speed set on the speeder.

④ Push it to the left for a long time, and the equipment moves to the left according to the speed set on the speeder.

⑤ After the steering of the equipment is completed, the stick is reset, and the equipment will move according to the forward or backward command set in the previous step.

⑥ Equipment traveling speed: 0-20M / min.

9. Standby key.

10. Screen wake-up key and start key.

3.6 Remote control device box.

3.6.1 General.

Put the remote-control device flat, open the box, hold it with your hand, fix the cover of the box.

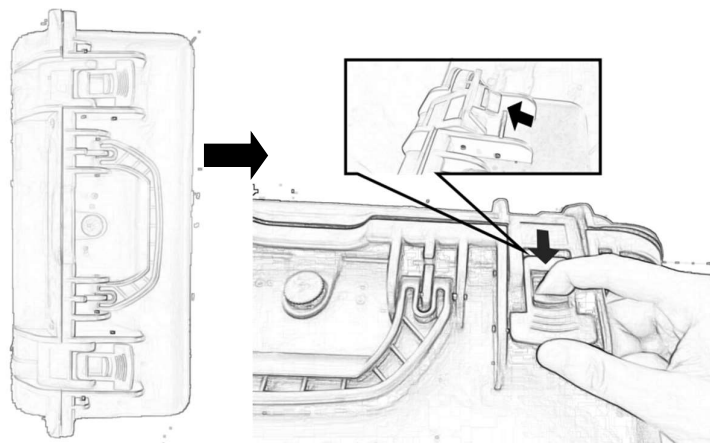

Tank-1500 Grinder Manual

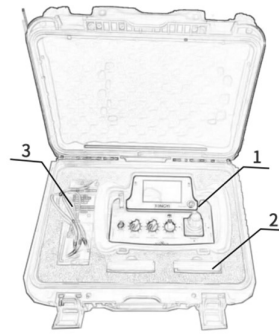

1. Remote control

2. Battery

3. Charger

Be careful:

When opening the remote-control box, be sure to place the cover of the remote control box stably before taking or placing the device.

Remember to wear protective gloves, insulating shoes and other protective tools during operation.

3.6.2 Use of remote controller.

Installation of remote-control battery: please check the battery power before installation to avoid failure of normal use due to insufficient battery voltage; Pay attention to the direction of the battery during installation and ensure the reliable installation of the battery; When the remote control is not used for a long time, remove the battery.

Location of remote control: the remote control should be placed in a safe and conspicuous place to avoid falling and damage.

Startup of the remote control: put the ohm battery pack with sufficient power into the battery box, pull out the emergency stop switch on the remote control, press and hold the "start" green light to keep on until the green light flashes once per second, and then start up normally.

Remote control shutdown: press the emergency stop switch of the remote control, the power indicator goes out, and the remote control is powered off.

Tank-1500 Grinder Manual

Power indicator: the green-light flashes every second, indicating that the remote control works normally; The red-light flashes once a second, accompanied by a buzzer sound, indicating that the battery voltage of the remote control is insufficient; If the traffic lights flash alternately, it indicates that the smart key is not recognized; If the traffic light is always on, it means that the high-frequency module is not recognized.

3.6.3 Use of remote-control charger.

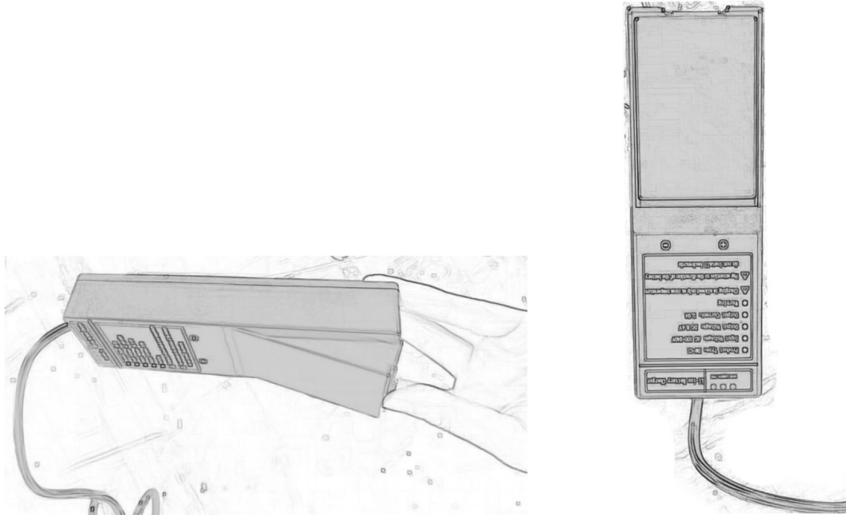

Input the correct voltage according to the mark on the charger. Put the rechargeable battery into the charger: the indicator light of the charger changes from green to red, indicating that the charging is normal; The indicator light of the charger changes from green constant light to red flashing, indicating that the battery is over charged and the charger is in trickle charging state. After trickle charging for a short time, the indicator light changes to red constant light and enters the normal charging state. If the rechargeable battery fails, replace the battery. After charging, the indicator light changes from red to green. Note: be sure to confirm the charger voltage. Make sure that the rechargeable battery is fully inserted into the charger. If charging is not completed for more than 4 hours, please confirm whether the charger or battery is in good condition.

Tank-1500 Grinder Manual

3.7 Clutch.

Clutch locking: move the clutch outward, and then rotate the clutch 90 degrees counterclockwise.

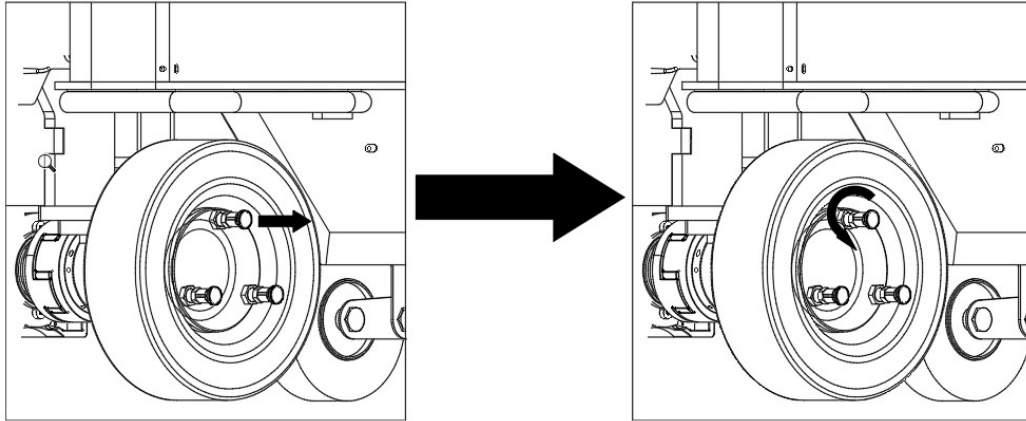

Clutch unlocking: move the clutch outward, and then rotate the equipment clockwise for 90 degrees.

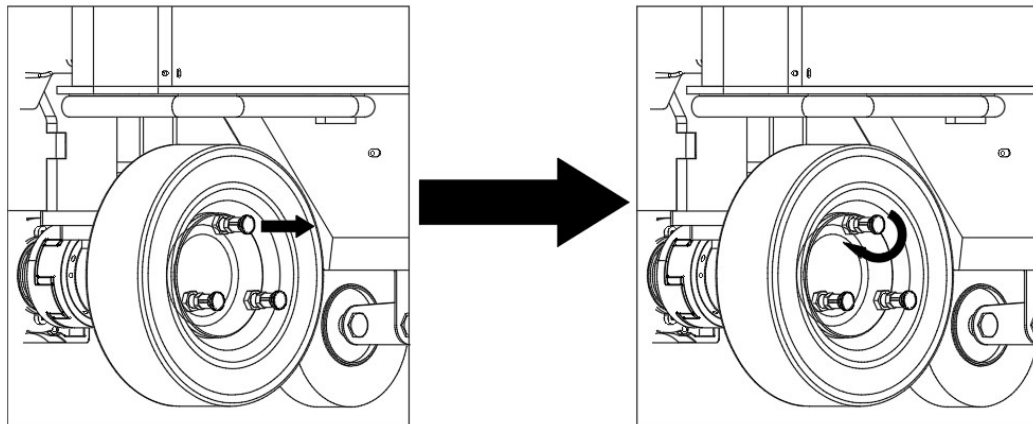

Be careful:

1. When pulling out the clutch pin, it may be blocked. Just pull out the clutch pin while shaking the equipment.
2. During grinding, the clutch pin shall be rotated to the corresponding position. If the clutch pin does not bounce back automatically, the clutch pin will bounce back automatically during the operation of the equipment wheel.

4. Operation of Equipment (Driving mode operation)

4.1 General.

The following sections mainly describe the grinder in different positions when switching the mode to manual operation, the main operation of the grinder and how to install the grinding disc.

Matters needing attention:

1. The grinder can only be used or repaired by personnel who have received necessary theoretical and practical training and have carefully read the user manual.
2. protective equipment shall be used when operating the grinder, such as protective gloves, protective mask, work clothes, safety helmet, insulating shoes, etc.

4.2 Quick disassembly and assembly.

4.2.1 Quick disassembly of gearbox.

When the gearbox is quickly disassembled,

- ① adjust the gearbox to the working position first (see the details later for specific operations);
- ② Pull out the annular pin upward and pull out the lifting arm pin shaft outward;
- ③ Loosen the hose clamp and pull out the dust suction pipe upward;
- ④ Open the snap of the power quick plug downward, pull out the power quick plug, rotate the aviation plug knob, pull out the aviation connector, and cover the dust cover of the quick plug;
- ⑤ The operation is the same on the left and right sides.

Tank-1500 Grinder Manual

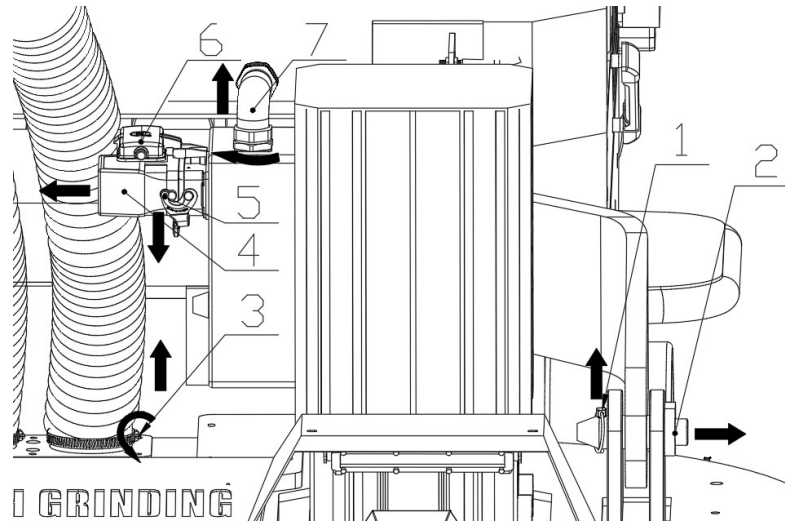

1. Ring pin
2. Lifting arm pin shaft
3. Throat clamp
4. Power quick plug
5. Quick plug buckle
6. Quick plug dust cover
7. Aviation plug

Be careful:

1. Sometimes the lifting arm shaft pin will be blocked. At this time, it is necessary to shake the lifting arm shaft pin and pull out the lifting arm shaft pin.
2. After the quick connector of the power motor is pulled out, the connector number shall be recorded and inserted into the original socket position during installation.
3. After the aviation plug is pulled out, the plug number shall be recorded and inserted into the original socket position during installation.

4.2.2 quick disassembly of vacuum cleaner.

When the vacuum cleaner is quickly disassembled,

- ① Adjust the vacuum cleaner to the normal working position first (see detailed instructions for specific operations);
- ② Pull out the annular pin inside the lifting guide rail pin shaft upward and pull out the lifting guide rail pin shaft outward. The operation on the left and right sides is the same;
- ③ Pull out the annular pin inside the lifting electric pin shaft upward, and pull out the electric push rod pin shaft outward. The operations on the left and right sides are the same;

Tank-1500 Grinder Manual

④ Open the snap of the power quick plug downward, pull out the power quick plug, and cover the dust cover of the quick plug;

⑤ Pull out the quick connector of the dust suction pipe (see the detailed operation).

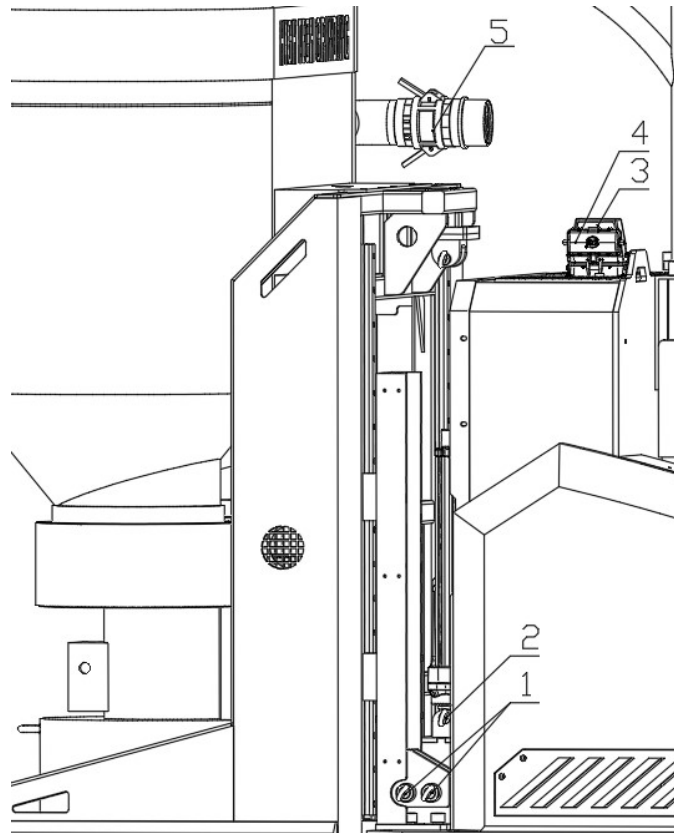

- 1. Lifting guide rail pin shaft
- 2. Electric push rod pin shaft
- 3. Power quick plug

- 4. Quick head dust cover
- 5. Quick connector

Tank-1500 Grinder Manual

4.2.3 Quick disassembly of wire support rod.

When the wire support rod is quickly removed, just pull the wire support rod up from the support rod fixing pipe on the frame.

Note: because the wire support rod is long, hold the rear end of the wire support rod with one hand when pulling out.

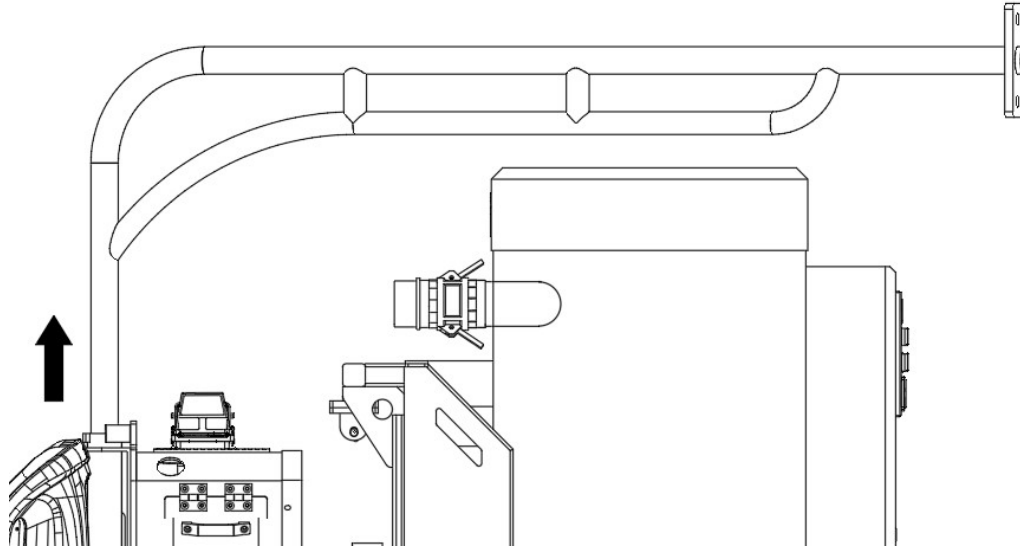

4.3 Equipment location description.

4.3.1 Equipment working position.

When the grinder is working, it is necessary to lower the gearbox to the working position, step on the gearbox positioning limit with one foot, press and hold the gearbox lowering button. When it is lowered to the working position, release the gearbox lowering button, then release the gearbox positioning limit, and press the 3D suspension button to make the gearbox closer to the ground to achieve the most appropriate working position.

When the grinder is working on steep slopes or uneven ground. To lift the vacuum cleaner to the special working position, rotate the vacuum cleaner lifting knob to the "1# power" position. When lifting to the special working position, rotate the vacuum cleaner lifting knob to the "off" position.

Tank-1500 Grinder Manual

Ordinary working position

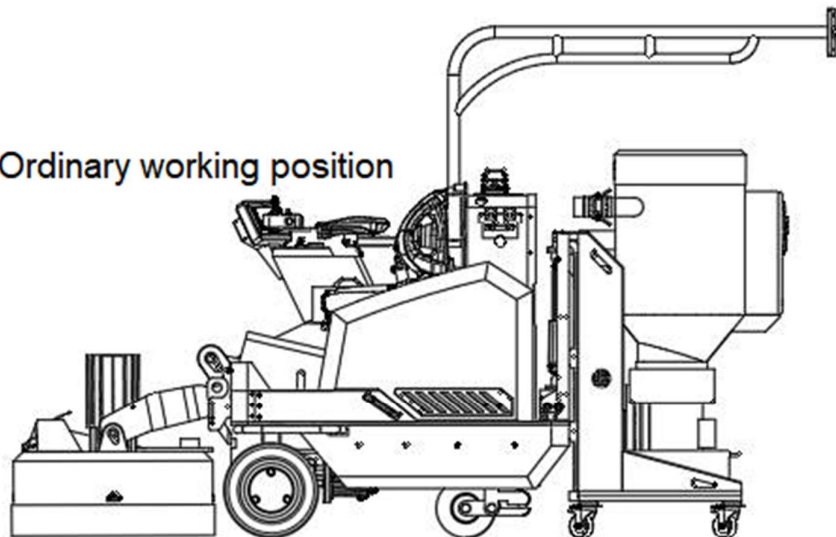

Special working position

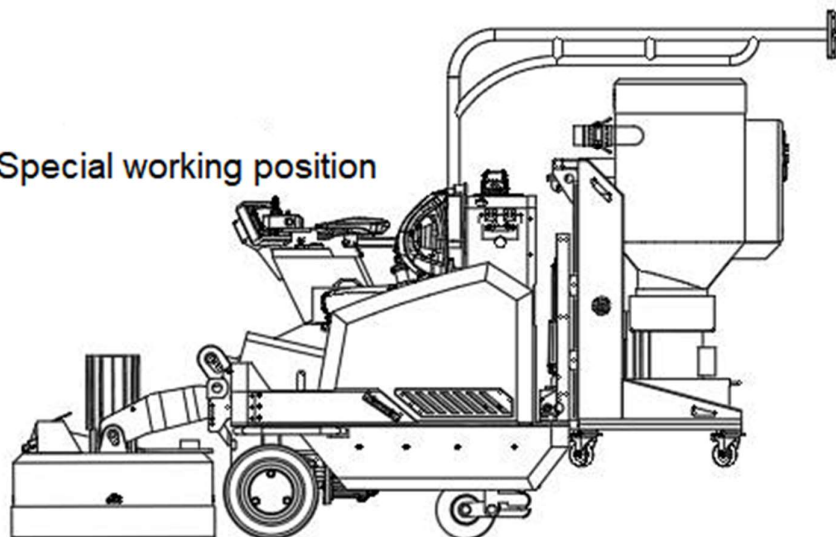

Tank-1500 Grinder Manual

4.3.2 Equipment packaging and transportation location.

In the process of equipment transportation, if the whole machine is not convenient for transportation, the whole machine can be disassembled quickly.

The whole machine can be disassembled into four parts, including gearbox components , frame components, vacuum cleaner components , and wire support rods .

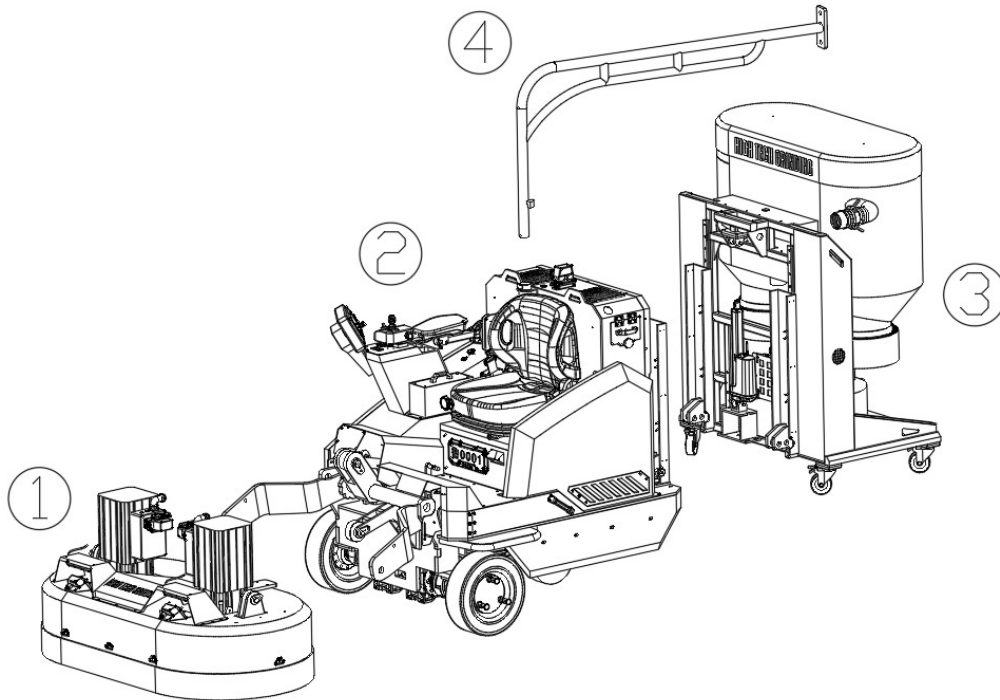

① Gearbox assembly

③ vacuum cleaner assembly

② frame assembly

④ wire support rod

Tank-1500 Grinder Manual

4.4 Starting and stopping the grinder.

4.4.1 Start the grinder.

(1) Plug in the power cord (before that, make sure that the emergency stop is pressed and all switches have been reset); If it is dry grinding, turn on the vacuum cleaner; Under the condition of water mill, the water tank shall be filled with water.

(2) Turn on the emergency stop switch.

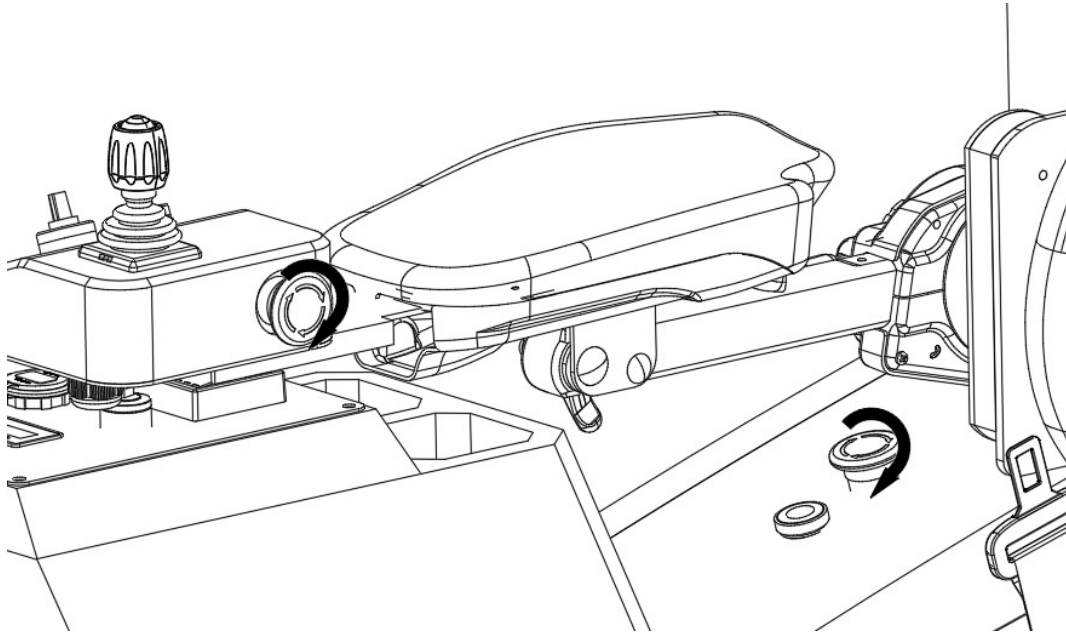

(3) Adjust the grinder to the corresponding working position (see Adding page number after typesetting for detailed operation).

(4) Press the motor forward rotation button to make the motor forward rotation (press the motor reverse button to make the motor reverse rotation). Rotate the motor governor to adjust the rotation speed of the motor, control the stick in the swing direction to control the forward, backward, left and right rotation of the machine, and rotate the speeder to adjust the travel speed of the driving wheel to start the equipment for grinding (for water grinding work, you need to turn on the spray switch).

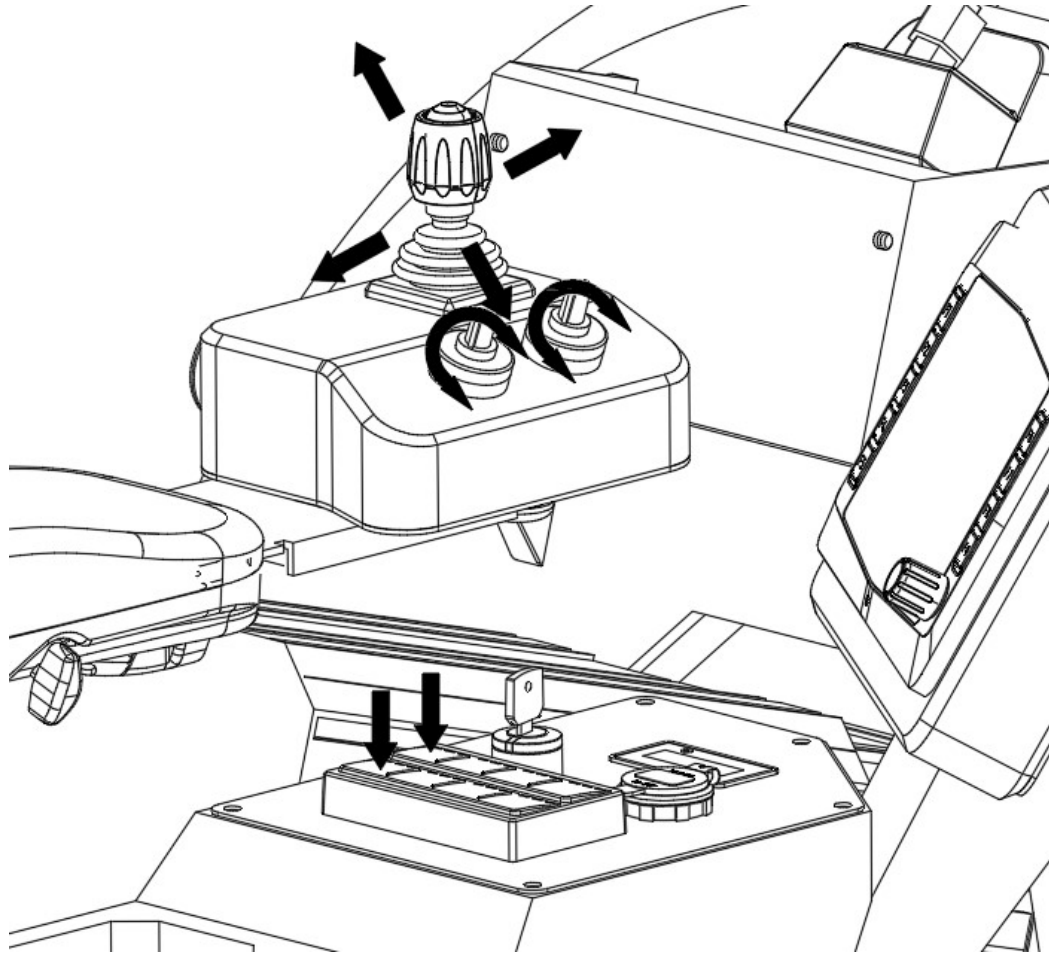

4.4.2 Stop the grinder.

Reset the direction control stick, press the motor forward rotation button again, and the motor stops forward rotation (press the motor reverse button again, and the motor stops reverse rotation), reset the motor governor and speeder, and press the emergency stop switch to stop grinding.

Be careful: When stopping the equipment, it is recommended to unplug the power supply for safety.

The emergency stop switch can only be rotated and pressed down according to the rotation direction on the emergency stop switch, not pulled up.

Tank-1500 Grinder Manual

4.5 Replacement of grinding disc.

When replacing the grinding plate, after confirming that the equipment has completely stopped, press the emergency stop button to adjust the angle of the gearbox to the warping position. Stand next to the equipment, check whether the equipment is stable, use a slotted screwdriver to replace the grinding plate and replace it with a new grinding plate.

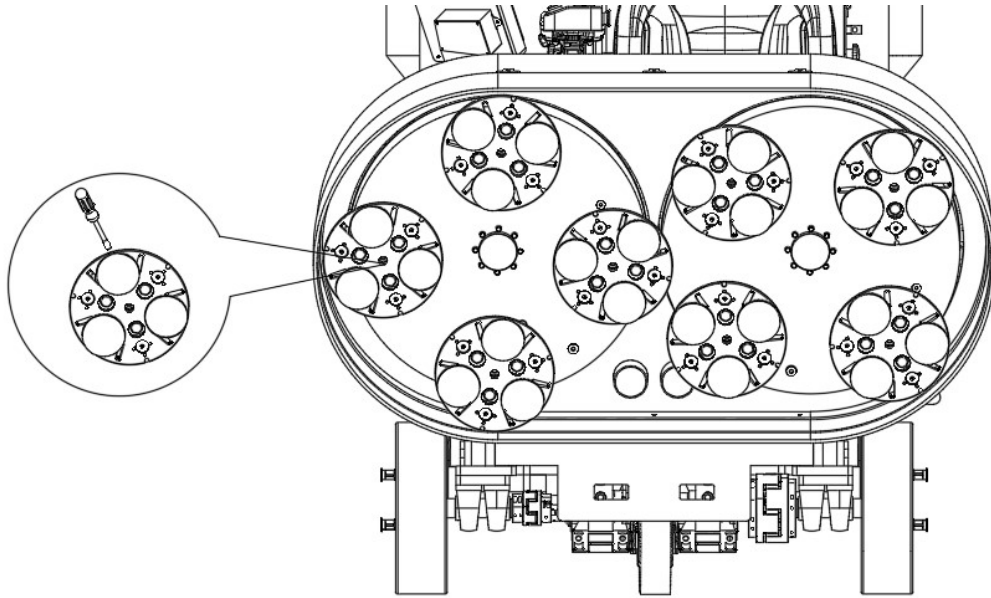

Be careful:

When the equipment operates for a period of time, the abrasive, grinding disc and gearbox will produce high temperature. Please pay attention to changing the abrasive to avoid scalding.

Make sure to replace the grinding disc when the power supply is unplugged, and the emergency stop is pressed.

Tank-1500 Grinder Manual

4.6 Winding method of equipment working cable.

During the operation of the equipment, the wire winding method is particularly important, which can greatly improve your work efficiency and improve your use safety. The specific operation methods are as follows:

1. pass the power line through the wire support rod;
2. Wrap the power cord around the wire support rod for at least two turns;
3. Pull the power cord slightly to ensure that the power cord has enough friction to make the power cord firmly fixed on the wire support rod;
4. Plug in the external power supply.

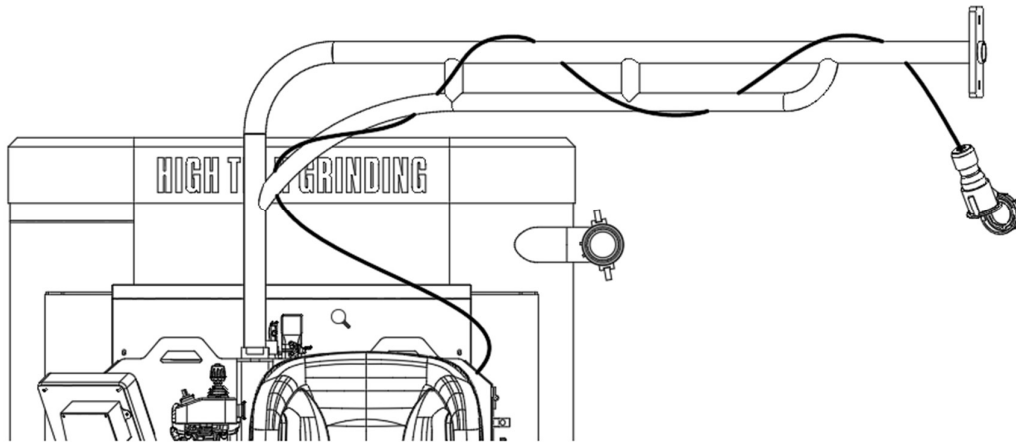

Matters needing attention:

- 1.Ensure that the power plug and socket are firmly connected;
- 2.Before inserting the power plug, confirm that the emergency stop has been pressed and other switches have been reset;
- 3.Please use the power cord according to the minimum specification of the wire;
- 4.Please use the correct power supply.

Tank-1500 Grinder Manual

4.7 Start and stop the vacuum cleaner.

1. Connect the vacuum cleaner to the power supply. Use a cable suitable for the vacuum cleaner (see the minimum cable area of the technical data).

Start the vacuum cleaner: click the start / stop button to start the equipment.

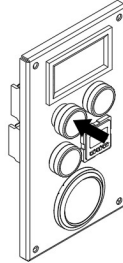

2. Stop the vacuum cleaner: when the equipment is running, click the start and stop button to stop the equipment.

4.8 Dust cleaning device.

In order to ensure the effective cleaning of the filter element, all gaskets on the vacuum cleaner should be checked to ensure their tightness.

The dust cleaning device is mainly a device that can clean the accumulated dust on the filter element when the dust absorption capacity of the filter element decreases after the vacuum cleaner works for a period of time. Click the time adjustment button to adjust the cycle time of each dust cleaning device. The equipment will cycle to clean the filter element according to the set time, which will not affect the dust collection and can achieve the effect of dust cleaning; when the manual dust cleaning button is pressed, enter the manual dust cleaning mode. For the operation of dynamic ash cleaning, if it is operated continuously, the dust collection effect will be reduced during the operation.

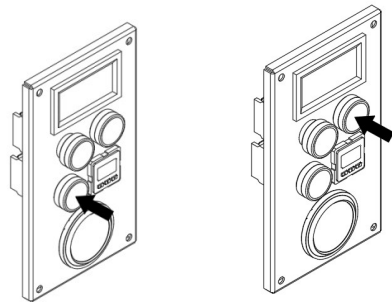

Jog to adjust the cycle interval of the ash cleaning device and press the button to enter the manual ash cleaning mode

Tank-1500 Grinder Manual

4.9 Dust collection device.

The vacuum cleaner is equipped with a dust collection device, which is mainly composed of a dust collection bag hanging bucket and a dust collection bag. The dust collection bag is mainly installed on the dust collection bag hanging bucket. The dust collection bag hanging bucket with a dust collection bag is installed under the cyclone separation bucket and the filter element bucket respectively. Before the preparation of the vacuum cleaner, pull the dust collection bag from the dust collection bag hanging bucket and tie it with a tie to prepare for dust collection.

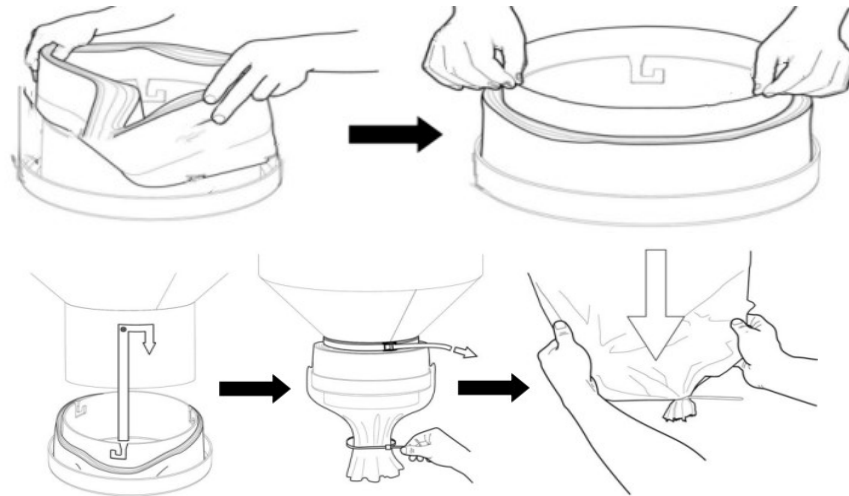

When the dust collector runs for a period of time and the dust in the dust collection belt reaches a certain amount, it is necessary to consider cleaning the dust collection bag and preparing for the next dust collection.

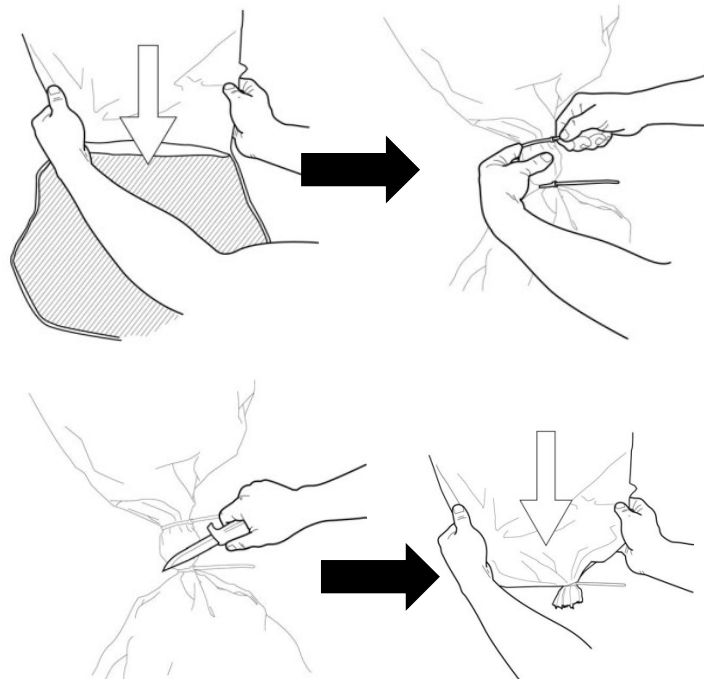

Tank-1500 Grinder Manual

4.10 Best grinding path.

When grinding the ground, the ground should be grinded according to the # word, so that the grinding effect will be better. When grinding the ground according to the # word, the grinding direction of the grinder should be the direction of pulling the wire farther and farther, so as to further avoid the interference of the wire to the normal operation of the grinder.

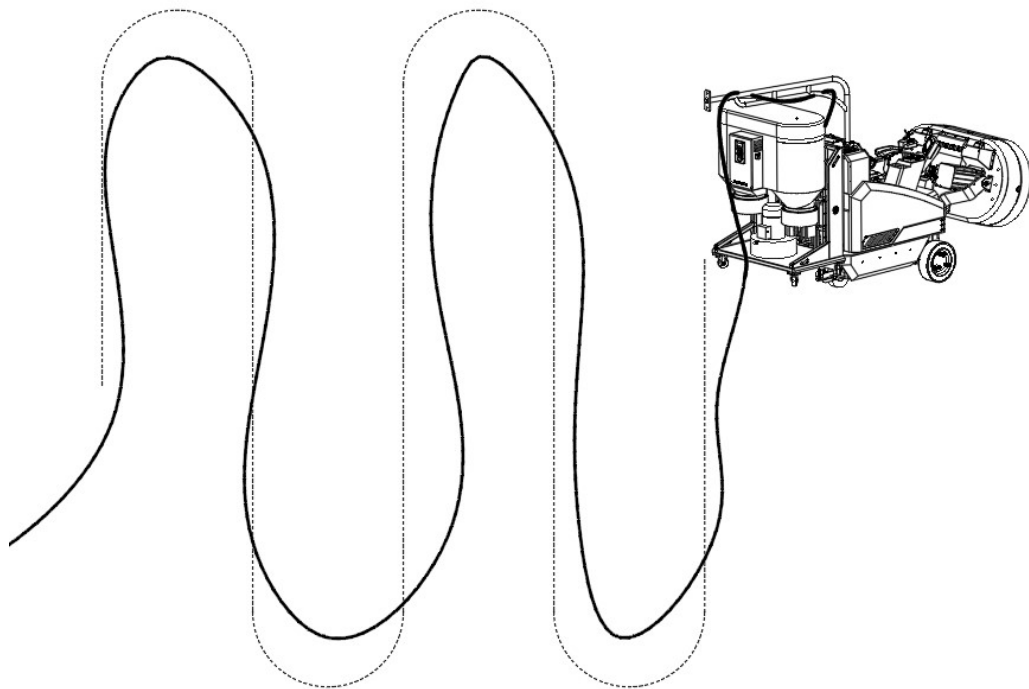

5. Equipment Operation (Remote operation)

5.1 General.

The following sections describe the grinder at different positions when controlled by the remote control, the main operation of the grinder, and how to install the grinding disc.

Cautions & Attentions:

1.The grinder can only be used or repaired by personnel who have received necessary theoretical and practical training and have carefully read the user manual.

2. Protective equipment shall be used when operating the grinder, such as protective gloves, protective mask, work clothes, safety helmet, insulating shoes, etc.

5.2 Equipment location description.

The position description of the equipment is the same as that of the car operation. It can be seen in detail. The only difference is that when the equipment is grinding, press the emergency stop switch and power switch on the remote-control panel to adjust the position of the equipment.

Cautions & Attentions:

1. When the equipment moves, the line of sight may be blocked. Make sure to operate "single person for a single machine".

2.Dust inhalation is harmful during grinding. Please wear a professional mask during operation to ensure personal safety.

3.During the process of lifting and lowering the gearbox, special attention must be paid to its own safety to avoid damage to the equipment.

Tank-1500 Grinder Manual

5.3 Starting and stopping the grinder.

(1) Plug in the power cord (before that, make sure that the emergency stop is pressed and all switches have been reset); if it is in the dry grinding state, turn on the vacuum cleaner; under the water grinding state, fill the water tank with water.

(2) Take out the remote-control box and tie the remote control to your waist (as shown in the figure below after adjustment)



(3) When starting, the emergency stop switch on the swing lever is turned on according to the rotation direction, and the switching manual / remote control mode on the control box is switched to the remote-control state. Carry out the operation of the remote controller: turn on the emergency stop switch, turn the power switch knob to the 1# power supply, and then start the equipment (if water grinding is carried out, press the spraying switch on the remote controller). use the direction control handle to control the direction of the equipment. (the specific operation is shown in the figure below).

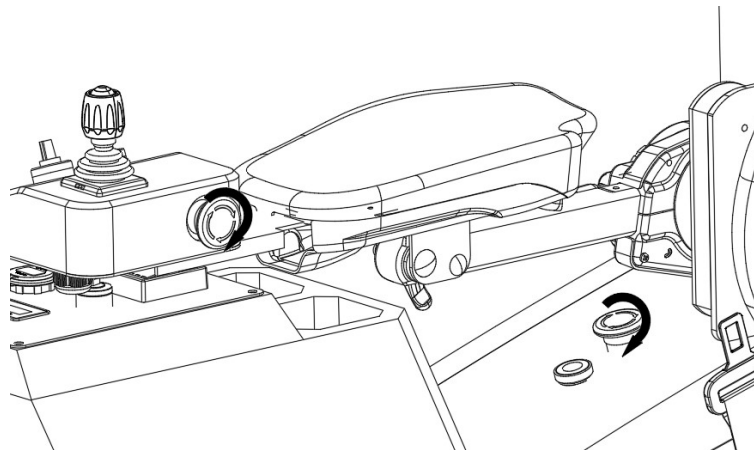

Tank-1500 Grinder Manual

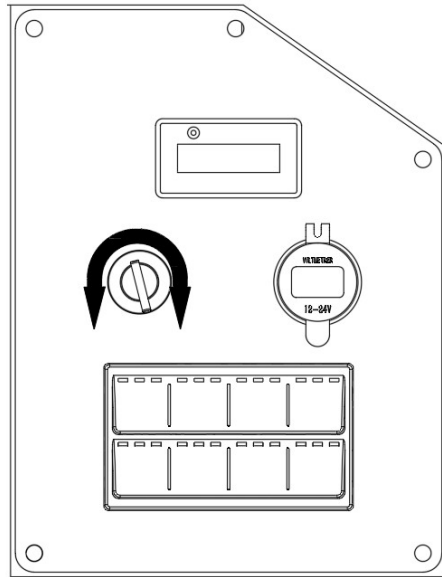

Stop the grinder: stop the motor and reset all buttons (for water grinding, press the spray switch to turn off the spray function). Press the emergency stop switch and turn off the power supply to stop the equipment (remember to reset the forward and reverse switches of the motor).

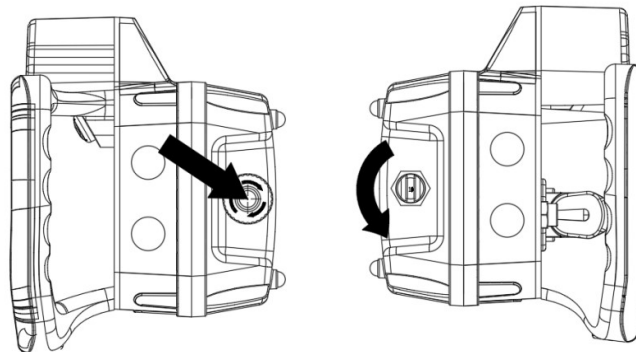
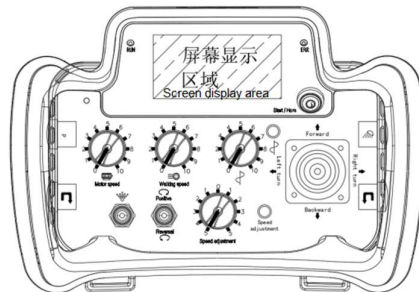

Tank-1500 Grinder Manual

Be careful:

1. When stopping the equipment, it is recommended to unplug the power supply for safety reasons.

2. The emergency stop switch can only be rotated and pressed down according to the rotation direction above the emergency stop switch and cannot be pulled up.

3. When turning on the equipment for operation, pay attention to reset the switches on all its remote controls to ensure the normal use of the equipment. Otherwise, turn on the power switch and the equipment will not operate.

4. When using the remote-control device, the remote control cannot leave the normal use range of the equipment. You can pay attention to the signal light on the remote control, otherwise it will not control the equipment if it is too far away.

5. Turn on the transmitter and check whether the power light flashes slowly. If not, adjust the transmitter.

6. The grinding disc drive motor must start to run before the steering stick can be moved.

7. Press the emergency switch on the transmitter when the equipment needs to stop working or in case of emergency.

5.4 Replacement of grinding disc.

The steps for replacing the grinding plate of the equipment are roughly the same as the manual operation. See the details.

Be careful:

1. Before replacing the grinding disc, be sure to press the emergency stop switch on the remote control and turn off the power switch.

2. Dust inhalation is harmful during grinding. Please wear a professional mask during operation to ensure personal safety.

3. During the process of lifting and lowering the gearbox, special attention must be paid to its own safety to ensure that the equipment will not tilt forward before replacing the abrasive.

Tank-1500 Grinder Manual

4. Before operating the equipment, remember to wear protective masks, work clothes, insulating shoes, protective gloves, etc.

5. When the equipment operates for a period of time, the abrasive, grinding disc and gearbox will produce high temperature. Please pay attention when changing the abrasive to avoid burns.

5.5 Best grinding path.

The best grinding path of the equipment is the same as that of manual operation.

Be careful: When grinding, it must be noted that the equipment cannot press the line.

During remote grinding, pay attention to the obstacles in front to avoid personal injury and equipment damage.

Tank-1500 Grinder Manual

5.6 Precautions.

While grinding, be sure to pay attention to the power indicator on the remote control. When the power is low, replace the battery in time or stop grinding to charge the battery. Otherwise, the manufacturer will not compensate you for any loss caused by it.

During the grinding process, be sure to pay attention to the signal reflected by the signal indicator on the remote control at any time.

During grinding, the direction control switch of the remote control only needs to be gently turned.

During grinding, observe the wire while grinding to prevent the wire from being pressed.

During grinding, be sure to pay attention to the obstacles nearby to avoid equipment damage and personal injury.

Before grinding, pay attention to the reset of clutch pin. If it is not reset, the equipment will not walk.

6. Equipment Maintenance

6.1 Overview.

We recommend checking the grinder regularly to prolong the service life of the grinder.

Be careful:

During maintenance and repair, the power supply of the grinder must be disconnected.

Use protective equipment, such as safety shoes, protective gloves, protective mask, etc.

6.2 Daily inspection.

6.2.1 Check the switch.

Rotate the emergency stop switch along the rotation direction above the switch, turn the positive and negative knob of the motor to start the equipment and see whether the equipment is started. (when the equipment is started safely and normally, the operation indicator will light up. If it is not started normally, there will be a fault indication on the display screen.)

Turn on the grinder and press the emergency stop switch to see if the equipment stops.

Turn on the emergency stop switch, turn on the LED switch and check whether the LED light is on.

Tank-1500 Grinder Manual

Be careful:

For the sake of safety, it is strongly recommended to press the emergency stop switch when stopping the equipment, which is safer.

6.2.2 Check the grinding disc cover.

When there is a lot of dust, it is easy to cause dust blockage at the suction pipe orifice on the grinding plate cover of the grinder. Illuminate the suction pipe orifice with a flashlight to see if there is dust blockage and clean it if necessary.

6.2.3 Inspection of grinding disc.

When the grinder works for a long time or there is a lot of grinding dust, the conversion block of the grinding head may be stained with dust. If too much dust is not cleaned in time, it will not fit between the grinding head and the conversion block, affect the grinding efficiency, and more seriously, it will lead to abrasive falling and accidents. Remember to clean it if necessary.

6.2.4 Long term storage of battery.

During long-term storage, the equipment battery shall be maintained and charged every 6 months.

6.2.5 Be careful.

Remember to use protective equipment during maintenance and inspection, such as protective gloves, protective mask, insulating shoes, etc.

The inspection and maintenance can only be carried out when pressing the emergency stop and unplugging the power supply.

Tank-1500 Grinder Manual

6.3 Cleaning

6.3.1. Cleaning switch.

When the grinder works on the construction site for a long time, it is inevitable that there will be dust on the switch. Therefore, after each operation of the grinder, check whether the switch is blocked by dust, resulting in switch failure.

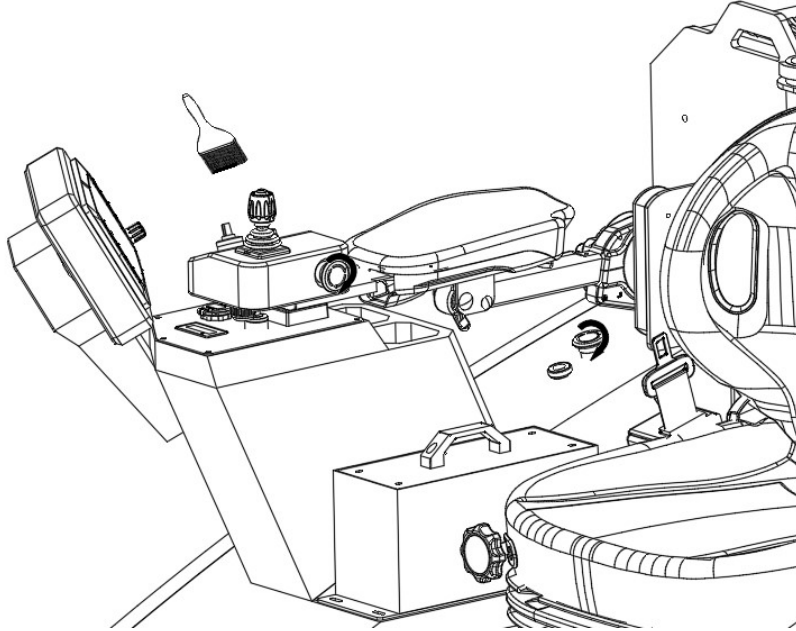

6.3.2 Clean the grinding disc cover.

Remove the suction pipe interface, illuminate the suction pipe orifice with a flashlight, and clean the dust at the suction pipe orifice with a brush so that it will not block the suction pipe orifice and affect the efficiency of suction.

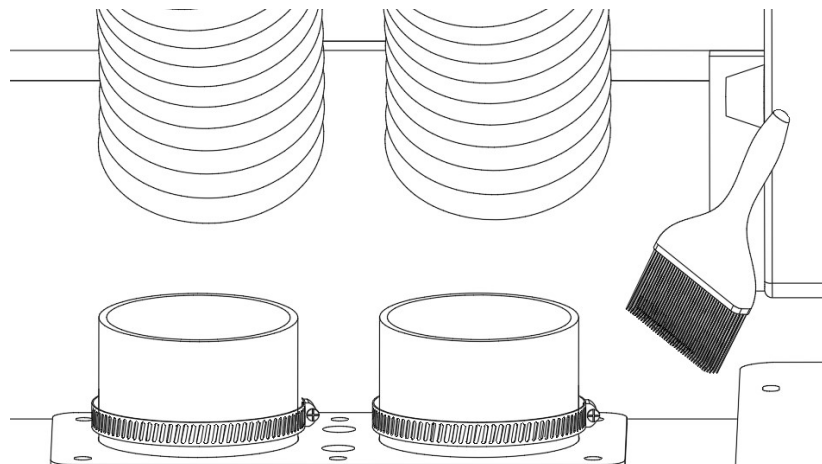

Tank-1500 Grinder Manual

6.3.3 Clean the grinding disc conversion block.

Tilt up the equipment, tilt down the grinding plate with a slotted screwdriver and shovel off the dust with a shovel. If it is not cleaned in time, the grinding plate may not be firmly bonded and fly during grinding, resulting in equipment damage and personal safety threat.

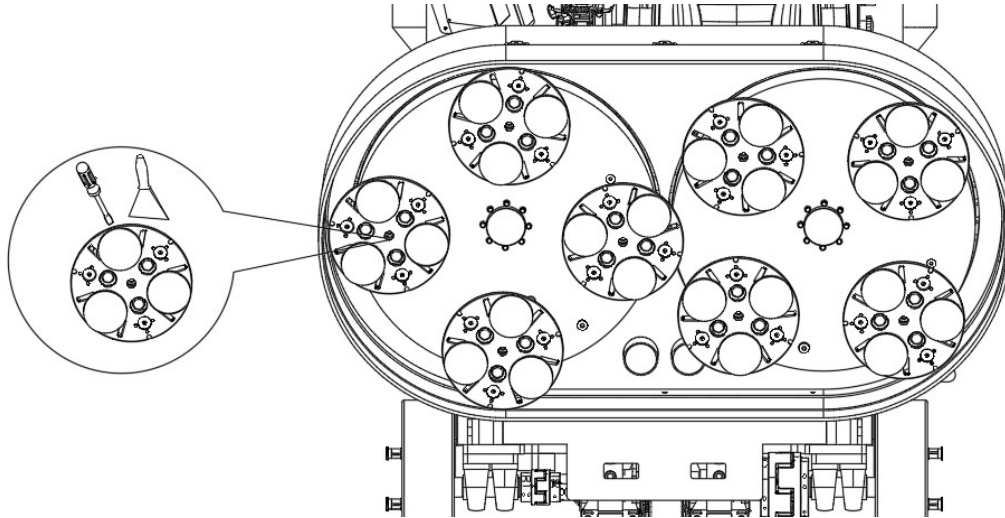

6.3.4 Clean the filter element.

Enter the manual ash cleaning mode for many times (the interval of jogging the button is about 20s, which is too short and the ash cleaning effect is poor). After repeated times, the filter element can be cleaned.

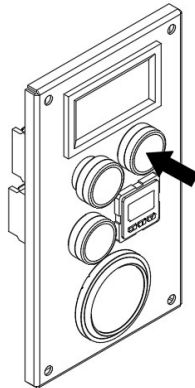

To thoroughly clean the filter element, remove the filter element and take it out for cleaning.

Tank-1500 Grinder Manual

Press the start / stop button and pull out the power supply to stop the equipment.
Loosen the four tower buckles on the filter element cover, rotate the filter element counterclockwise and remove it.

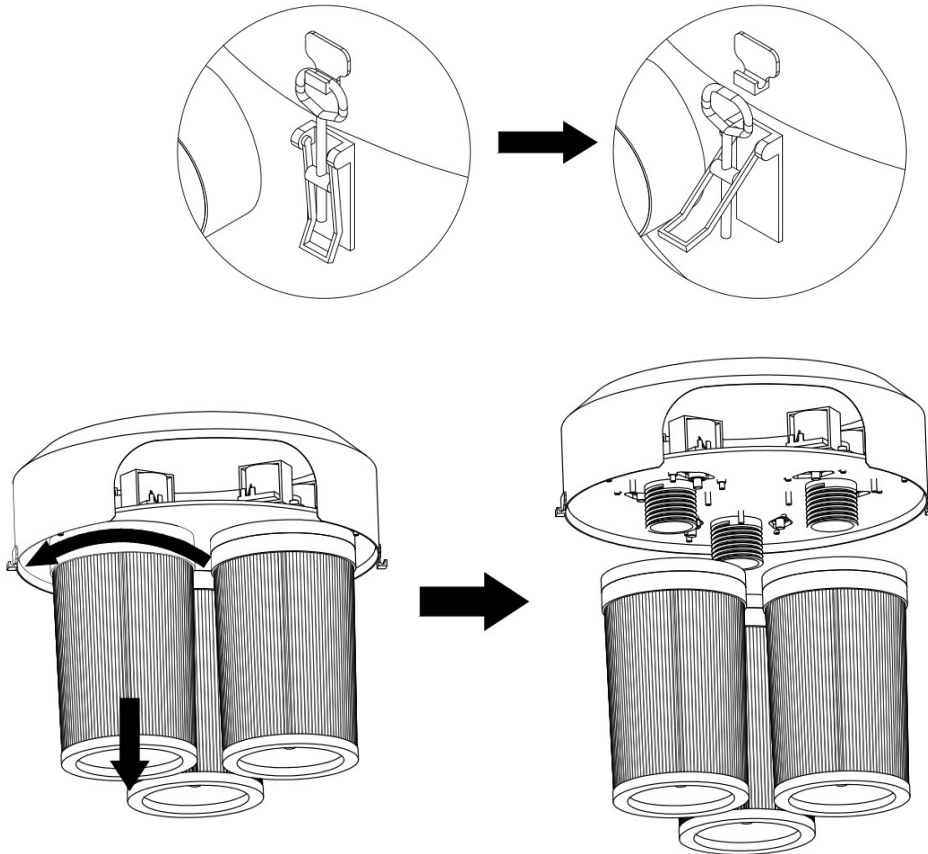

6.3.5 Notes.

1. Be sure to pull out the plug from the socket before cleaning, maintenance or assembly.
2. Be sure to clean all the equipment after work every day. Do not directly clean the equipment with a high-pressure cleaner.
3. In order to effectively cool the equipment, the cooling air port must be kept unblocked and clean.

6.4 Overload protection.

Overload protection is installed on the frequency converter of the equipment. When the equipment is overloaded, the display screen on the control panel will display the equipment overload. At this time, just pull out the power plug and plug it in.

Tank-1500 Grinder Manual

6.5 Maintenance.

Any equipment that may need to be repaired must be repaired by Xingyi service center by training service personnel and using Xingyi original accessories and accessories. If your equipment needs to be repaired, please contact your retailer.

7. Common Problems and Solutions

7.1 Overview

This chapter describes some possible faults and how to deal with them. If you still can't solve them or an error occurs, please contact the nearest retailer.

7.2 Common problems and solutions of grinder

Problem	Possible causes	Solutions
The machine does not start	Emergency stop switch pressed	Turn on the emergency stop switch.
	overload	Press the emergency stop switch, press the reset switch several times and restart the machine.
	The power supply and power cable are damaged	Contact a licensed electrician.
	There is a problem with the rear contact switch button	Make sure that the wire is correctly connected to the rear button and check the contact and ignition button.
	The switch is damaged	Replace the switch.
The machine is difficult to control or the motor current consumption is large	There are too few diamonds under the machine or the wrong tool type is applied	Use the amount of diamond recommended by Xingyi to reduce the stress on the grinder and operator.
Machine jumping or runout	Diamonds may not be installed correctly or at different heights	Correctly install the diamond with the same height.
	Is the chassis flat	Adjust and install the chassis

Tank-1500 Grinder Manual

7.3 Common problems and solutions of vacuum cleaner

Problem	Possible causes	Solutions
The machine does not start	The machine does not receive or output power	Connect the power cable to the machine and start it
	Cable damage	Contact a licensed electrician
	The control circuit is damaged	Contact a licensed electrician or Xingyi service center
Stop after vacuum cleaner starts	There are objects blocking the air flow	Clean hoses, filters, etc
When the switch is on, the machine makes a low hum	Lack of phase input, there are only two phase inputs at present. Turn off the machine power to avoid burning the motor	Contact a licensed electrician or check whether the input power supply has three-phase input
	Dust in motor impeller	Contact a licensed electrician
The machine blows, not sucks	Phase relay fault	Contact the licensed electrician to change the position of L1 and L3 wires on the power plug, and replace the phase relay if necessary
Poor dust collection performance of the machine	Maybe the vacuum system is not sealed	Check and repair the tightness
	Cyclone separator or filter element blocked	Clean the cyclone separator and filter element with compressed air or brush
	Hose blockage	Wave type shaking dust suction pipe
The machine is blowing dust	Incorrect installation of filter element	Install the filter element correctly
	The filter element has been misaligned and separated	Reinstall the filter element
	The filter element is broken	Replace the filter element with a new one
Cyclone drum does not work	The dust is too light and too fine	
	Cyclone blocked	Clean the cyclone separator (see operation above)

Tank-1500 Grinder Manual

8. Technical data

The technical data and dimensions of the equipment are as follows:

	TANK1500
Motor power	18.5KW*2=37KW (25HP*2=50HP)
Rated voltage	3P 480V
Rated current	90A
Input Hertz	50HZ/60HZ
Frequency converter	18.5KW*2=37KW (25HP*2=50HP)
Grinding width	1550mm/60.83in
Grinding disc size	Φ278mm/Φ10.94in
Grinding speed	450~1950 rpm
Dimension (warping position) L x W x H	3508×1590×2239mm/75.31×38.54×74.65in
Dimension (working position) L x W x H	3453×1590×2239mm/135.94×62.60×88.15in
Package size Length x width x height	1615×979×1077mm/63.58×38.54×42.4in
Gearbox assembly Length x width x height	861×1590×781mm/33.90×62.60×30.75in
Frame assembly Length x width x height	1990×1306×1503.5mm/78.35×51.42×59.195in
Vacuum cleaner assembly Length x width x height	1047.5×1364.5×1640mm/41.24×53.72×64.57in
Machine weight	Gearbox assembly: 780kg; Frame assembly: 1750kg; Vacuum cleaner assembly: 360kg; Total weight: 2890kg
Wire model	25mm ²
Storage temperature	-20 ~ +60 °C/-4 ~ +140 °F
working temperature	-10 ~ +40 °C/+14 ~ +104 °F
humidity	Below 95% (no condensation)
Vacuum cleaner negative pressure value	26Kpa
Maximum flow of vacuum cleaner	750m ³ /h

Tank-1500 Grinder Manual

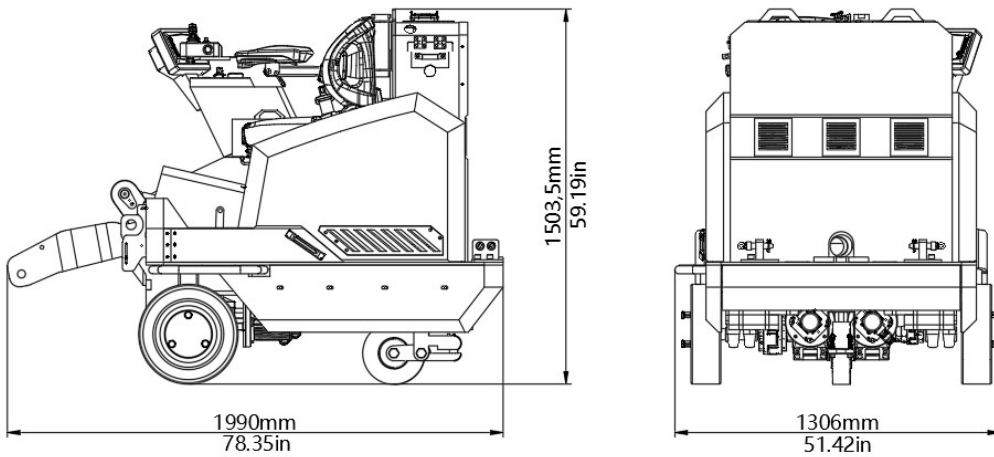
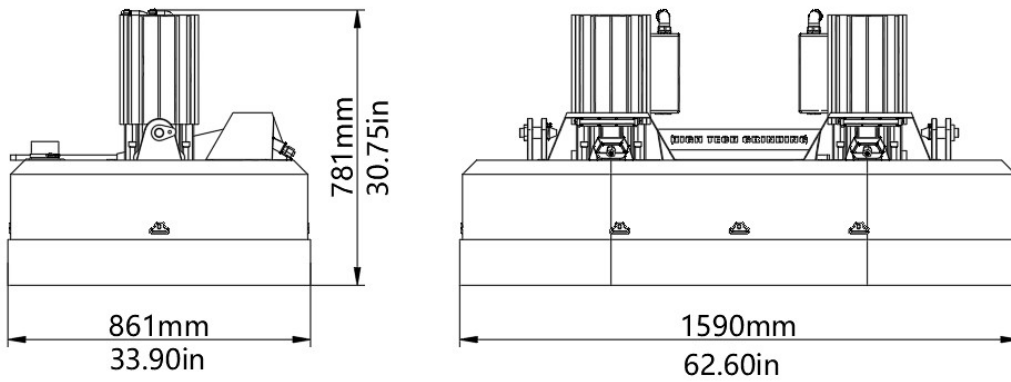
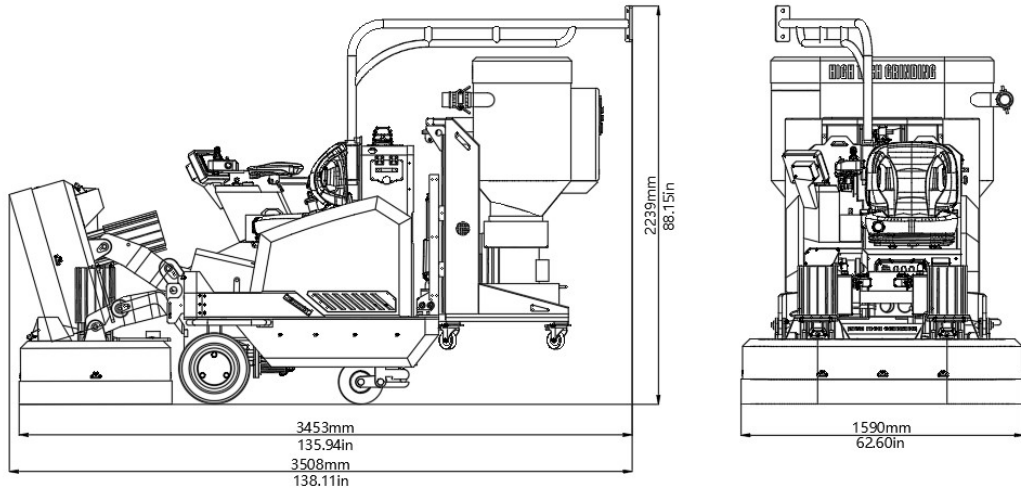

Tank-1500 Grinder Manual

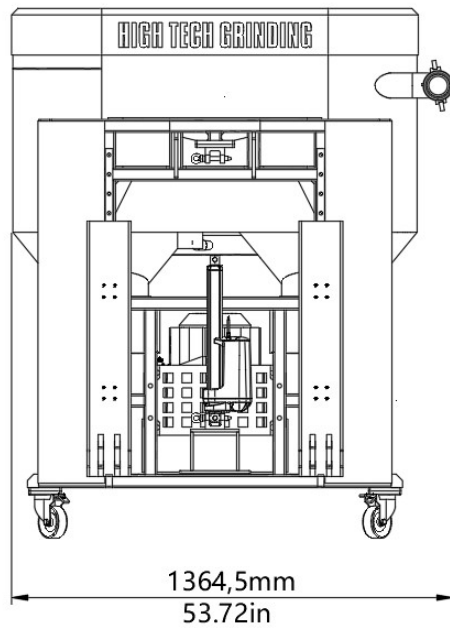
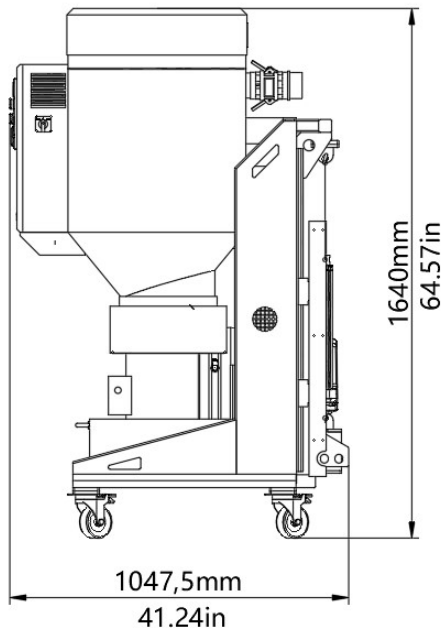

9. Warranty

Warranty regulations

Xingyi will not bear the cost of equipment damage caused by transportation, unpacking and improper human use. The local dealer may have specific warranty terms. Please contact the local dealer for specific terms.