

Manual of 955LE Remote Control Floor Grinder



Contents

1. Introduction

- 1.1 Summary
- 1.2 Responsibility
- 1.3 Accessories
- 1.4 Package acceptance
- 1.5 Machine name plate
- 1.6 Handling and storage
- 1.7 Warranty items

2. Safety Guidance

- 2.1 Overview
- 2.2 Operation safety guidance
- 2.3 Electrical safety guidance

3. Machine Description

- 3.1 Overview
- 3.2 Machine parts
- 3.3 Swing lever assembly
 - 3.3.1 Overview
 - 3.3.2 Forward/backward device
 - 3.3.3 Left/right turn device
 - 3.3.4 Handle
 - 3.3.5 The angle adjustment of swing lever
- 3.4 Water tank
- 3.5 Fast connector
- 3.6 Support wheel
 - 3.6.1 Disassembly of support wheel
 - 3.6.2 Lifting and lowering of support wheels
 - 3.6.3 The flip of the support wheel
- 3.7 Additional weight iron
- 3.8 Reserve battery charging
- 3.9 Remote control device
 - 3.9.1 Description of controls - control panel
 - 3.9.2 One-click turn
- 3.10 Remote control box
 - 3.10.1 Overview
 - 3.10.2 Lock the remote control box
 - 3.10.3 Usage of the remote control
 - 3.10.4 Usage of the remote control charger
- 3.11 Clutch device

4. Machine Operation (Manual mode)

- 4.1 Overview
- 4.2 Machine position description.
 - 4.2.1 Machine working position

- 4.2.2 Machine transportation position
- 4.2.3 Machine package position
- 4.2.4 Machine upright position
- 4.2.5 Precautions
- 4.3 Start and stop the grinder(Drive mode)
 - 4.3.1 Start the grinder
 - 4.3.2 Stop the grinder
- 4.4 Start and stop the grinder(Manual mode)
 - 4.4.1 Start the grinder
 - 4.4.2 Stop the grinder
- 4.5 Replace abrasives
- 4.6 The wire winding
- 4.7 Grinding route (for reference)

5. Machine Operation (Remote mode)

- 5.1 Overview
- 5.2 Machine position description
- 5.3 Start and stop the grinder
- 5.4 Replace abrasives
- 5.5 Grinding route (for reference)
- 5.6 Notes

6. Equipment Maintenance

- 6.1 Overview
- 6.2 Daily check
 - 6.2.1 Check the switches
 - 6.2.2 Check the disc cover
 - 6.2.3 Check the grinding plate
 - 6.2.4 Long-term storage of batteries
 - 6.2.5 Note
- 6.3 Cleaning
 - 6.3.1 Cleaning switch
 - 6.3.2 Clean the grinding plate cover
 - 6.3.3 Clean the grinding plate and Velcro-iron accessories
 - 6.3.4 Notes
- 6.4 Overloading
- 6.5 Maintenance

7. Frequently Asked Questions and Solutions

8. Technical Parameter

9. Warranty

1. Introduction

1.1 Summary

Xingyi machines are used to handle the floor surface. The scope of use of the machine depends on the choice of the tool. In addition to the use and general functions, this manual describes information on the use, repair and maintenance of the grinder. You can contact your local retailer for further information.

1.2 Responsibility

We make every effort to make this manual as complete and accurate as possible, and we are not responsible for any errors or loss of information. Xingyi reserves the right to change the instructions in this manual without prior notice.

This manual is protected by copyright law and can not be reproduced or used in any part without the express written consent of Xingyi.

1.3 Accessories

Below accessories are included with the grinder. Contact your supplier if anything is missing.

- (1) 1 grinding machine
- (2) 1 copy of machine user manual
- (3) 1 set of Velcro-iron adapters
- (4) 1 pcs connector (to match the machine's plug)
- (5) 1 pcs of anti-dust shroud
- (6) 2 pcs of main electric cabinet key
- (7) 1 set of quick connector for dust hose

1.4 Package acceptance

Check carefully to see if the package or the grinder has been damaged during delivery. If there is any sign of damage, contact your supplier and report it.

Check that the delivery matches the order. If there are any discrepancies, contact your supplier.

1.5 Machine name plate

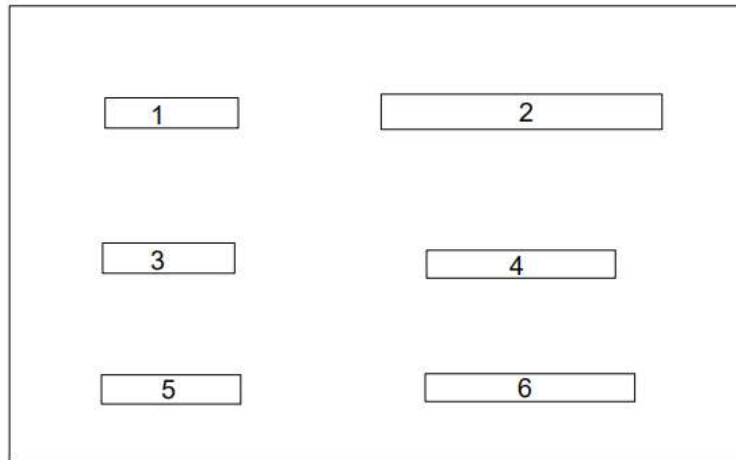

1. Model

2. Manufacturing date

3. Power

4. Voltage

5. Weight

6. Rotational speed

1.6 Handling and storage

The grinding machine should be stored in a dry place at room temperature when not in use. Otherwise it may be condensed and cold damaged. The size and weight of the grinder are given in the technical data of the Manual.

Attention! If the operation is careless, the grinder may turn over, causing personal injury and equipment damage.

1.7 Warranty items

This warranty covers only manufacturing defects. Xingyi does not assume damage in the transport, unpacking or operation. The manufacturer is not responsible for any damage or defects caused by improper use, corrosion or use of specifications beyond the noted specifications. The manufacturer shall not be responsible for any indirect damage or expense under any circumstances. For complete information on the manufacturer's warranty period, please refer to the current warranty terms of Xingyi. Local retailer may have special warranty terms. If you have any uncertainty about the warranty terms, please contact with your retailer.

2. Safety Guidance

2.1 Overview

This manual records the key information for machine safety operation. Read the manual carefully before your first operation.

Non-standard operation, modification or maintenance without training may cause losses, machine problems or injury. You are allowed to operate the machine after training. All maintenance must be done by qualified professional technician. Any machine parts that need to be changed must be provided by Xingyi.

Xingyi machines only can be used in the way of xingyi recommended. They only can be used for commercial purposes. Anyone who uses a machine should know its function, the location of the emergency stop. The operator should have to understand the safety rule that any unauthorized person cannot be stationed at work area when the machine starts.

The operator should be equipped with professional personal protective equipment when you are at work: safety goggles, protective gloves, safety shoes, breathing masks, protective ear protection, etc. Do not wear loose clothes or anything that can grasp things such as scarves, bracelets, rings and so on.

Note:

1. It is strictly prohibited to carry out operations, especially slope operations, when the battery voltage is less than 20%, so as to avoid causing personal injury.
2. To use machine at slope, the battery must be more than 40%, the clutch is locked and the AC input voltage is not less than the rated machine voltage.
3. When this machine needs to operate in a place with slopes, it should be less than 25 degrees. The company is not responsible for any accident caused by the operation when the slope is greater than 25 degrees.
4. This machine is only used for floor grinding, polishing.
5. Read and understand the safety guide totally. Different models have different accessories and operation instructions.
6. Operation of this machine only needs one person. Keep children or other persons away.
7. Operator who is in poor physical state or without training is not allowed to operate the machine. The operator and the repairman must be physically strong and able to withstand the weight of the whole machine and the working intensity of the motor.
8. Do not lend or rent the machine without the instruction manual.
9. Wear a helmet, safety shoes, hearing protection, safety glasses and masks when operating the machine.

10. Keep body, jewelry or any loose clothing away from machine moving parts. Otherwise, it may endanger personal safety.

11. Random modification of the machine is not allowed. Only Xingyi accessories can be used for maintenance and adjustment.

12. Do not operate the machine on rainy or foggy days.

13. Ensure no explosive flammable materials and steam nearby when operate machine. Do not operate machine nearby the place with fuel, grain dust, solvents, dilution agent or other flammable items.

2.2 Operation safety guidance

1. To use machine on a slope, the battery must be more than 40%, the clutch is locked and the AC input voltage is not less than the rated machine voltage.

2. It is strictly prohibited to carry out operations, especially slope operations, when the battery voltage is less than 20%, so as to avoid causing personal injury.

3. When this machine needs to operate in a place with slopes, it should be less than 25 degrees. The company is not responsible for any accident caused by the operation when the slope is greater than 25 degrees.

4. Operators should wear protective equipment when using the machine, such as dust masks, protective gloves, overalls, helmets, and safety glasses.

5. Make sure there is no oil leakage, electric leakage, water leakage on the machine before using. The machine can be used normally.

6. Check the machine control switches and electric parts are in good conditions and without moisture.

7. Make sure no obstacle or human being are in the working area. and make sure there is enough lighting to operate safely.

8. The anti-dust shroud should be installed on the machine for safety. It is necessary to connect to industrial vacuum cleaner when dry grinding.

9. The machine should be connected to appropriate electrical outlet. Only use the power cables that can withstand the machines voltage.

10. Do not adjust the handle during machine operation. Only when the machine is stopped and the emergency stop switch has been pressed, the worker can adjust the handle.

11. The handle has different functions when it is in different positions. Please read the manual for more information.

12. Ensure the machine has stopped operating and the emergency stop button is pressed when changing abrasives or accessories. If necessary, disconnect the power and the plug.

13. Keep the machine away from drains and furnace mouths or other dangerous goods, otherwise it may cause personal injury or loss of machinery and property.

14. Tight-hold hand grip, clockwise rotate the emergency switch, then turn on the power button and start the machine.
15. Please note that the emergency stop switch can only be pressed or rotated. Upward pull is prohibited.
16. Before operation, check the working surface and remove any protrusion to prevent machine plates and pads from damage.
17. When the equipment is plugged into the power supply, it is necessary to determine that the operating voltage and frequency of the equipment are consistent with the input voltage and frequency, and that there is no phase deficiency in the input power supply. (If the input power supply is inconsistent with the normal working power supply of the equipment, resulting in damage to the equipment, no warranty is given)
18. Connect with a vacuum recommended by Xingyi to achieve dust free working condition.
19. Install appropriate abrasive. Improper abrasive may cause personal injury and floor damage.
20. After installing the abrasive, keep the grinding plate in touch with the ground directly, adjust handlebar to the "working position", so that the operator could operate the machine easily.
21. When machine inverter turns to overload protection, it means there is something wrong with the machine (cable is too small or voltage is unstable), if so please reference the following cable sizes which are recommend. Or reduce the abrasive pressure (adjust the additional to suitable position) if users keep using the machine when overload leads to damage, it would be not allowed to guarantee.
22. After few minutes of grinding ,stop to check how much the abrasive uses. This behavior could reduce the production when using wrong polishing pads.
23. Do not tilt the machine while still running , otherwise the polishing pads may fly out to threaten human safety.

2.3 Electrical safety guidance

1. All circuit repairs can only be carried out by qualified personnel.
2. Note: After the machine is stopped, the line is still energized. Disconnect all power before servicing the machine.
3. The machine is equipped with an overload protection device and it will automatically jump off when the machine is overloaded, to prohibit the machine from running (re-adjust this overload in case of safety).
4. Continue to use the machine in the overloaded situation may cause some other losses even machine can't work normally, then manufacturer's warranty is unavailable.
5. The purpose of installing an inverter in machine is to speed and protect the user and the machine. It is forbidden to modify or adjust the inverter and modify the inverter parameters without the manufacturer's consent. If the unit fails, it is only allowed to replace the defective parts with the accessories provided by the manufacturer (Other loss caused by changing, adjusting or modifying

the inverter parameters without the manufacturer's consent, and the machine is not working properly, the manufacturer does not afford warranty).

6. Never modify the parts or lines inside the inverter by yourself.
7. Do not operate the machine when the distribution box is turned on.
8. If the machine current is overloaded, please pay special attention.
9. When the cables is energized or loaded, do not connect or disconnect the wires.
10. Using a damaged power cord may result in electric shock. Do not use a damaged power cord.
11. Cables should be kept away from hot surfaces.
12. The dryness of all electrical equipment should be maintained and the machine should be kept in a dry place.
13. After the power is turned off, before the panel indicator is off, it indicates that there is still high voltage inside the inverter, which is very dangerous. Do not touch the uninsulated electrical equipment.
14. The machine motor and the frequency conversion box are prohibited from entering water; (the other damage caused by the water inflow then the machine is not working properly, the manufacturer does not afford the warranty).
15. The machine must be connected to the qualified wire and voltage, specifications is noted by the manufacturer. (The machine label indicates the power supply specifications).

3. Machine Description

3.1 Overview

955LE is used to handle various types of flooring. For grinding (roughing, grinding, polishing) concrete, natural stone and terrazzo ground shall use the corresponding abrasive or the abrasive recommended by Xingyi.

955LE is a self-propelled, remote-controlled grinding machine and can be used for wet grinding. The forward/backward switch can be used to control the drive wheel forward and backward, so that users can get rid of the previous operation equipment need to manually pull or push the equipment and then make the equipment forward/back action, greatly simple manpower, user operation is more convenient.

This equipment is different from before: it increases the water tank, increase the weight of iron; increase the water tank and water switch, and open the heat sink on both sides of the tank to make the equipment frequency conversion box heat dissipation faster, can prolong the service life of the internal electrical appliances of the frequency conversion box; increase the water tank function so that the equipment can not only dry grinding but also water grinding, water grinding advantage is: grinding ground clothing good, small, easy to light, suitable for later polishing stone, users can

choose water grinding or dry grinding according to their own needs to operate; Increase the weight of iron to increase the equipment in grinding can increase the grinding pressure to make the ground more flat and efficient, lifting equipment more relaxed.

The swing rod and handle can be set in many different tilt positions. When the device is manually operated, one of the most suitable positions can be selected. The grinding head of the machine can be combined with different grinding plates for grinding operation. The dust belt covers the working environment grinding head area, because it is floating, so contact with the floor at all times, not only to ensure that the operator does not touch the rotating mechanical parts, but also to reduce the exposure of dust, and to improve the efficiency of dust absorption by vacuum cleaners.

During dry grinding, make sure that a vacuum cleaner is connected to the grinder (preferably equipped with a vacuum cleaner that fits the wing and works better). To prevent dust exposure to the air and pose a threat to the physical health of operators, operators and nearby people. Because inhalation of dust is harmful in the operation process, even with a vacuum cleaner should also wear a protective mask to protect their own health.

This machine can be used with different Xingyi abrasive. Due to the different ground materials, the abrasive discs used in grinding are also different.

3.2 Machine parts

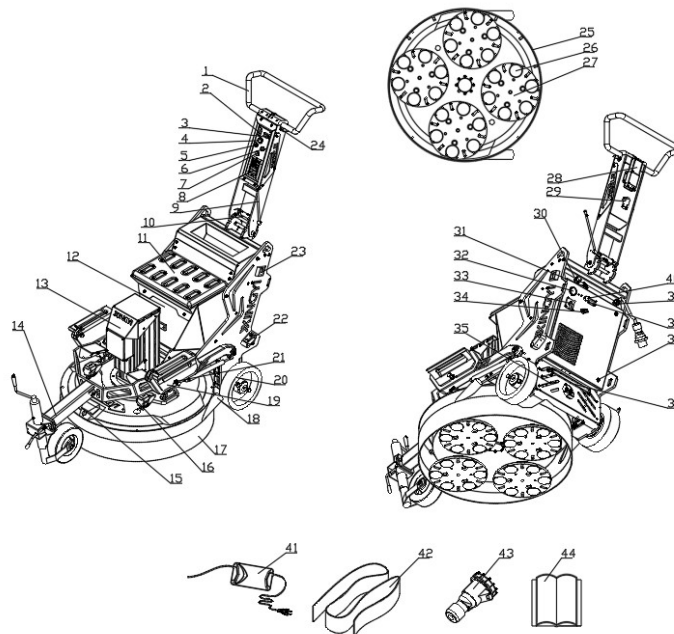

- | | |
|--------------------------------|---|
| 1. Handle | 6. Walking motor speeder |
| 2. Forward and backward switch | 7. Positive and reverse switch |
| 3. OFFSET (L - R) switch | 8. Display screen |
| 4. Emergency stop switch | 9. Handle for adjusting the swing lever |
| 5. Main Motor speeder | 10. Locking rod |

11. Operator's seat
12. Water tank
13. Main motor
14. Guiding wheel
15. Water spray device
16. Spotlight
17. Floating dust cover
18. Suction hose
19. Additional weight iron
20. Driving wheel
21. Bolt of additional weight iron
22. Additional iron weight base
23. Base of additional weight pin
24. Adjusting pin of handle
25. Gearbox cover
26. Velcro-iron accessories
27. Grinding discs
28. Charger of transmitter battery
29. Joint 01
30. Joint 02
31. Battery charging port
32. Timer
33. Power transfer knob(DC battery/AC power)
34. Operation mode transfer knob(manual /remote control)
35. Servo motor
36. LED spotlight
37. Electronic control box lock
38. Battery indicator
39. PLUGS
40. Running indicator
41. Charger
42. Dust skirt
43. Power socket
44. Manual

3.3 Swing lever assembly

3.3.1 Overview

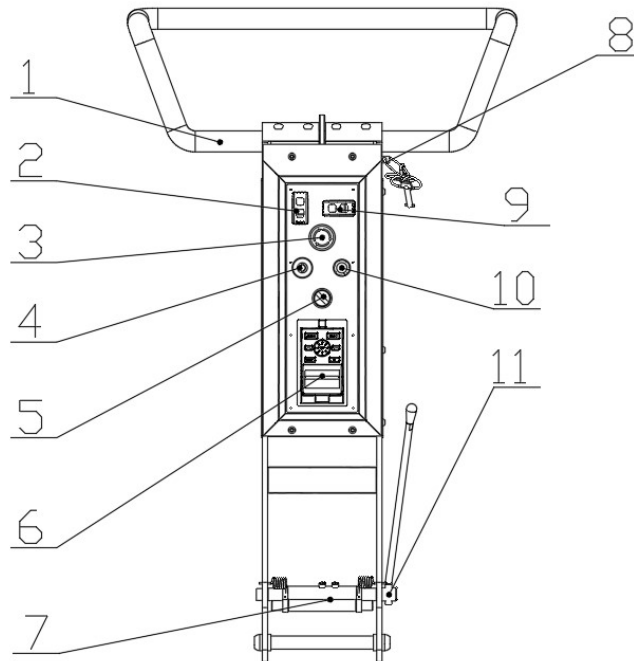

1. Handle: where people put their hands when operating the machine.
2. Forward/backward switch: controls the forward and backward movement of the device.
3. Emergency stop switch: when the device is in a dangerous state or needs to stop working, press the emergency stop switch to cut off the power and stop the operation of the device to achieve the protection of personal and equipment safety.
4. Main motor speeder: adjust the rotating speed of the motor.
5. Motor starting switch: it has three positions correspond to the motor working direction, forward, reverse, neutral.
6. Display screen: display some parameters, such as voltage, current, motor speed and fault code.
7. Swing lever locking rod: lock the rotation of swing lever.
8. Handle adjusting pin: pull out the pin and the handle can be rotated freely to the proper position to operate the device.
9. OFFSET (L - R) switch: control the movement of the device to turn left and right.
10. Walking motor speeder: adjust the walking speed of the drive wheel.
11. Swing part adjusting handle: use the handle to adjust the angle of the swing part, and there will be a corresponding position in the corresponding working state.

3.3.2 Forward/backward device

The forward/backward device is mainly used to control the forward or backward movement of the equipment. It frees the user from the need to manually pull or push the device to make the device move forward/backward, which greatly simplifies the manpower and makes the user's operation more comfortable and convenient.

The forward/reverse device mainly has three gears. One is the forward gear: press forward to execute the forward movement of the equipment; the other is the intermediate gear, press the switch to the intermediate gear, and the equipment executes the command that does not move (if it is currently in the forward gear, You should press backward to enter the middle gear; if the current is a reverse gear, you should press forward to enter the middle gear); third is to reverse gear, press backward to execute the device's backward movement.

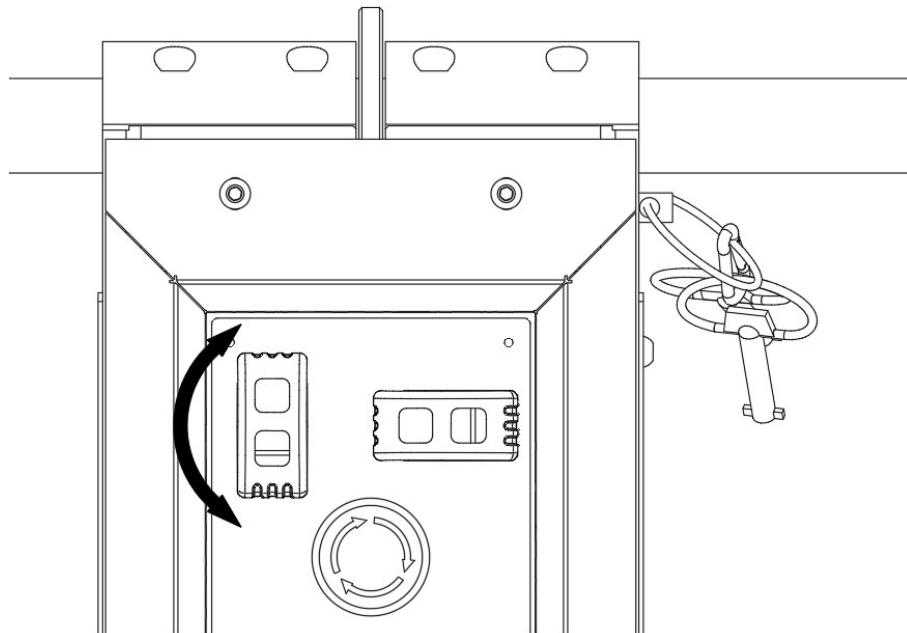

Notice:

When changing to different gears, pay attention not to use too much force, otherwise gears will be skipped;

During the grinding operation, the vacuum cleaner must be connected (it is recommended to use the vacuum cleaner manufactured by Xingyi). Otherwise, if the vacuum cleaner is not effective in vacuuming, it is likely that the switch of the forward/reverse device will be blocked by dust, which will cause the switch to fail.

3.3.3 Left/right turn switch

The left turn/right turn switch is mainly used to control the left/right turn of the equipment. It frees the user from the need to manually pull or push the device to make the device turn left/right, which greatly simplifies the manpower and makes the user's operation more comfortable and convenient.

The left/right turn device mainly has three gears, one is the left gear: press to the left to execute the movement of the device to the left; the second is the middle gear, press the switch to the middle gear, the device executes the command of no movement (if currently in To shift to the left, press to the right to enter the middle gear; if the current shift is to the right, press to the left to enter the middle gear); third is to shift to the right, press to the right to execute Movement of turning the device to the right.

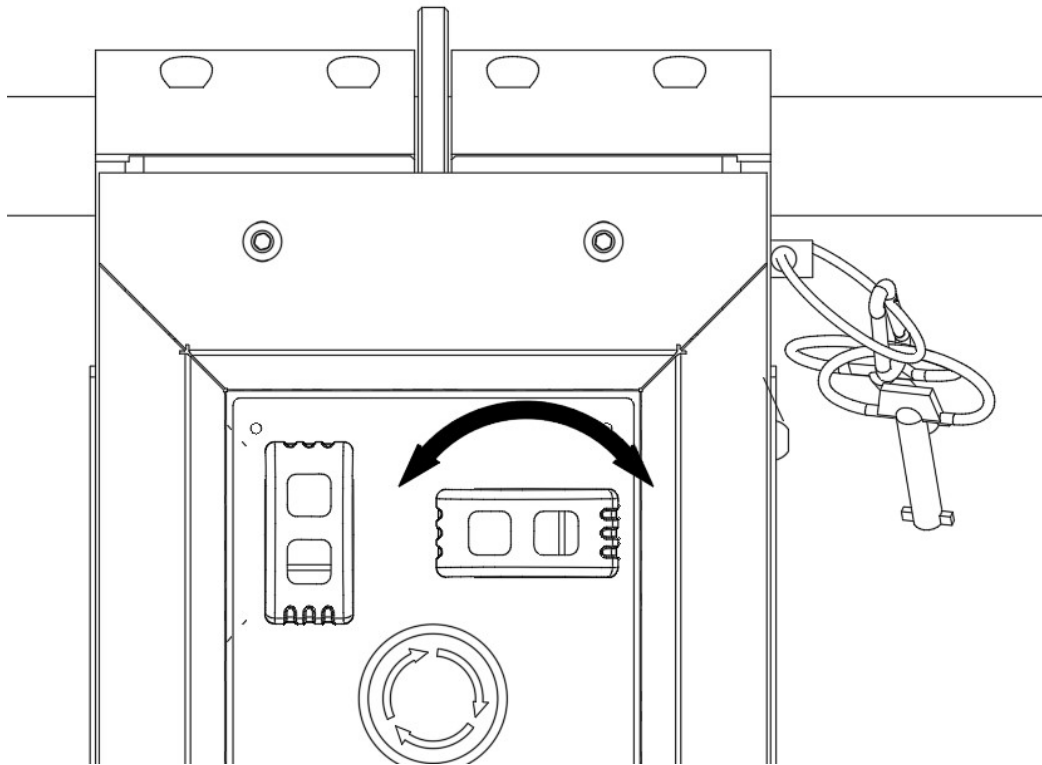

3.3.4 Handle

The handle adjusting bolt can be positioned at different round hole, so as to adjust the position of handle to meet different needs of users. Hold the handle with one hand, pull out the adjusting bolt with the other hand, then release the adjusting bolt when it is rotated to proper position.

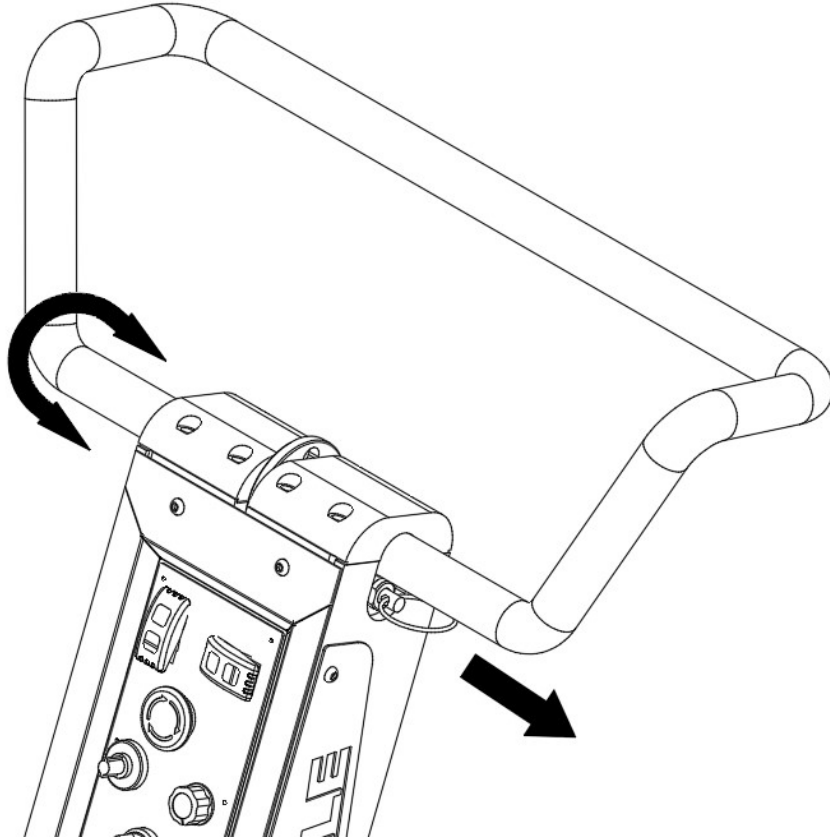

Note:

1. When plugging out the pin, sometimes it will be caught, and the pin can be pulled out by shaking the support wheel.
2. When the handle adjustment bolt is automatically reset, the hole may not be aligned, just rotate up and down.
3. When adjusting the position of the handle, please check whether the handle adjustment pin has been automatically reset before operating the machine.

3.3.5 The angle adjustment of swing lever

Use the swing lever position adjusting handle to adjust the position of swing lever to realize conversion of the machine placement mode in different states(Different equipment states are as follows). Hold the handle tightly with one hand to support the swing lever, turn the other hand counterclockwise and press down the adjustment handle, rotate according to the hole location on sector plate, and release the adjusting handle when it reaches required position.

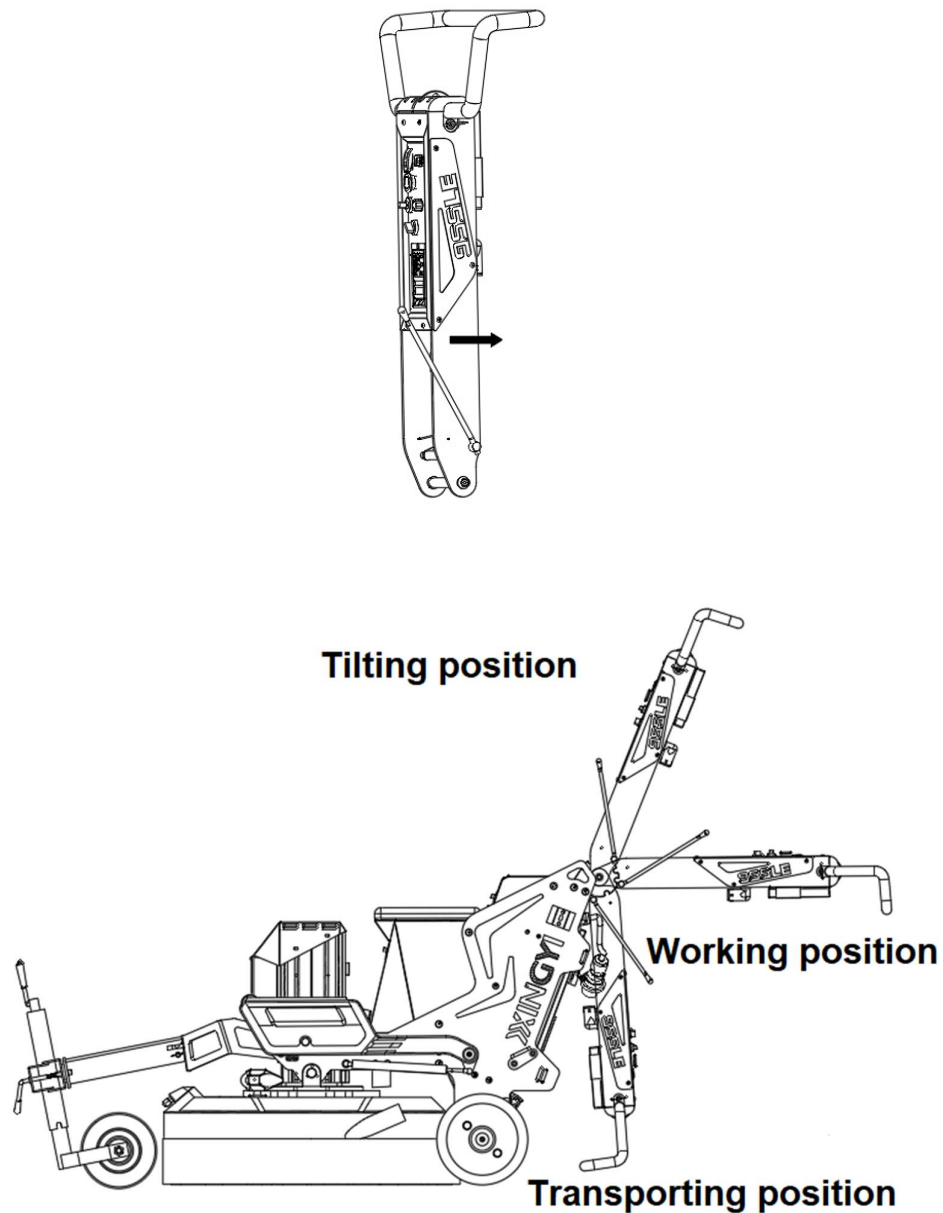

Note:

After adjusting the position of the swing lever, it is necessary to check whether the swing rod has been limited before operating the machine.

3.4 Water tank

There is a water injection port on the side of the water tank (open the water injection port as shown in the figure below) to fill the water tank with water. The heat dissipation openings on both sides of the water tank make the heat dissipation of the inverter box of the equipment faster, and can extend the service life of the electrical appliances inside the inverter box. When the equipment needs to perform water grinding work, turn the water switch clockwise to start water grinding work.

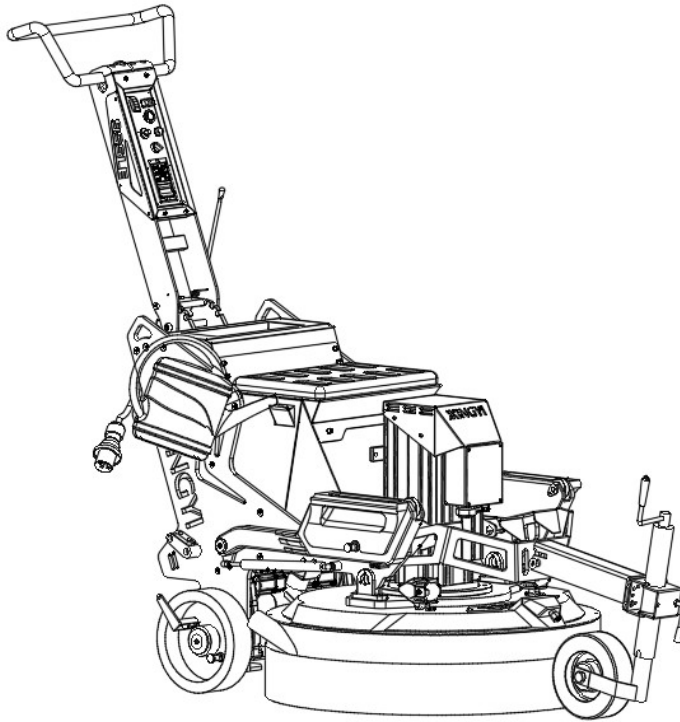

3.5 Fast connector

Fast connector consists of front and rear part (As follows) ,the front part is usually assembled with the vacuum nozzle of the grinder (screw the front part into the vacuum tube connection and screw it tightly), the rear part is matched with the vacuum tube (Screw the copper wire suction tube into the back and tighten).

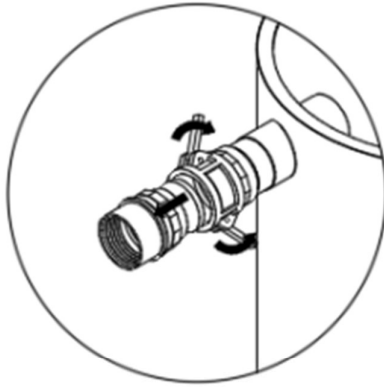

Release the two clamping buckles and take out the front part of the quick connector

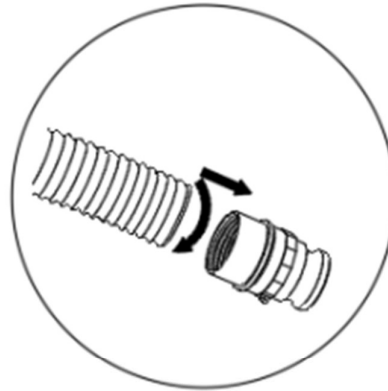

Screw the vacuum pipe into the front to match the internal thread

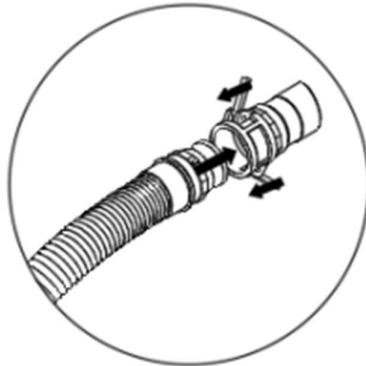

Match the locked front part with the rear part and push the locking buckle forward to lock it

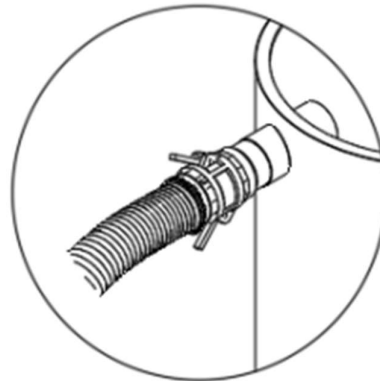

The final renderings

3.6 Support wheel

3.6.1 Disassembly of Support wheel

The supporting wheel is assembled before the travelling transportation, which can make the steering of the grinding machine smoother. When transporting the machine, sometimes it is necessary to move the machine forward and backward, so it is more convenient and labor-saving to install the supporting wheel to carry out the movement of the grinding machine. Remove or invert when grinding (It is recommended to disassemble it).

Remove the support wheel: first press the emergency stop switch, unplug the power plug, unravel the R-shaped split pin, remove the locating pin outward, and translate the support wheel downwards.

Install the support wheel: first press the emergency stop switch, unplug the power plug, align the support wheel with the pin hole of the front wheel support frame, then insert the positioning into the positioning, insert the R-type cotter pin, and fix the locating pin.

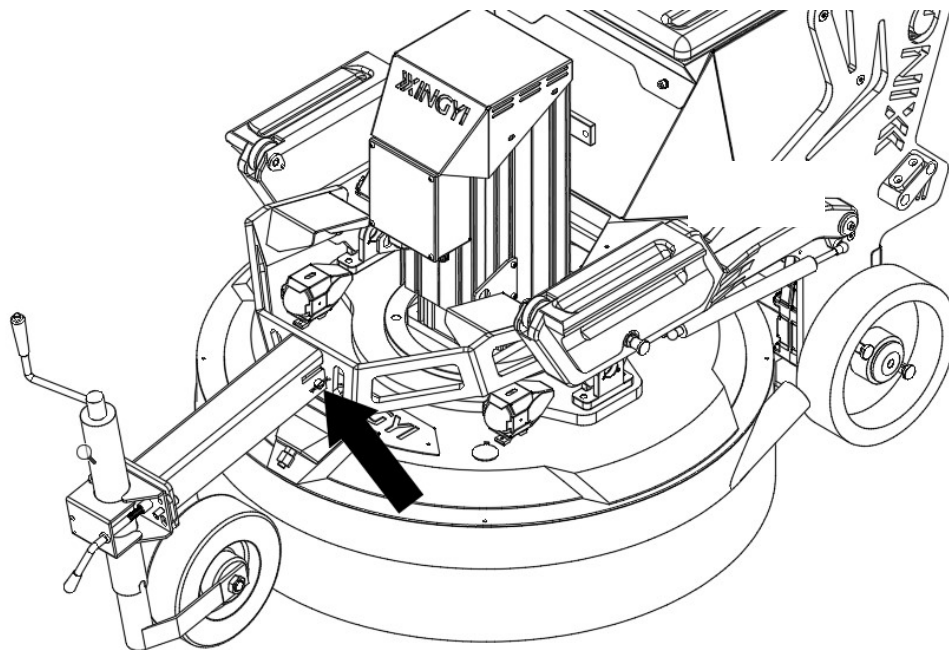

Note:

When plugging out the pin, sometimes it will be caught, and the pin can be pulled out while shaking the support wheel.

When pulling out the bolt, you need to hold the support wheel with one hand to prevent the support wheel from turning over suddenly.

3.6.2 Lifting and lowering of guiding wheels

Rotating the guiding wheel handle can raise or lower the equipment grinding device from the work area (clockwise rotation of the guiding wheel handle will raise the equipment grinding, while it lowers when in counterclockwise).

Notes:

In the process of transportation, it is best to remove the grinding disc in advance to prevent the disc from falling and losing. If lose, manufacturer does not give compensation.

When the support wheel rotates and rises, remember to lock the lock handle next to the support wheel to lock the support wheel shaft, and then carry out the lifting adjustment of the support wheel. The direction of rotation of the handle beside the supporting wheel: left is loose, right is tight.

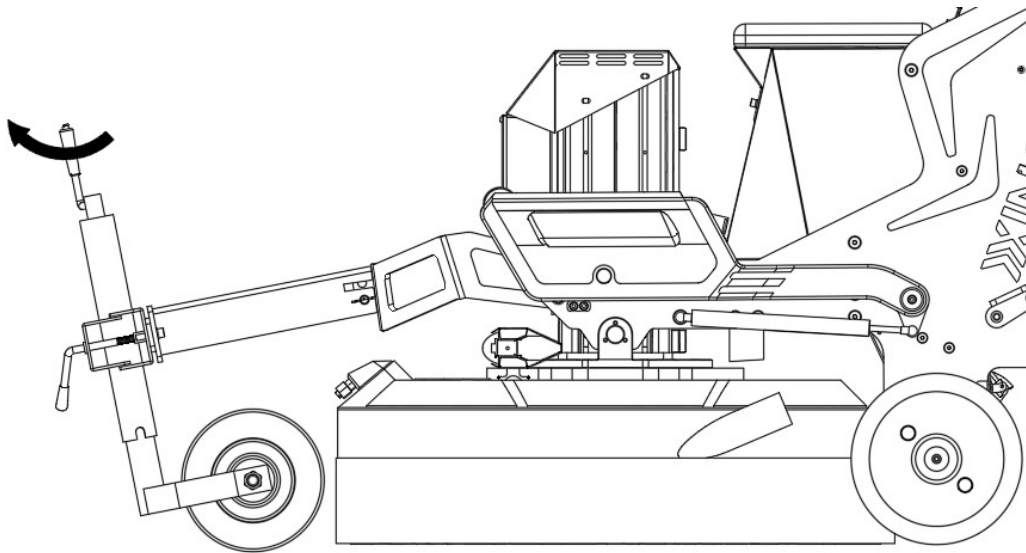

3.6.3 Assembling the guiding wheel to transport position

1. First unlock the R-type pin and remove the locating pin forward(part No.2)
2. Then attach the guiding wheel (Part No. 1) to the frame (Part No. 3) in the direction of rotation.
3. Insert the locating pin into the R-type cotter pin and fix the locating pin.

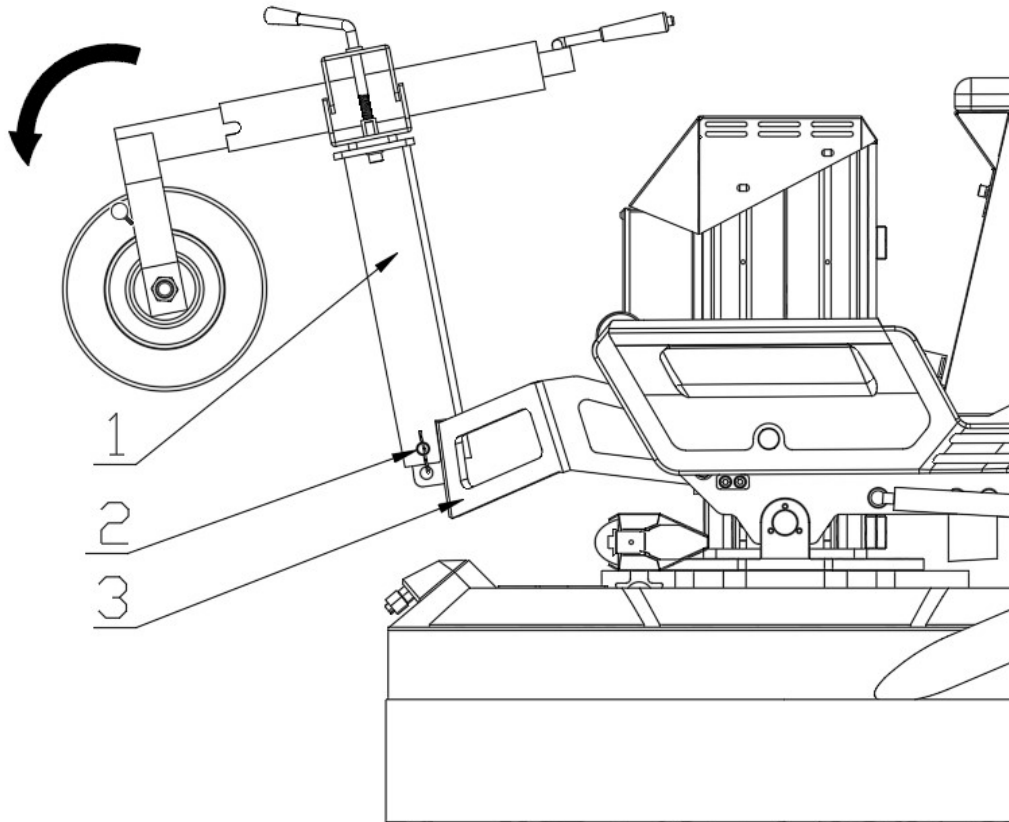

Notes:

The guiding wheel must be lowered to the lowest position before it can be turned over. Otherwise, the plug cannot be pulled out, and it may cause personal danger and other losses.

When the plug is pulled out, it may be stuck. You need to shake the support wheel and pull out the latch.

3.7 Additional weight iron

There are three positions for the additional weight iron: transporting, tilting, and working position. The adjustment and limit of the additional weight is mainly achieved by spring pin and limiting device on frame.

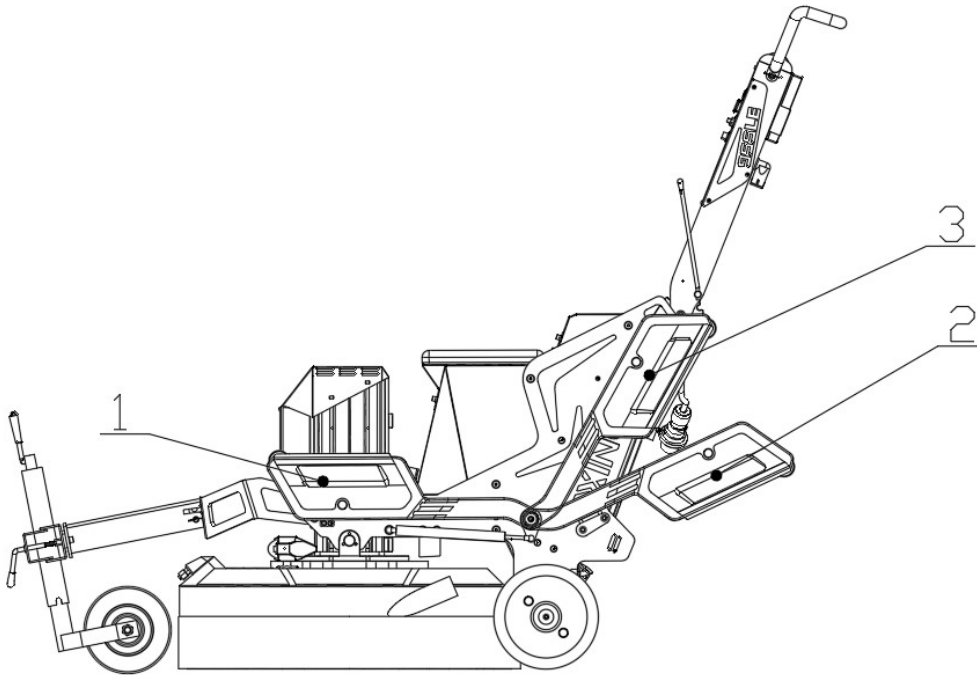

1. Working position 2. Tilting position 3. Transporting position

Notice:

When switching the position of the additional weight iron, you need to hold the additional weight iron with one hand;

When the additional weight iron is switched from the transportation position to another position, pull the handle on the fixed bolt of the additional weight iron outward. Additional weight iron can switch positions.

3.8 Battery charging

When the battery of the device is out of power, the power indicator on the electric box is lower than 20%, and the battery needs to be charged at this time. Open the cover of the charging port and use the charger provided by the manufacturer to charge.

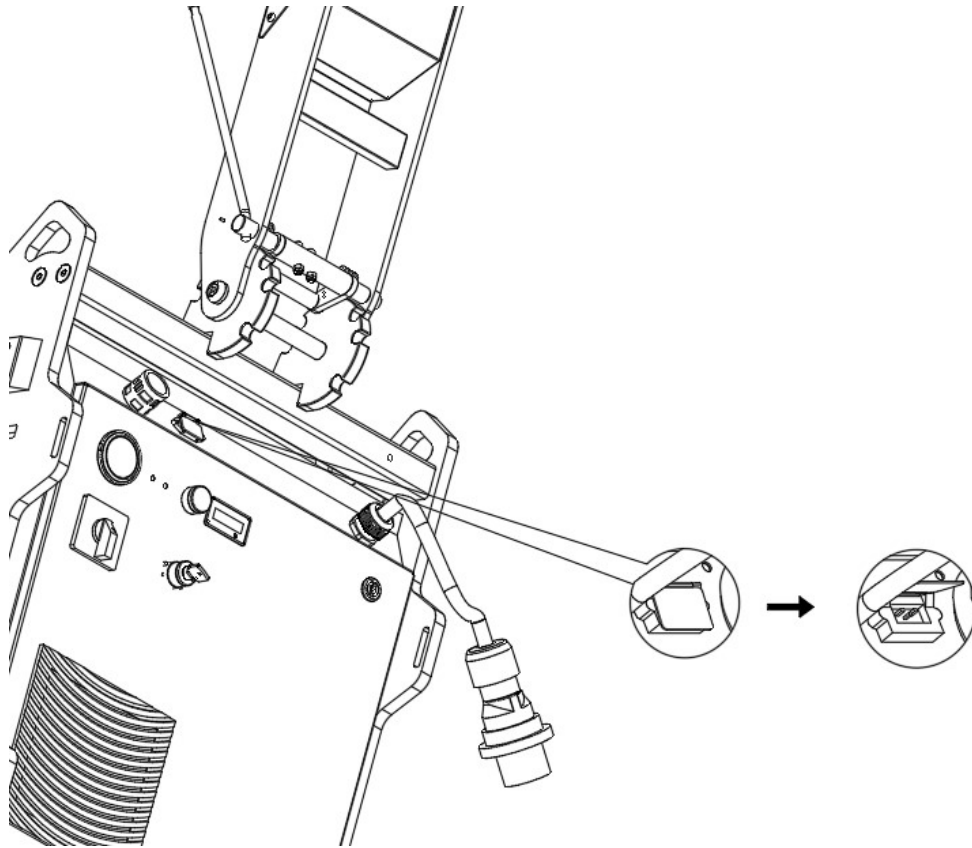

3.9 Remote control device

3.9.1 Description of controls - control panel

1. Emergency stop switch: Open or interrupt the use of radio control, let the machine stop working.
2. Brake switch: The drive wheel brakes instantly.
3. One key to turn left: Press to realize the left turn of the machine.
4. Display screen: Display some parameters, such as voltage, current, motor speed, overload fault prompt, etc.
5. External antenna: Used to receive control signals.
6. Drive wheel speed adjustment switch: Control the speed of the machine walking.
7. Motor speed adjustment switch: Control the speed of the grinding disc drive motor.
8. Motor switch: The switch that controls the drive motor of the grinding disc.
9. Front water spray switch: Control the opening and closing of the spray head in the front of the grinding disc cover.
10. Panel switch: Switch the display parameter panel, such as voltage, current, motor speed, overload fault prompt, etc.
11. S-type grinding adjustment switch: Control the swing range of the machine's S-type grinding left and right.
12. Direction control rocker: Control the machine forward, backward, left turn, right turn.
 - ① Push the direction rocker forward gently and the machine will walk at the speed set on the walking speed governor.
 - ② Push the direction rocker backwards gently. The machine will walk backwards at the speed set on the walking speed governor.
 - ③ Push to the right and the machine will walk to the right at the speed set on travel governor.
 - ④ Push to the left and the machine will go to the left at the speed set on travel governor.
 - ⑤ After the machine is turned, reset the joystick and the machine will move according to the forward or backward command set in the previous step.
 - ⑥ Walking speed of the machine: 0-20m / min.
13. Left and right wheel speed adjustment switch: Ensure that the machine performs linear grinding. When the machine is slightly offset from the straight line to the right (to the left), turning the switch to the left will reduce the speed of the left wheel and make the machine to the left (right) offset and keep the straight path.
14. Start button: Used to turn on the remote control in conjunction with the emergency stop switch.
15. Spotlight switch: The switch to control the machine's spotlight.
16. One key to turn right: press to realize the right turn of the machine.

3.9.2 One-key turning

When the machine is in the grinding operation, the machine A appears to be straight-line grinding, and when it needs to turn, You can press "one key to turn right" (or press "one key to turn left" according to your needs), then it can realize the state of machine B, while turning and grinding at the same time. Finally, linear grinding is carried out in the state of machine C.

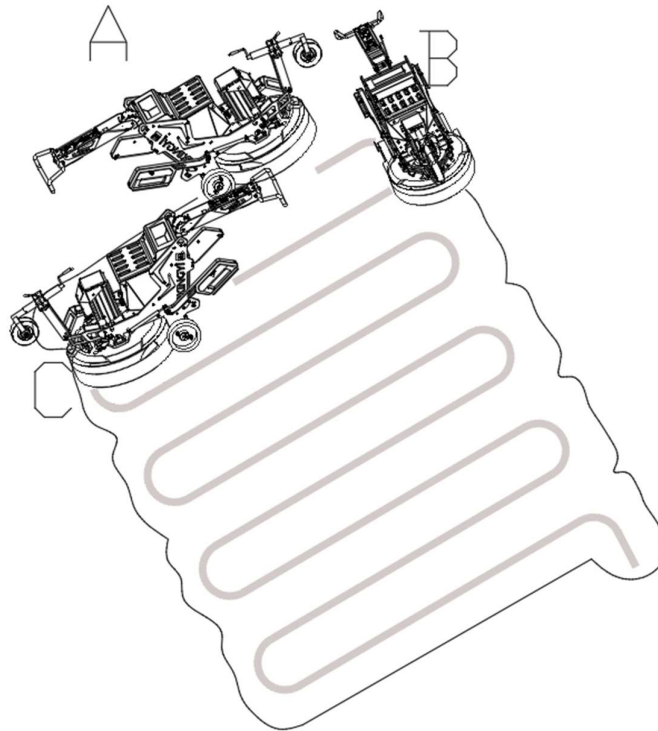

3.10 Remote control box

3.10.1 Overview

Lay the remote control device flat, open the box, hold it with your hand first, fix the lid of the box, and then go take things. Inside the remote control box:



1.Remote control

2.Belt

3.The battery

4.Charger

5. Key for remote control box

Notes:

Please pay attention to get the parts only after you place the box onto floor or table steadily.

Wear the protective gloves and insulation shoes during operation.

3.10.2 Lock the remote control box

For your property and carriage safe, we have the locking device in the remote control box. The key is in the bottom of the remote controller, please check when you receive the machine.

When locking, please insert the key into the keyhole outside the box to lock it clockwise. Rotate reversely when unlocking.

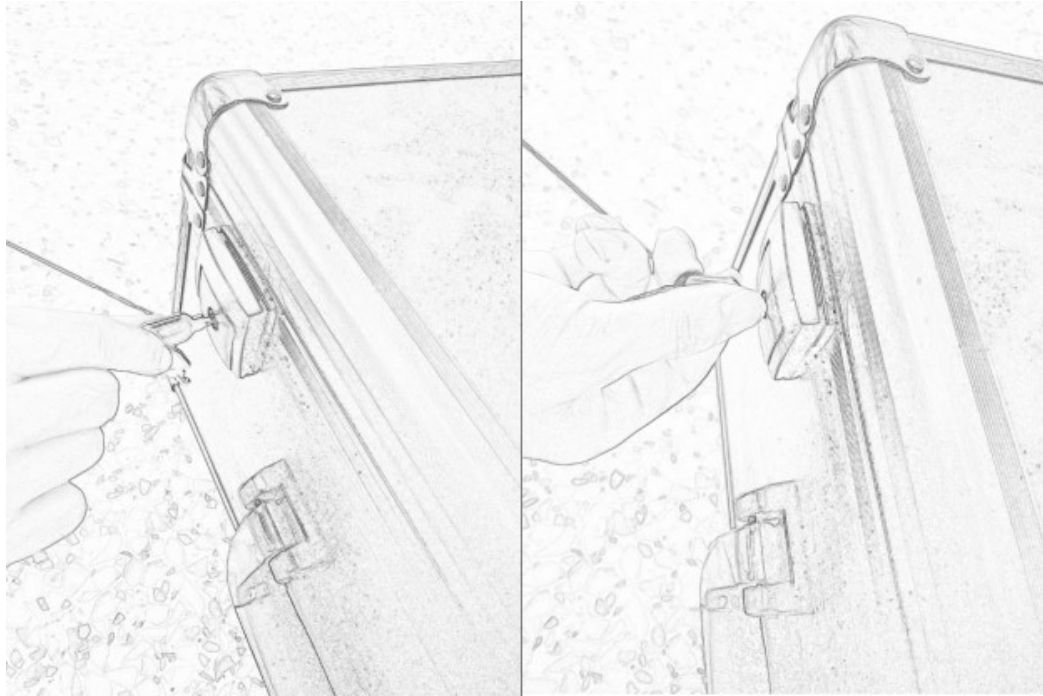

Precautions:

1. When locking, be sure to ensure that the lock is successful. At this time, press the switch to open the box. If it does not move, it means that the lock is successful. Do not use too much force when you are sure to make sure that the locking device is not damaged.
2. When locking, do not use too much force on the rotating key to avoid breaking the key.
3. pay attention to the key storage, do not lose.

3.10.3 Use of the remote control

The installation of remote control battery: Please check the Battery Percentage before installation, to avoid the Battery Percentage is not enough to cause normal use; when installation, please pay attention to the battery direction, and ensure to install battery reliable ; remove the battery without using the remote control for a long time.

Location of the remote control: The remote control should be placed in a safe and conspicuous position to prevent it from falling and being damaged.

Turn on the remote control: Put the fully-charged OHM battery pack into the battery compartment, pull out the emergency stop switch on the remote control, and press and hold the “Start” green light to be on until the green light flashes once per second, which indicates the normal boot.

Turn off of the remote control: Press the emergency stop switch of the remote control, the power indicator is off, and the remote control is turned off.

Power indicator: The green light flashes for one second to indicate that the remote control is working normally; the red light flashes once every second, accompanied by a buzzer sound, indicating that the remote controller battery voltage is insufficient; the traffic lights flash alternately, indicating that the smart key is not recognized; traffic lights If it is always on, it means that the high frequency module is not recognized.

3.10.4 Usage of the remote control charger

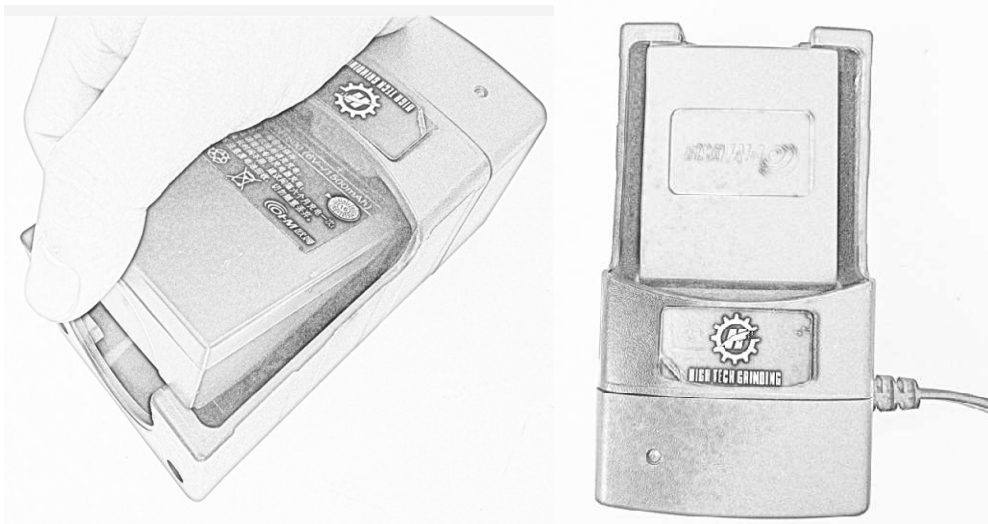

Enter the correct voltage as indicated on the charger.

Put the rechargeable battery into the charger:

The indicator light of the charger changes from steady green to steady red, indicating that the charger is normal;

The charger indicator changes from steady green to red, indicating:

When the battery is over-discharged, the charger is in the trickle charge state. After a short time, the indicator light change to red, and the battery is in the normal charging state.

The rechargeable battery is faulty and needs to be replaced.

After the charge is completed, the indicator light changes from steady red to steady green.

Note:

Be sure to confirm the charger voltage.

Make sure that the rechargeable battery is fully inserted in the charger.

If the charging is not completed after more than 4 hours. Please check it if the charger or battery is in normal working or not.

3.11 Clutch device

Locking the clutch: toggle the clutch outwards, rotate it 90 degrees counterclockwise, and then push it back inward.

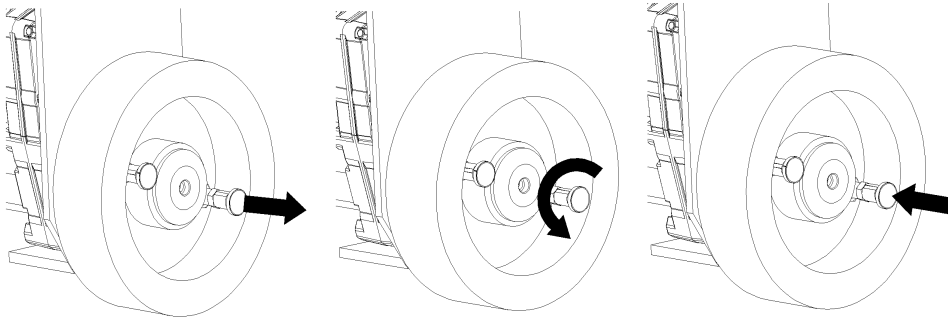

Unlock the clutch: toggle the clutch outward, and then rotate it 90 degrees counterclockwise.

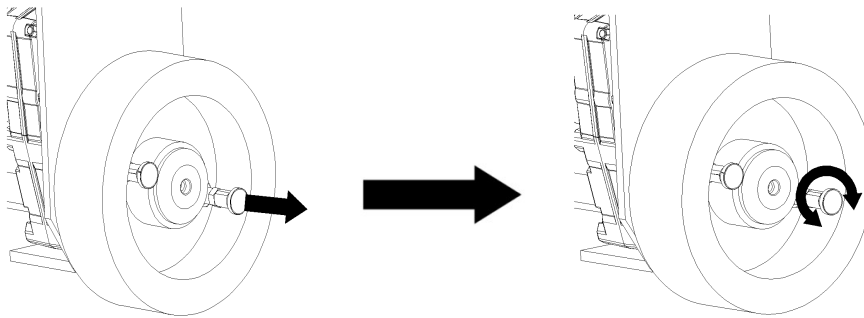

Note:

1. The clutch may be stuck sometimes when you try to pull out, shake the machine in this case.
2. Rotate the clutch to proper position when grinding. Be sure to limit the clutch pin before working. If the clutch pin does not automatically bounce back, it will bounce back automatically when the wheel is moving on ground.

4. Machine Operation (Manual mode)

4.1 Overview

The following part mainly describes the grinder in different positions when the mode is switched to manual operation, the main operation of the grinder and how to install the grinding abrasive.

Note:

1. Grinders can only be used or repaired by personnel who have received the necessary theoretical and practical training and have carefully read the user manual.
2. Wear protective equipment such as protective gloves, protective masks, overalls, helmets, insulated shoes, etc. when operating the grinder.

4.2 Machine position description

4.2.1 Machine working position

When the grinder is working, you need to pull out the spring latch on the additional weight iron and reach the motor, gently lower the additional weight iron to a suitable position and adjust the position of the handle and swing rod to achieve the most suitable working position. Turn the support wheel upside down or remove it.

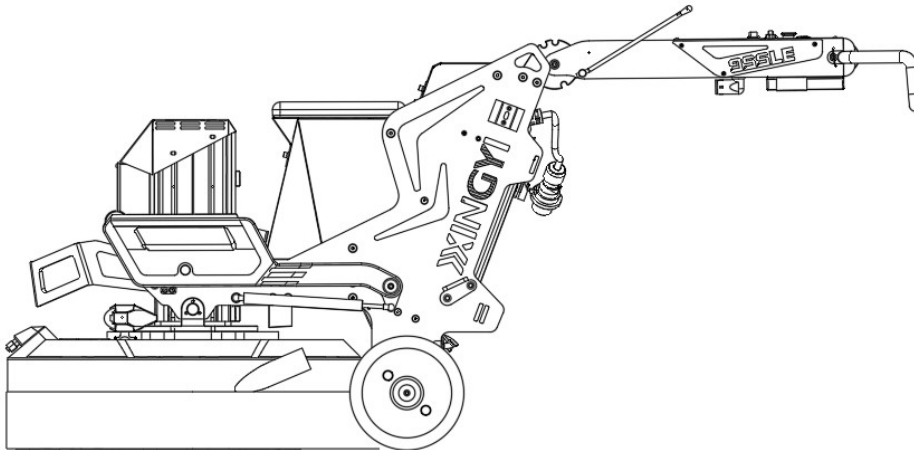

4.2.2 Machine transportation position

During the transportation of the machine, the weighted iron is adjusted to the transport position, and the swing lever and the handle are adjusted to the transport position. Pull the clutch pin out. Lower the support wheel for locking, rotate the support wheel, and adjust the height of the support wheel so that the disc is off the ground for easy transportation.

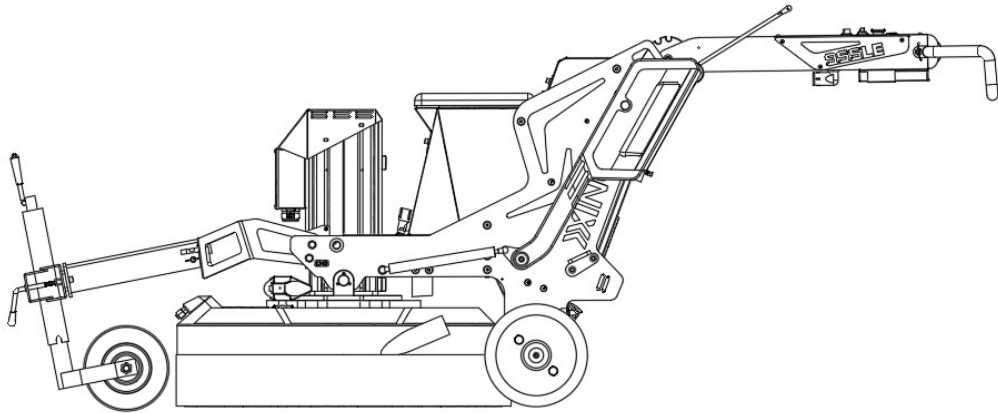

Notes:

Do not rotate the support wheel to an excessive position to prevent the support wheel from falling off, which may cause personal danger.

When rotating the support wheel, always pay attention to the height of the grinding disc from the ground, cannot be too low. When the height is too low, the grinding disc will collide with ground and damaged.

While rotating the support wheel handle for transporting machine, it is recommended to rotate the support wheel to following state: the lowest position of the disc is 25 mm above the ground.

4.2.3 Machine package position

When packaging, the position of the swing lever, the support wheel and the handle can be adjusted to reach the packaging position.

The minimum packaging size is as follows. The front guide wheel can be disassembled and can be packaged according to its size.

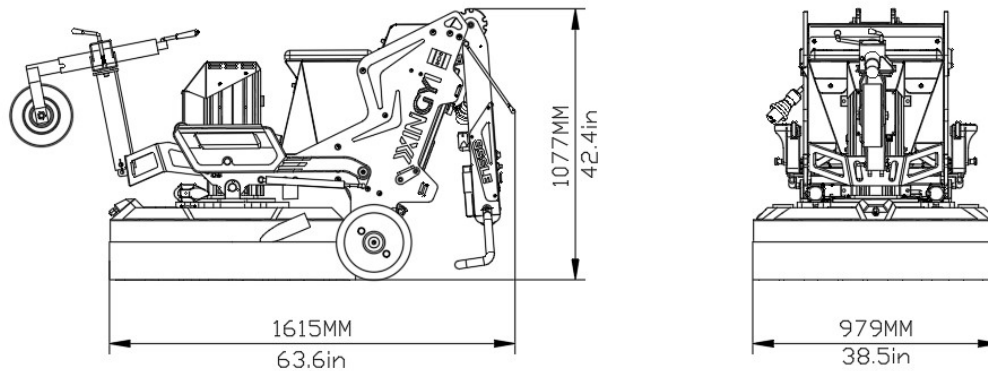

4.2.4 Machine upright position

Adjust the bolt of the additional weight iron so that the additional weight iron is in the upturned position, and adjust the position of the handle, foot pedal, and swing lever to the upturned position of the equipment. (Suggested best position to lift up)

Hold the handle with both hands and place one foot on the additional weight iron to force the machine down.

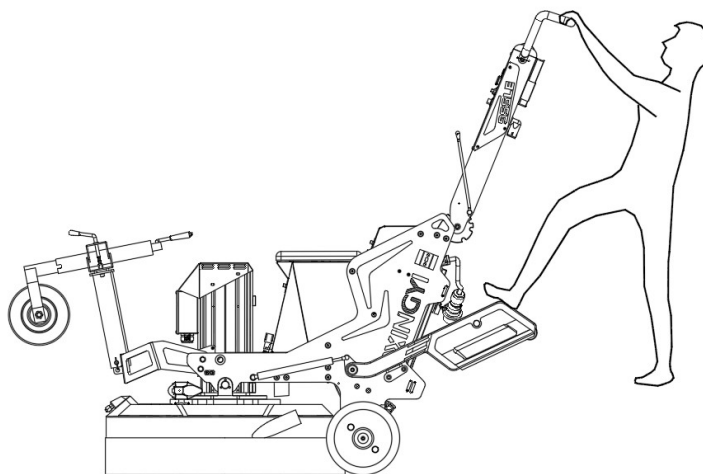

To put the machine down, you need to hold the handles tightly with both hands. Place feet on the handle of the extra weight iron lifter, balance the machine with your own gravity, and slowly lower it to protect the grinding head. When you put down the machine, pay attention to your own strength, and do your best to ensure the safety of the machine and the person. XINGYI company does not

assume any responsibility for machine damage and personal injury caused by improper operation.

Note:

After lifting up the machine, remember to stand next to the grinding head, slightly press the grinding head to see if the machine is stable for personal safety.

4.2.5 Precautions

1. Improper operation may lead to the grinding machine overturned and damaged, even endanger personal safety.
2. When the handle adjustment pin is pulled out, it may get stuck. Just shake the handle and pull out the pin.
3. During adjustment, it is necessary to confirm the reset of the locking device before operating the machine.
4. Be careful when the grinder is adjusted to the position of transportation or packaging and there is a risk of crushing injury.
5. Dust inhalation is harmful. Please bring a professional mask during operation to ensure physical safety.
6. In the process of lifting and downing the machine, we must pay special attention to our own safety and avoid damage to the machine.

4.3 Start and stop the grinder(Drive mode)

4.3.1 Start the grinder

(1) Lock the clutch, then adjust additional weight, swing rod, handle to the corresponding working position.

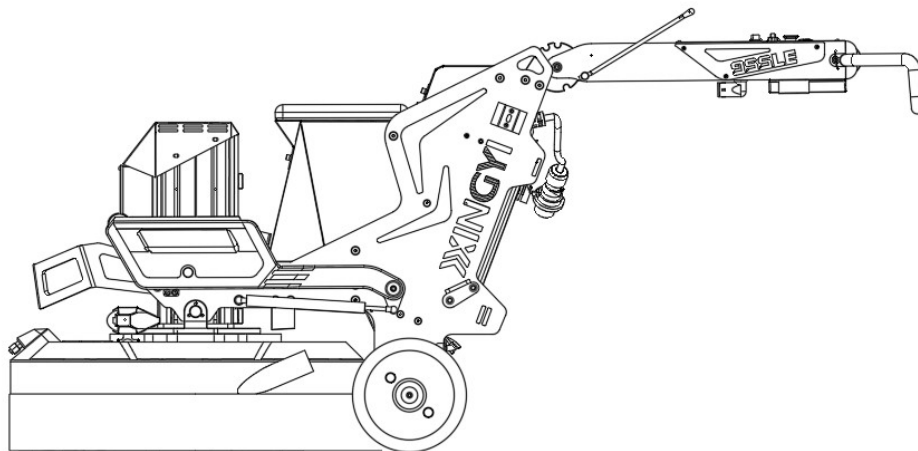
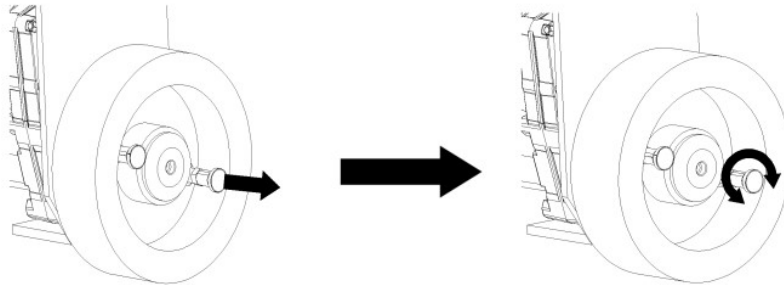

(2) Plug in the power cord (ensure that the emergency stop is pressed down and the switches are reset); if the machine using for dry grinding, connect the vacuum cleaner (The vacuum cleaner manufactured from Xingyi are equipped with fast connectors, so they can be quickly connected to the floor grinder); if the machine using for wet grinding, it's necessary to fill the water tank with water.

(3) Turn on the emergency stop switch, turn the switch to the left, the motor will rotate forward (turn it to the right, the motor will reverse), rotate the speed regulator to adjust the rotation speed of the motor, press the forward and backward switch to control the forward and backward of the machine, and rotate the drive wheel to adjust To adjust the walking speed of the driving wheel, you can start the equipment for grinding (if wet grinding work is performed, the water switch needs to be turned on).

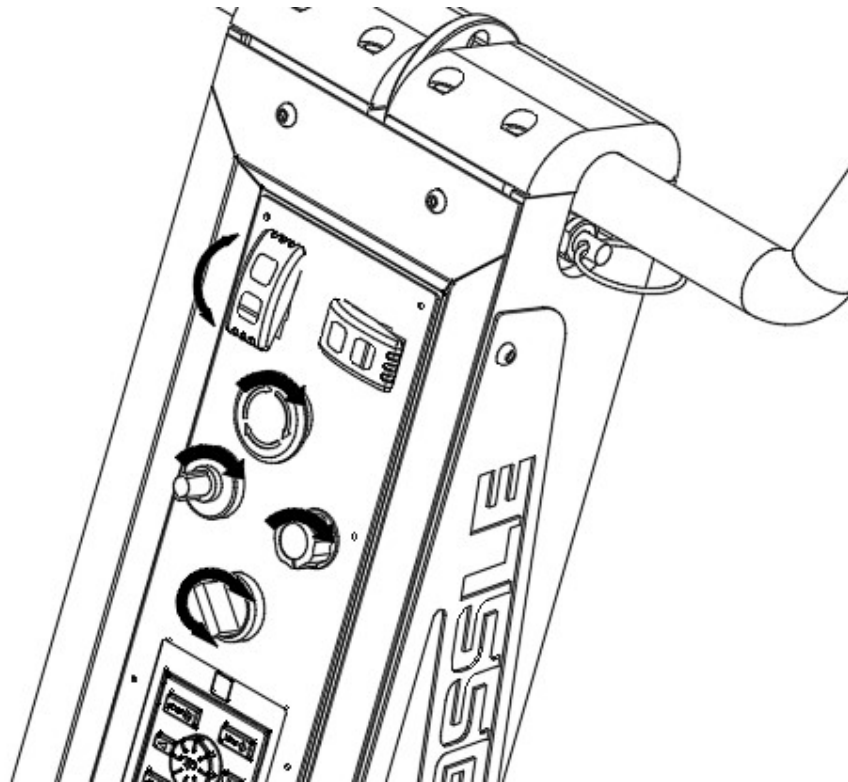

4.3.2 Stop the grinder

Press the emergency stop switch to stop the equipment (remember to reset the motor forward and reverse switch and unplug the power plug).

Notes:

When stopping the machine, it is recommended to unplug the power supply for safety reasons.

Please note that the emergency stop switch can only be pressed or rotated. Prohibit upward pull.

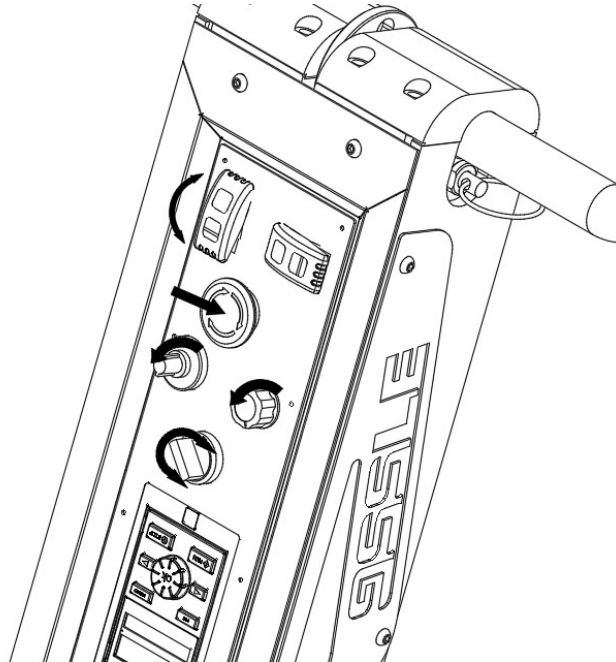

4.4 Start and stop the grinder(Manual mode)

4.4.1 Start the grinder

(1) Unlock the clutch, then adjust additional weight, swing rod, handle to the corresponding working position.

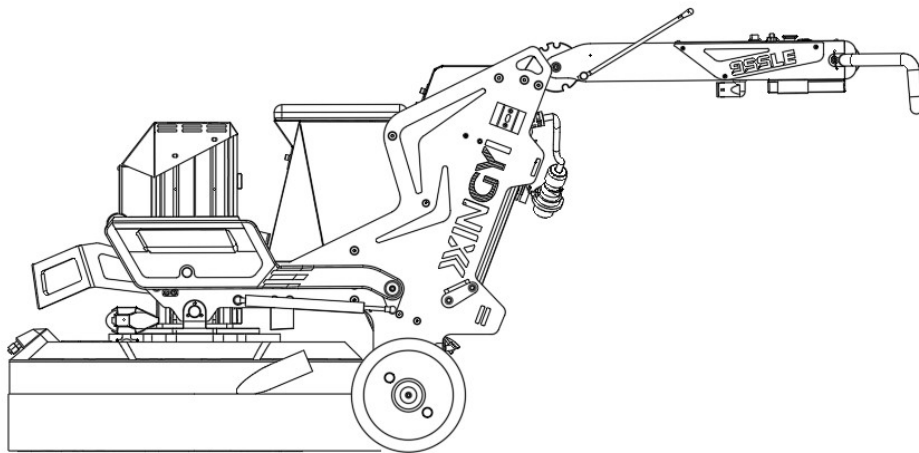
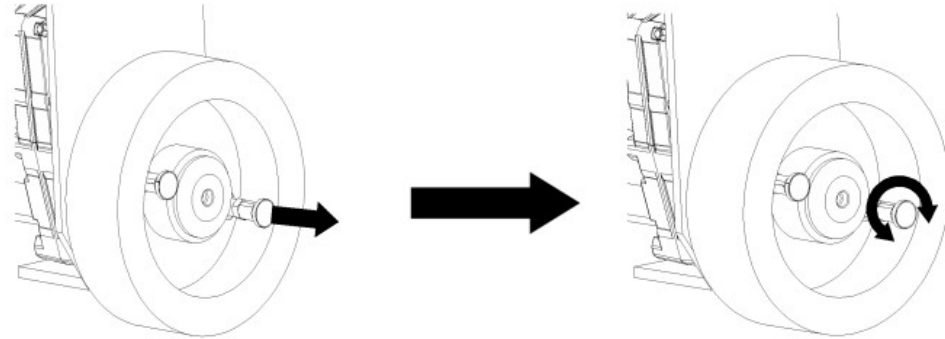

(2) Plug in the power cord (ensure that the emergency stop is pressed down and the switches are reset); if the machine using for dry grinding, connect the vacuum cleaner (The vacuum cleaner manufactured from Xingyi are equipped with fast connectors, so they can be quickly connected to the floor grinder); if the machine using for wet grinding, it's necessary to fill the water tank with water.

(3) Turn on the emergency stop switch, turn the switch to the left, the motor will rotate forward (turn it to the right, the motor will reverse), rotate the speed regulator to adjust the rotation speed of the motor, use manual control of the forward and backward of the machine, you can start the equipment for grinding (For water grinding work, you need to turn on the water switch).

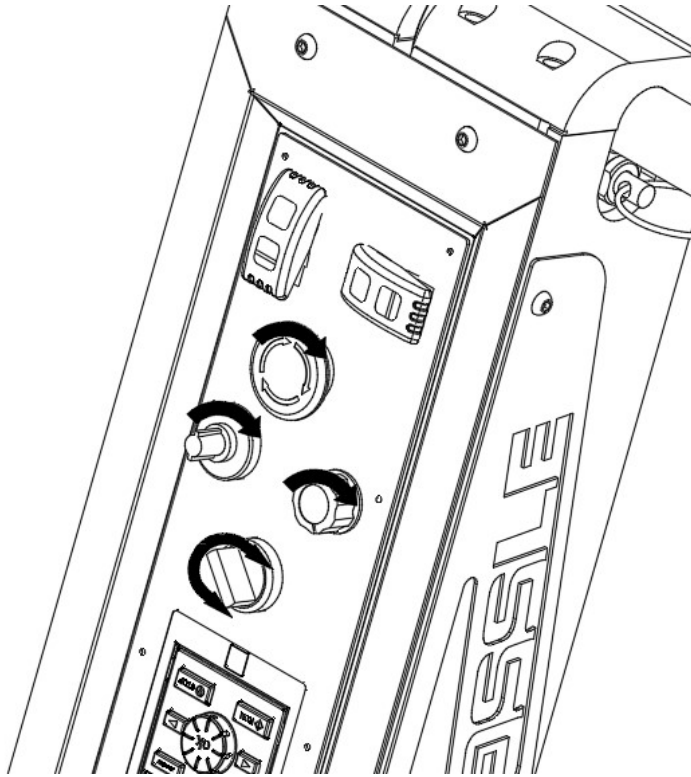

4.4.2 Stop the grinder

Press the emergency stop switch to stop the equipment (remember to reset the motor forward and reverse switch and unplug the power plug).

Notes:

When stopping the machine, it is recommended to unplug the power supply for safety reasons.

Please note that the emergency stop switch can only be pressed or rotated. Prohibit upward pull.

4.5 Replace abrasives

When changing the abrasives, adjust machine to the lifting position, then tip the machine carefully and lay the machine flat. After leveling the machine, stand next to the machine and check whether the machine is stable. Change the polishing pads with a flat-blade screwdriver and replace it with a new one.

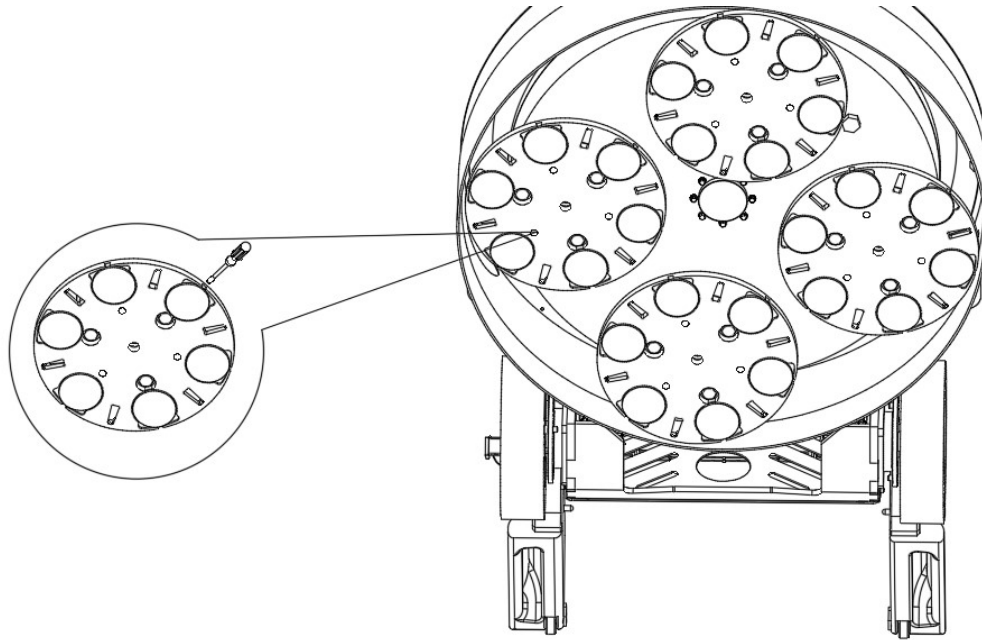

Note:

1. Please ensure that the machine won't tilt forward before replacing the abrasive.
2. After the machine has been running for a period of time, the abrasive, grinding disc and the gear box will generate high temperature. Be careful about heat injury.
3. Replace the abrasive only when the power is unplugged and the emergency stop is pressed.

4.6 The wire winding

During machine working process, the wire wind method is particularly important, you can greatly improve your work efficiency and improve your safety. The specific operation is as follows:

1. Plug in an external power supply;
2. Turn the power cord through the swing lever handle;
3. The power cord wrapped around the handle at least two laps;
4. Slightly hard to pull the power cord to ensure that the power cord has enough friction so that the power cord firmly fixed on the handle.

Note:

1. Make sure the power plug and socket are securely connected;
2. Please make sure the emergency stop has been pressed before plug the power supply, and the other switch has been reset;
3. Power supply line, please use (please find in Manual) wire minimum wire size;
4. Please use the correct power supply.

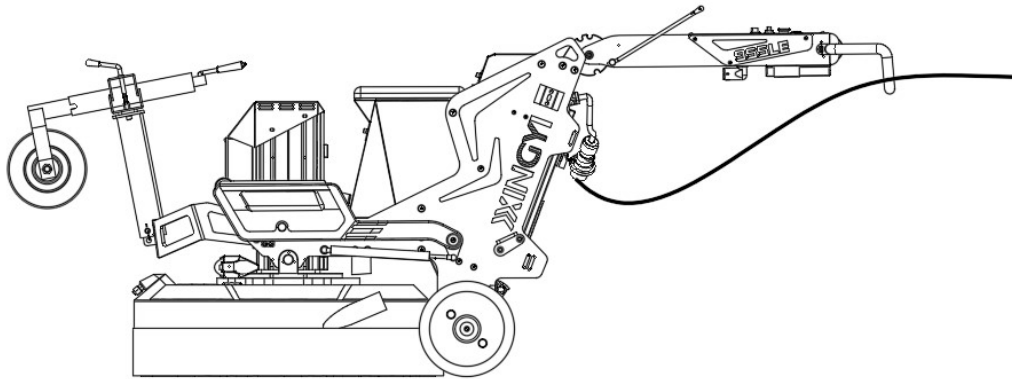

4.7 Grinding route (for reference)

When grinding the ground, it should be in accordance with the # method to grind the ground to get better effect. And according to # to grind ground, the machine grinding direction makes the wire more and more farther away, so that you can further avoid the interference of the wire to the normal work of the grinding machine.

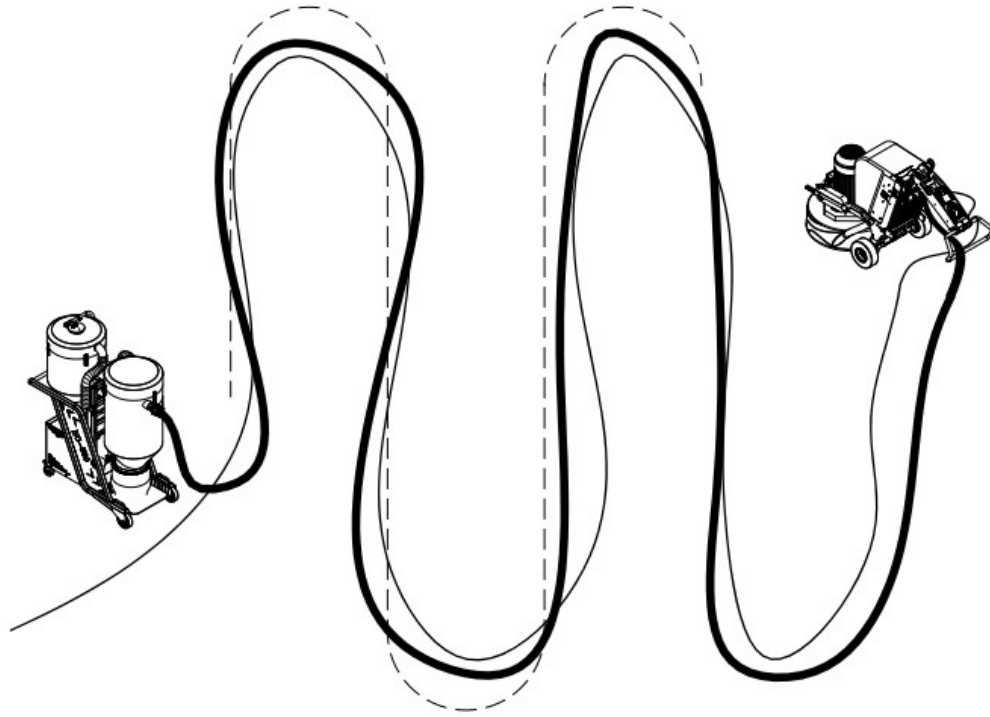

5. Machine Operation (Remote mode)

5.1 Overview

The following part mainly describes the grinder in different positions when the mode is switched to remote control operation, the main operation of the grinder and how to install the grinding abrasive.

Note:

1. The grinder can only be used or repaired by personnel who have received the necessary theoretical and practical training and have carefully read the user manual.
2. Wear protective equipment such as protective gloves, protective masks, overalls, helmets,

insulated shoes, etc. when operating the grinder.

5.2 Machine position description

The position description of the equipment in remote control mode is the same as in manual mode. The only difference is that when the equipment is grinding, you can adjust the position of the equipment by pressing the emergency stop switch and the power switch on the remote control pan.

Precautions

1. Improper operation may lead to the grinding machine overturned and damaged, even endanger personal safety.
2. When the handle adjustment pin is pulled out, it may get stuck. Just shake the handle and pull out the pin.
3. During adjustment, it is necessary to confirm the reset of the locking device before operating the machine.
4. Before adjusting the equipment to the corresponding position, be sure to press the emergency stop switch on the remote control and turn off the power switch.
5. Be careful when the grinder is adjusted to the position of transportation or packaging and there is a risk of crushing injury.
6. Dust inhalation is harmful. Please bring a professional mask during operation to ensure physical safety.
7. In the process of lifting and downing the machine, we must pay special attention to our own safety and avoid damage to the machine.

5.3 Start and stop the grinder

1. Adjust the additional weight iron, swing part and handle to the working position.
2. Disassemble and place the guiding wheel away from the job site (as shown in the figure below).

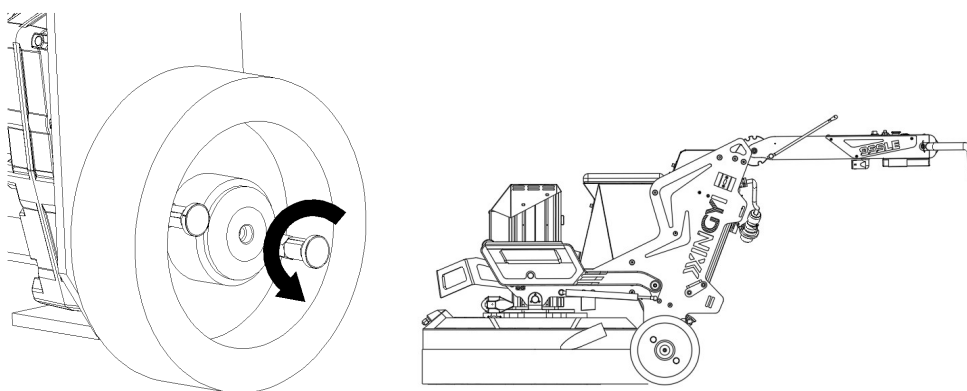

3. Plug in the power cable (ensure that the emergency stop is pressed down and the switches are reset).

4. If the machine using for dry grinding, connect the vacuum cleaner (The vacuum cleaner manufactured from Xingyi are equipped with fast connectors, so they can be quickly connected to the floor cleaner); if the machine using for wet grinding, it's necessary to fill the water tank with water.

5. Take the remote control transmitter and tie it on the waist.(As shown below after adjustment)



6. TURN ON the emergency stop switch on the swing part.

7. Turn on the emergency stop switch.

8. And turn the power switch knob to 1# power to turn on the equipment (for wet grinding, you need to press the spray switch on the remote control).

9. Use the JOYSTICK to control the direction of the device. (The specific operation is as shown in the figure below)

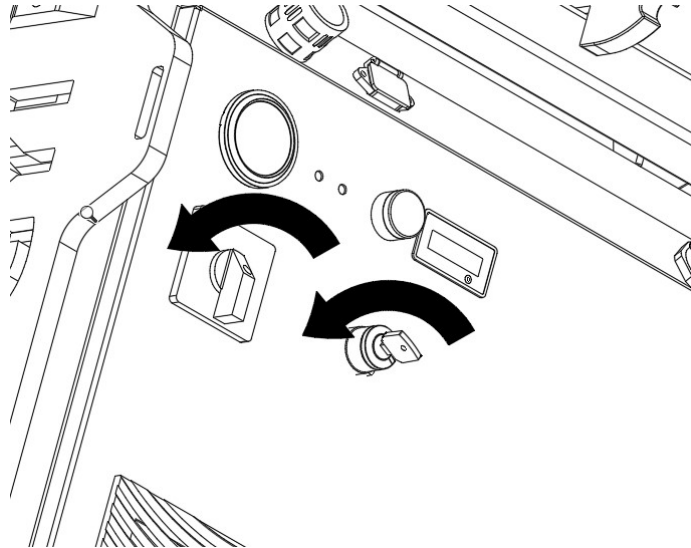

10. Press the emergency stop switch, Stop the grinder, reset all buttons (If you are doing water grinding work, please press the sprinkle switch to turn off the water sprinkle function) .

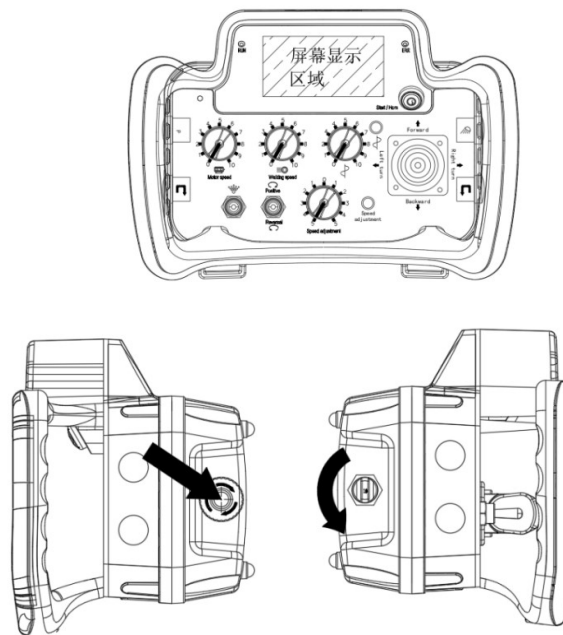

Note:

1. Before stopping the machine, please cut off all power for safety.
2. The emergency stop switch can only be rotated and pressed according to the direction of rotation above the emergency stop switch, and cannot be pulled up.
3. When turning on the machine, pay attention to reset the switches on all the remote controls to ensure the normal use of the machine. Otherwise, the machine cannot work even the power switch has been turned on.
4. When using the remote control device, please pay attention to the signal light on the remote control. The remote control can't out the normal use range of the machine. Otherwise, it will be too far to control the machine.

5. Turn on the transmitter power, observe whether the power light is flashing slowly or not. If not, adjust the transmitter.
6. The grinding disc drive motor must be started to run before pushing the direction rocker .
7. When the machine needs to stop working or an emergency occurs, press the emergency switch on the transmitter.

5.4 Replace abrasives

The steps to replace the abrasive in the remote control mode are basically the same as the manual operation.

1. Replace the abrasive only when the power is unplugged and the emergency stop is pressed.
2. Dust inhalation is harmful. Please wear a professional mask during operation to ensure physical safety.
3. In the process of lifting and downing the machine, we must pay special attention to our own safety and avoid damage to the machine.
4. Wear protective equipment such as protective gloves, protective masks, overalls, helmets, insulated shoes, etc. when operating the grinder.
5. Please ensure that the machine won't tip forward before replacing the abrasive.
6. After the machine has been running for a period of time, the abrasive, grinding disc and the gear box will generate high temperature. Be careful to be burn when you replace the abrasive.

5.5 Grinding route (for reference)

The grinding route in the remote control mode are basically the same as the manual operation.

Note:

1. When grinding, It must be noted that the equipment cannot be pressed against the wires.
5. In remote grinding, pay attention to surrounding obstacles to avoid personal injury and equipment damage.

5.6 Notes

1. During grinding, pay attention to the indicator light of remote controller, when it near to power off, the battery must be changed in time, or stop grinding to charge the remote grinding machine. Otherwise, the manufacturer will not give any compensation for any loss caused by it.

2. During the grinding process, always pay attention to the signal situation reflected by the signal indicator on the remote control.
3. When grinding, the direction control switch of the remote control only needs to be flicked.
4. Observe the wires while grinding to prevent the wires from being crushed.
5. In remote grinding, pay attention to surrounding obstacles to avoid personal injury and equipment damage.
6. Before grinding, be sure to reset the clutch pin. If it is not reset, the machine cannot walk.

6. Equipment Maintenance

6.1 Overview

We recommend that the grinding machine be checked regularly to extend the service life.

Note:

During the maintenance and repair process, the power of the grinder must be disconnected.

Wear protective equipment such as safety shoes, protective gloves, protective masks, etc.

6.2 Daily check

6.2.1 Check the switches

Release the emergency stop switch by clockwise rotate. Turn on the motor switch to start the machine(a positive and negative knob) .Normally, the running light (green indicator) will light up, if not, the error code will show on the display screen.

Turn on the grinder and press the emergency stop switch to check if the machine stops.

Turn on the emergency stop switch and turn LED light switches to check if the corresponding light is on.

Note:

For safety reasons, it is strongly recommended to press the emergency stop switch when stopping the device, which would be safer.

When starting the equipment, it is recommended to press the handle and not lift the grinding device out of the ground to reduce the pressure between the grinding saw blade and the ground.

6.2.2 Check the disc cover

When there is a large amount of dust, it is easy to cause dust nozzle of grinding disc cover clogged by dust, use flashlight to see if there is dust clogged, clean up if necessary.

6.2.3 Check the grinding plate

In the case of long hours of work or a large amount of dust, the grinding plate of grinding head may be stained with dust. It will lead lack of connection between grinding head and plate, which will affect

grinding efficiency even lead to abrasive drop and cause accident. In view of this situation, please remember to clean up in time.

6.2.4 Long-term storage of batteries

During long-term storage, the battery of the device should be maintained and charged every 6 months.

6.2.5 Note

1. Be sure to wear protective equipment for maintenance checking such as protective gloves, protective masks, insulated shoes, etc.
2. The maintenance operation must be done when the emergency stop pressed and the power unplugged.
3. Make sure the machine tilted and fully land on the floor ,then check the grinding disc.

6.3 Cleaning

6.3.1 Cleaning switch

Grinding machine works on site for a long time, and the switch will inevitably run into the dust. For this reason, you should check switch after grinding, to see whether the part is clogged by dust, resulting in switch failure.

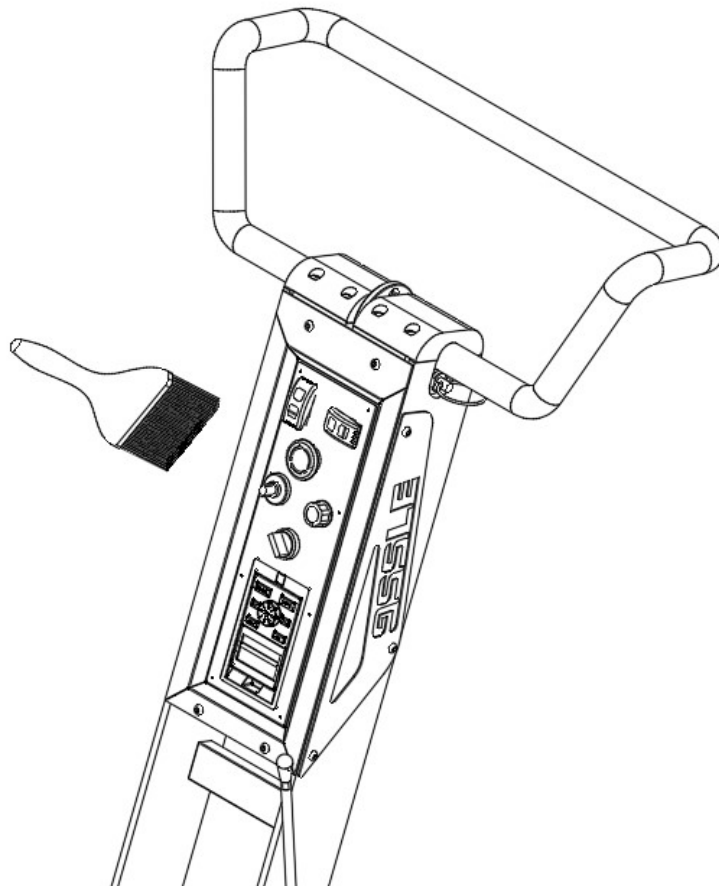

6.3.2 Clean the grinding plate cover

Remove the vacuum tube connection, illuminate the dust nozzle with a flashlight, clean the dust nozzle with brush. So that it will not clog the dust nozzle and affect dust collection efficiency.

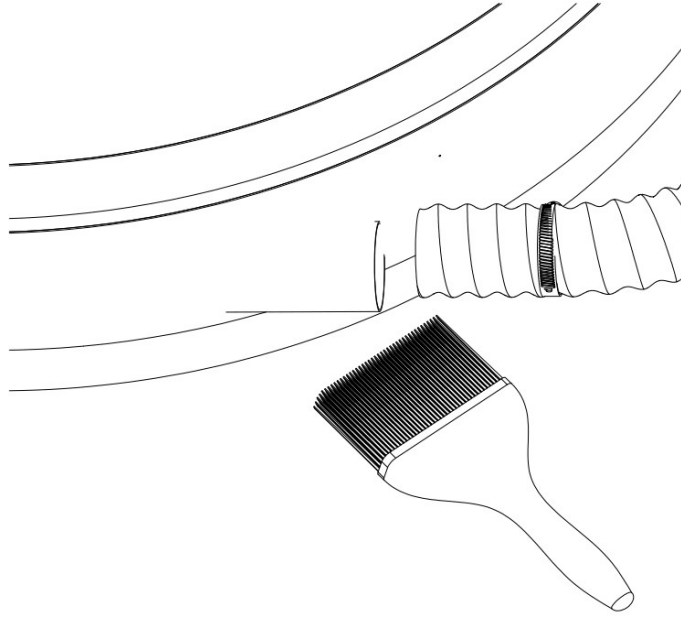

6.3.3 Clean the grinding plate and Velcro-iron accessories

Tilt the machine and use a screwdriver to remove the pads, and use shovel to remove dust. If you do not clean up in time, it is possible to make the pads disconnected, and pads fly out when grinding, causing damage to the machine and threaten personal safety.

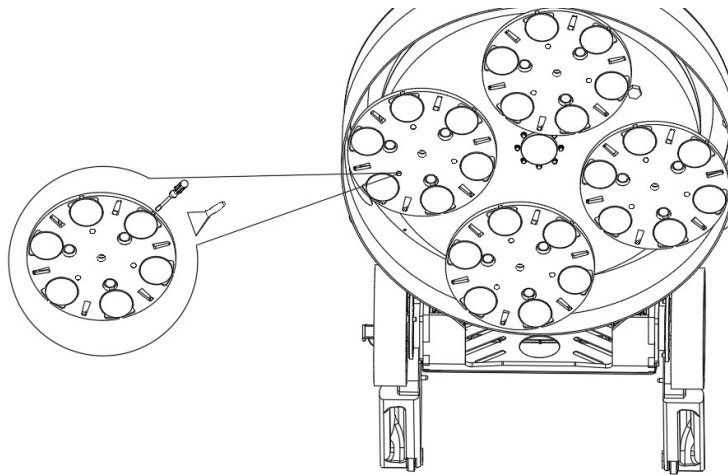

6.3.4 Notes

1. Be sure to disconnect the plug from the socket before cleaning, maintenance or assembly.
2. Be sure to clean the whole grinder after each day's working.
3. In order to cool the equipment effectively, the cooling air port must keep clean.

6.4 Overloading

The machine is equipped with an overload protection function on the inverter. When the machine is overloaded, the overload error will be showed on the display of the control panel.

6.5 Maintenance

Any repairs must be performed by Xingyi Service Center training service personnel and use original Xingyi accessories. If your machine needs repair, please contact with your retailer.

7. Frequently Asked Questions and Solutions

This chapter describes some of the possible failures and how to handle them. If you still can not resolve or have an error, please contact your nearest retailer.

Problem	Possible reason	Solution
The machine can't run.	Emergency stop switch is pressed	Turn on the emergency stop switch
	Machine Overload	Reduce the loading of machine ,e.g. take off the additional weight,turn down the rpm properly etc.
	cable not big enough or damaged	Replace with correct cable
	Wrong cable/plug connection	Correct it! make sure no Neutral line linked in but link in the earth line
	Switches damaged	Replace with good ones
The machine is difficult to hold or the motor current consumption is large	There are not enough diamonds pads under the device or using wrong diamonds	Use the number of diamonds recommended by Xingyi to reduce workforce on the grinder and operator
Machine beating	Diamond pads may not be properly installed or heights are different	Properly install diamonds with the same height
	The grinding disk is not flat	Adjust and install the disks

8. Technical Parameters

The table and picture show the technical data and dimensions of the grinder.

	955LE
Motor power	18.5KW/25HP
Rated voltage	3P 240V/480V
Rated current	43.1A
Input hertz	50HZ/60HZ
Inverter power	18.5KW/25HP
Working width	955mm/37.6in
Diameter of grinding disk	Φ370mm/Φ14.6in
Grinding speed	450~1950 rpm
Dimension(rear position)L*W*H	1913×979×1896mm/75.31×38.54×74.65in
Dimension(working position)L*W*H	2402×979×1165mm/94.57×38.54×45.87in
Dimension(packaging position)L*W*H	1615×979×1077mm/63.58×38.54×42.45in
Max.Length*width*height	2890×979×1896mm/113.78×38.54×74.65in
Total weight	750kg
Cable model	10mm ²
Storage temperature	-20~+60°C/-4~+140°F
Working temperature	-10~+40°C/+14~+104°F
Humidity	Below 95% (no condensation)

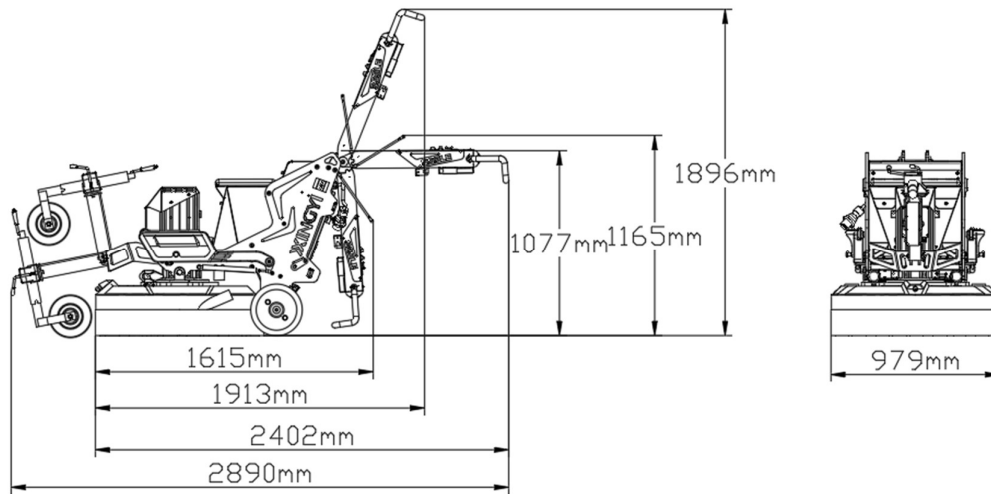

9. Warranty

Warranty regulations

Xingyi does not bear the cost of machine damage caused by improper transportation, unpacking and improper use. Local distributors may be subject to specific warranty terms, please contact with your local distributor for specific warranty terms.